



**SEGWAY**

# **SEGWAY AT5 ACCESSORIES INSTALLATION MANUAL**



# CONTENTS

SKID PLATES ( AT5 L ) .....	3
SKID PLATES ( AT5 S ) .....	5
FULL COVERAGE BUMPER ( AT5 L ) .....	7
FULL COVERAGE BUMPER ( AT5 S ) .....	8
FULL COVERAGE BUMPER ( AT5 L/AT5 S ) .....	9
WINDSHIELD .....	11

# SKID PLATES ( AT5 L )

## SKID PLATES ( AT5 L )

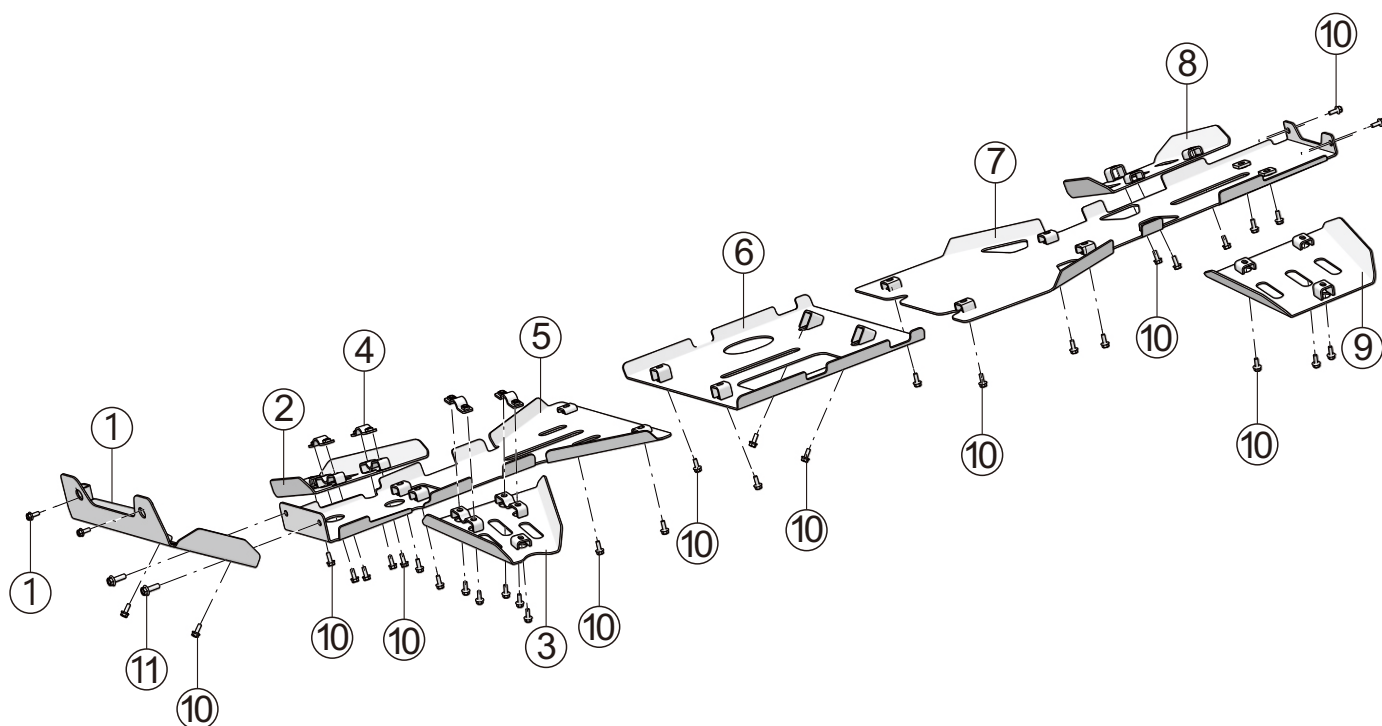

ITEM	PART NAME	PART NUMBER	QTY	REMARKS
1	FRONT GUARD	A10-R111000-FH1-00	1	
2	FRONT RIGHT ROCKER ARM GUARD	A10-R116000-FH1-00	1	
3	FRONT LEFT ROCKER ARM GUARD	A10-R115000-FH1-00	1	
4	FIXING BRACKET	A10-R119000-FH1-00	4	
5	FRONT BOTTOM GUARD	A10-R112000-FH1-00	1	
6	MID BOTTOM GUARD	A10-R113000-FH1-00	1	
7	REAR BOTTOM GUARD	A11-R114000-FH1-00	1	
8	REAR RIGHT ROCKER ARM GUARD	A10-R118000-FH1-00	1	
9	REAR LEFT ROCKER ARM GUARD	A10-R117000-FH1-00	1	
10	HEXAGON FLANGE BOLT M6×16	GBT005789007	36	
11	HEXAGON FLANGE BOLT M8×25	GBT005789016	2	

# SKID PLATES ( AT5 L )

## DISMANTLING OF THE ORIGINAL BOTTOM GUARD

Before installing a new vehicle bottom guard, remove the existing bottom guard from the vehicle.

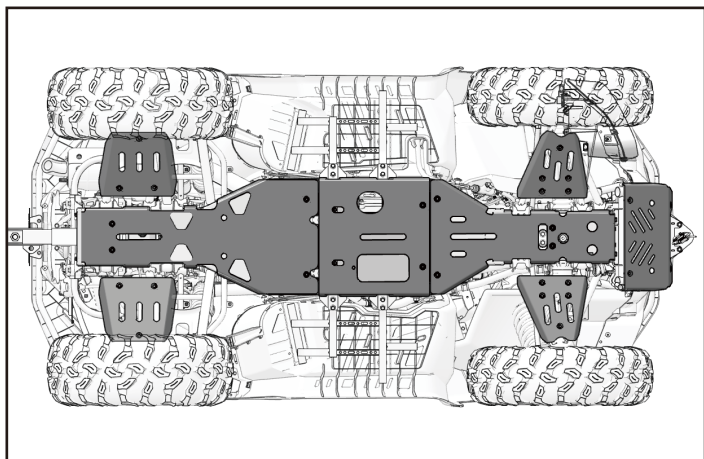

1. Remove the fasteners on the bottom guard to be replaced one by one, and then remove the bottom protective plate

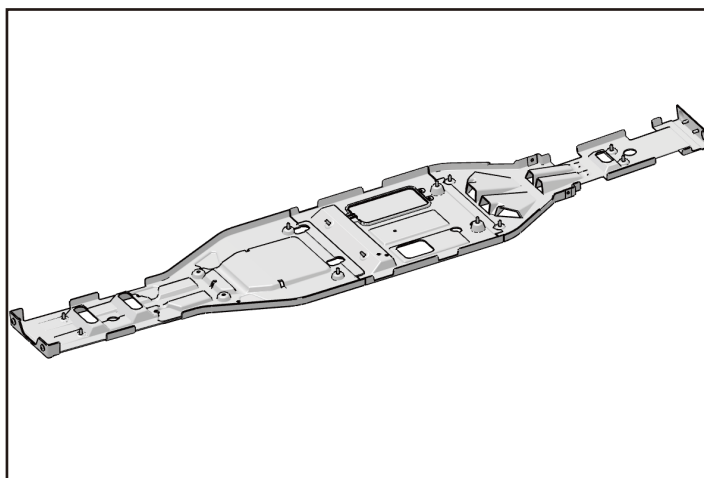

### TIPS

There is no order of demolition

## INSTALLATION OF BOTTOM GUARD PLATE

1. Fix the front bottom guard, left (right) foot pedal bottom guard, mid guard, and rear bottom guard with 28 hexagonal flange bolts M6 × 16 respectively
2. Secure the front left (right) lower rocker arm guard to the front lower rocker arm tube using 2 brackets and 4 hexagonal flange bolts M6 × 16.

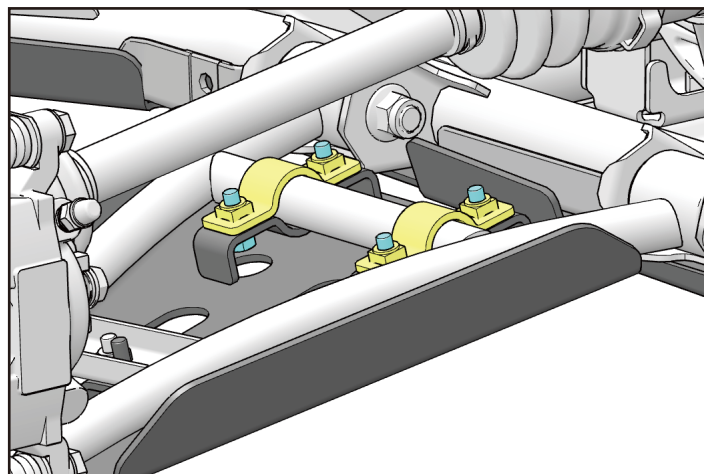

3. Fix the left (right) front rocker arm guard and the left (right) rear rocker arm guard with 12 hexagonal flange bolts M6 × 12.

Bolt M8, torque value: 30 ~ 40N·m (3.0~4.0kgf·m, 22.1~29.5ft·lb)

Bolt M6, torque value: 8~12N·m (0.8~1.2 kgf·m, 69~103.6 in·lb)

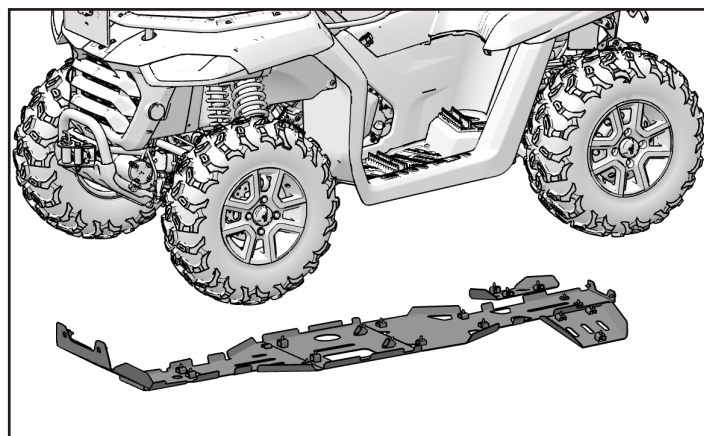

### TIPS

There is no order of installation

# SKID PLATES ( AT5 S )

## SKID PLATES ( AT5 S )

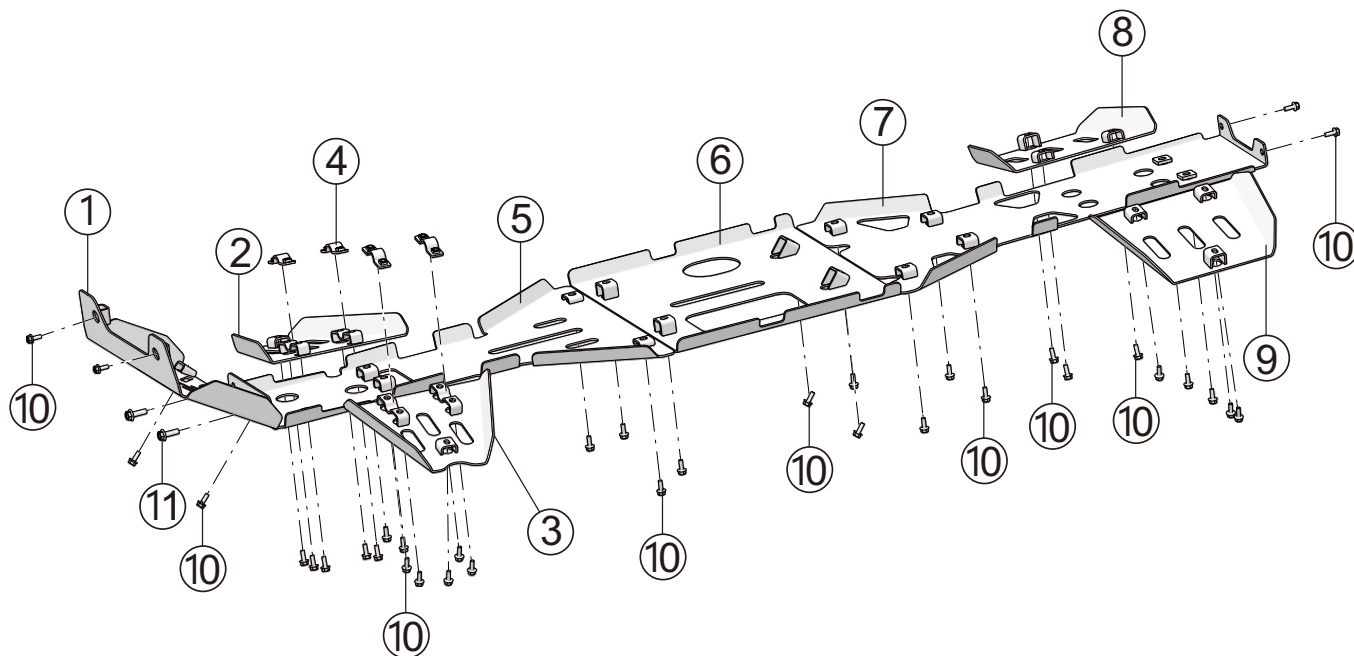

ITEM	PART NAME	PART NUMBER	QTY	REMARKS
1	FRONT GUARD	A10-R111000-FH1-00	1	
2	FRONT RIGHT ROCKER ARM GUARD	A10-R116000-FH1-00	1	
3	FRONT LEFT ROCKER ARM GUARD	A10-R115000-FH1-00	1	
4	FIXING BRACKET	A10-R119000-FH1-00	4	
5	FRONT BOTTOM GUARD	A10-R112000-FH1-00	1	
6	MID BOTTOM GUARD	A10-R113000-FH1-00	1	
7	REAR BOTTOM GUARD	A10-R114000-FH1-00	1	
8	REAR RIGHT ROCKER ARM GUARD	A10-R118000-FH1-00	1	
9	REAR LEFT ROCKER ARMGUARD	A10-R117000-FH1-00	1	
10	HEXAGON FLANGE BOLT M6×16	GBT005789007	36	
11	HEXAGON FLANGE BOLT M8×25	GBT005789016	2	

# SKID PLATES ( AT5 S )

## DISMANTLING OF THE ORIGINAL BOTTOM GUARD

Before installing a new vehicle bottom guard, remove the existing bottom guard from the vehicle.

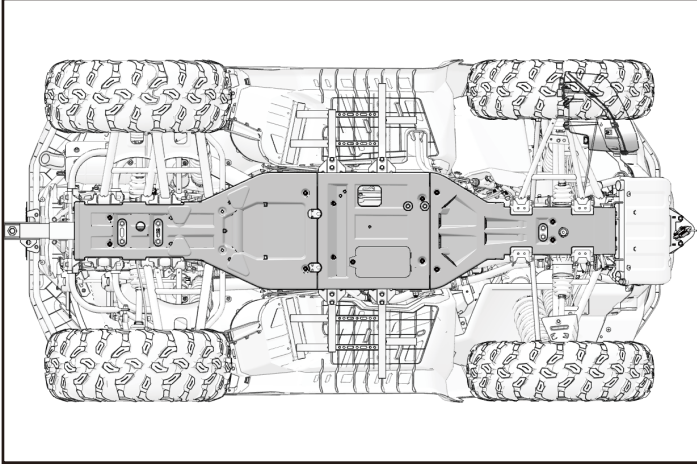

1. Remove the fasteners on the bottom guard to be replaced one by one, and then remove the bottom protective plate.

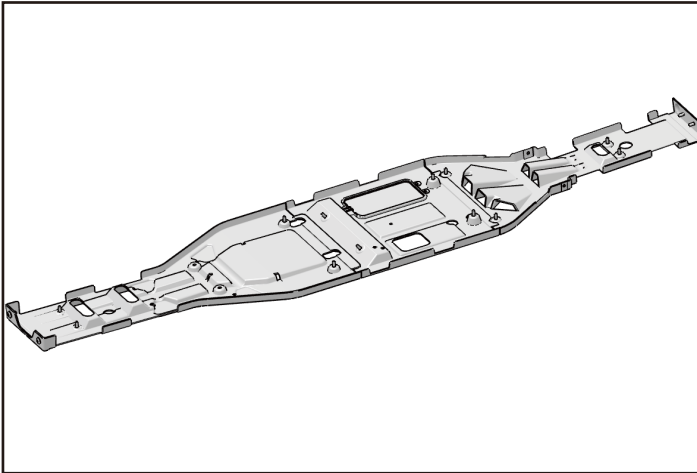

### TIPS

There is no order of demolition

## INSTALLATION OF BOTTOM GUARD PLATE

1. Fix the front bottom guard, left (right) foot pedal bottom guard, mid guard, and rear bottom guard with 28 hexagonal flange bolts M6 × 16 respectively.
2. Secure the front left (right) lower rocker arm guard to the front lower rocker arm tube using 2 brackets and 4 hexagonal flange bolts M6 × 16.

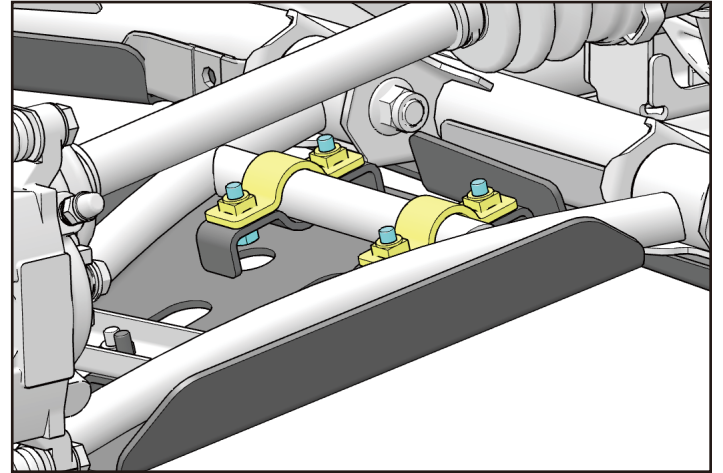

3. Fix the left (right) front rocker arm guard and the left (right) rear rocker arm guard with 12 hexagonal flange bolts M6 × 12.

Bolt M8, torque value: 30 ~ 40N·m (3.0~4.0kgf·m, 22.1~29.5ft·lb)

Bolt M6, torque value: 8~12N·m (0.8~1.2 kgf·m, 69~103.6 in·lb)

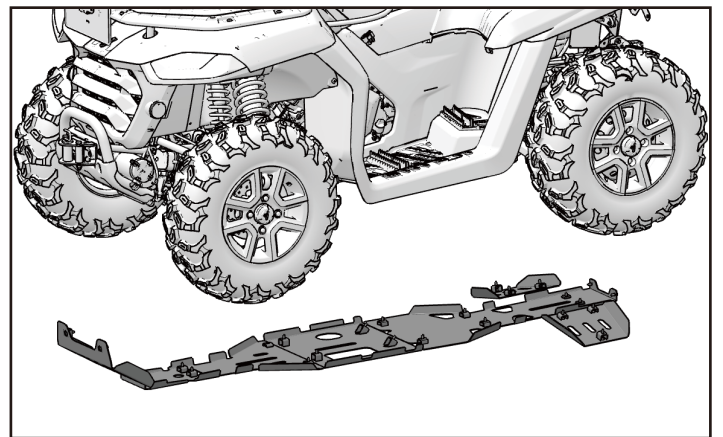

### TIPS

There is no order of installation

# FULL COVERAGE BUMPER ( AT5 L )

## FULL COVERAGE BUMPER ( AT5 L )

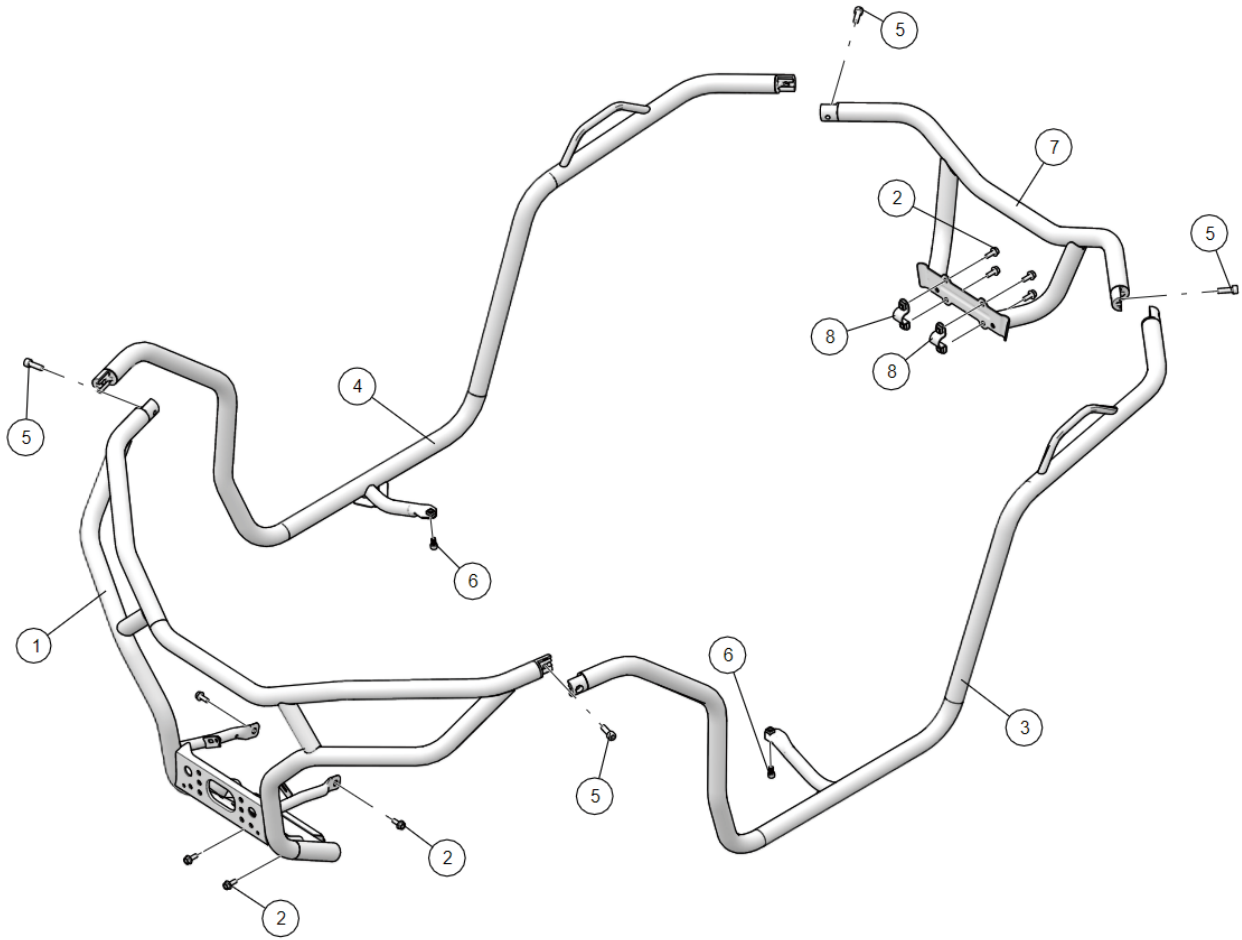

ITEM	PART NAME	PART NUMBER	QTY	REMARKS
1	FRONT BUMPER WELD ASSY	A10-R002100-0MP-00	1	
2	BOLT M8×20	GBT005789015	8	
3	LEFT GUARD BAR, LONG	A11-R003200-000-00	1	
4	RIGHT GUARD BAR, LONG	A11-R003100-000-00	1	
5	SCREW M10×1.25×30	GBT000701004	4	
6	SCREW M8×16	GBT000701014	2	
7	REAR BUMPER WELD ASSY	A10-R002200-0MP-00	1	
8	REAR MOUNTING SEAT	A10-R002500-0MP-00	2	

# FULL COVERAGE BUMPER ( AT5 S )

## FULL COVERAGE BUMPER ( AT5 S )

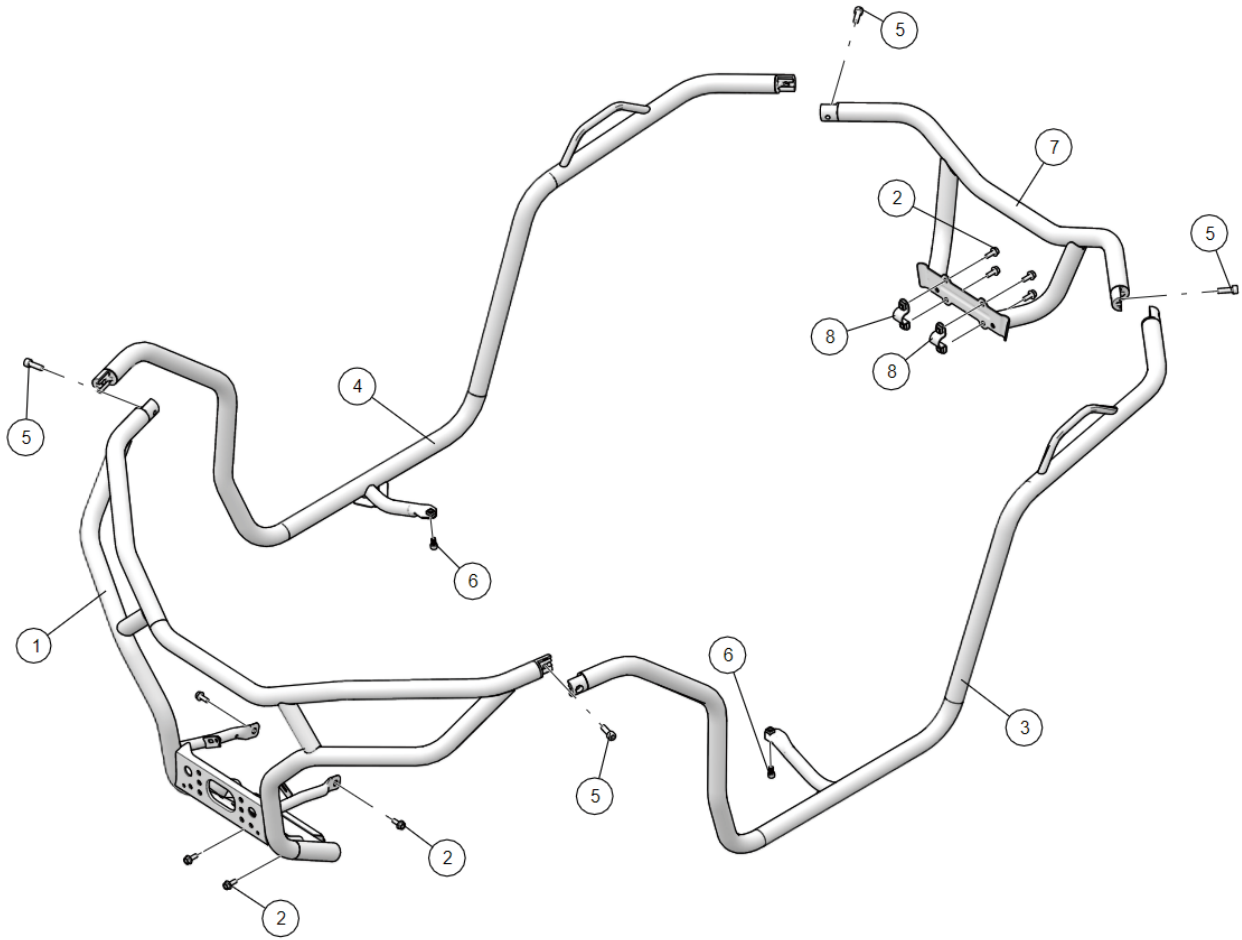

ITEM	PART NAME	PART NUMBER	QTY	REMARKS
1	FRONT BUMPER WELD ASSY	A10-R002100-0MP-00	1	
2	BOLT M8×20	GBT005789015	8	
3	LEFT GUARD BAR	A10-R002300-000-00	1	
4	RIGHT GUARD BAR	A10-R002400-000-00	1	
5	SCREW M10×1.25×30	GBT000701004	4	
6	SCREW M8×16	GBT000701014	2	
7	REAR BUMPER WELD ASSY	A10-R002200-0MP-00	1	
8	REAR MOUNTING SEAT	A10-R002500-0MP-00	2	

# FULL COVERAGE BUMPER ( AT5 L/AT5 S )

## FRONT BUMPER REMOVAL

1、 If the vehicle is equipped with a winch , first disconnect the positive and negative cables from the winch motor. If there is no winch, this step can be ignored

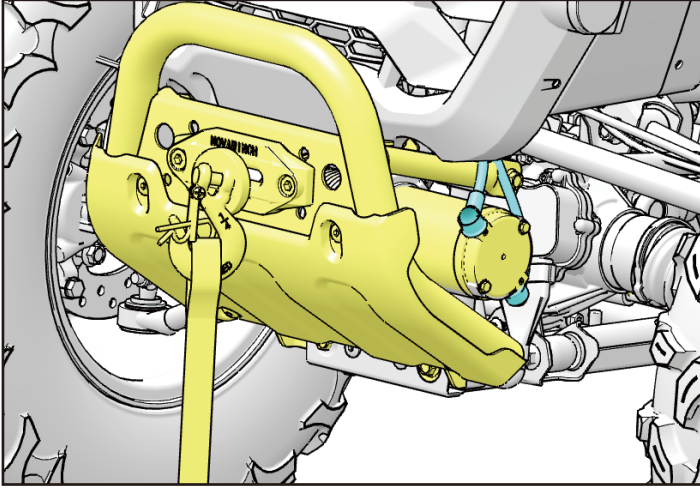

2、 Unscrew the 4 large pan head hexagon socket bolts M6 × 16 that secure the front bumper assembly to the plastic parts

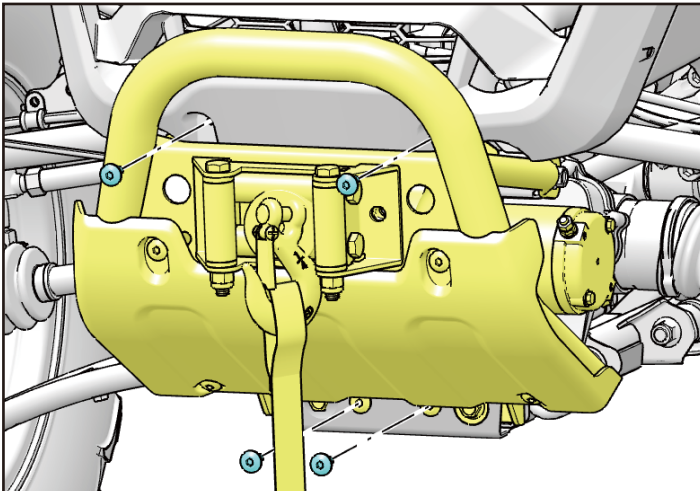

3、 Unscrew the 4 hexagonal flange bolts M8 × 20 that secure the front bumper assembly, and remove the front bumper assembly.

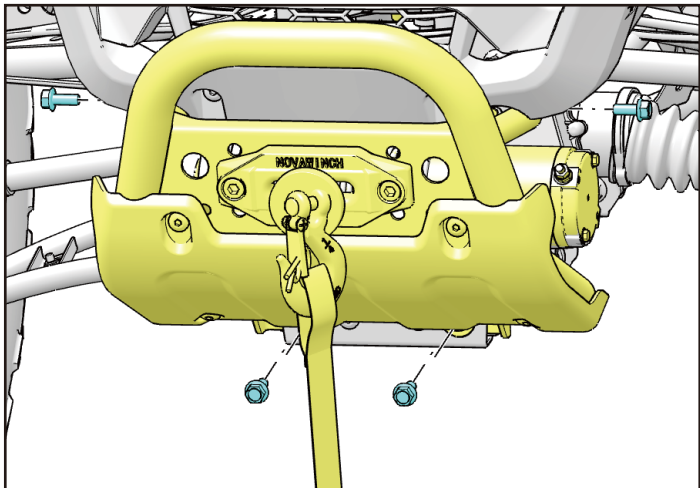

4、 Remove all other components from the removed bumper welding assembly, including but not limited to bumper guard, winch components, winch motor, etc.

### TIPS

Different car models may have different configurations, always follow the original configurations and record the dismantling steps.

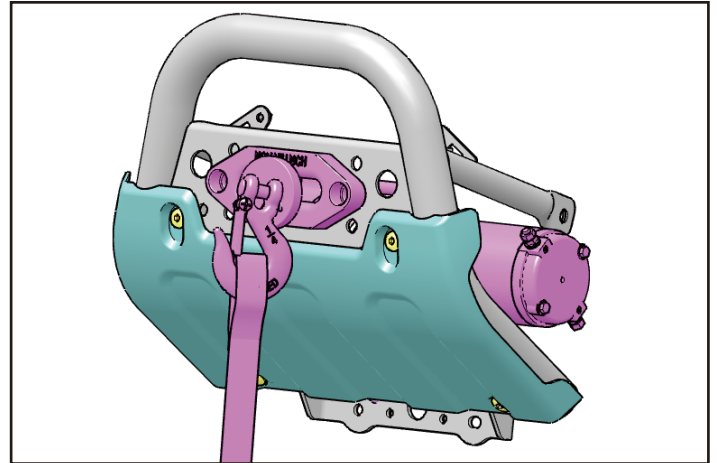

## FRONT BUMPER INSTALLATION

1、 Reinstall the winch ASSY, winch motor, bumper guard, etc. removed from the old bumper onto the new front bumper according to the disassembly steps.

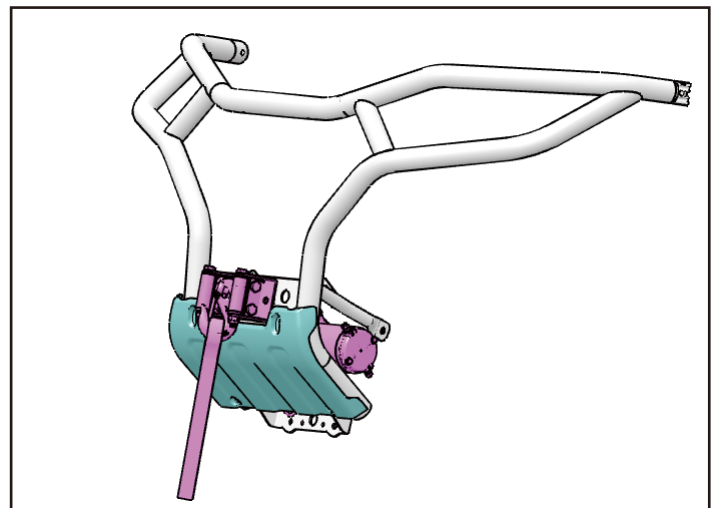

# FULL COVERAGE BUMPER ( AT5 L/AT5 S )

## TIPS

All bolts should only be pre tightened. After the components are installed in place and adjusted, all bolts should be tightened to the specified torque.

2、 Place the new bumper in the right position.

3、 Fix the bumper in the corresponding mounting holes of the frame with 4 hexagonal flange bolts M8 × 20 (discard the 4 bolts removed from the old bumper and use new bolts), with a torque value of 30-40 N · m (3.0~4.0 kgf · m, 22.1~29.5 ft · lb)

Fix the bumper in the corresponding mounting holes of the plastic part using 4 large pan head hexagonal bolts M6 × 16 (removed from the old bumper).

① Hexagonal flange bolt M8 × 20 (4 pieces)

② Large pan head hexagonal bolt M6 × 16 (4 pieces)

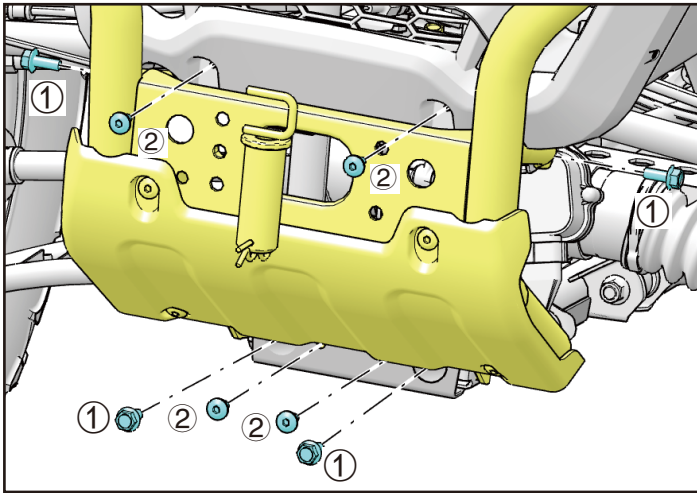

4、 Fix the rear mounting plate assembly and rear bumper of the full coverage bumper onto the tube at the rear of the frame using 4 hexagonal flange bolts M8 × 20, with a torque value of 30-40 N · m (3.0~4.0 kgf · m, 22.1~29.5 ft · lb)

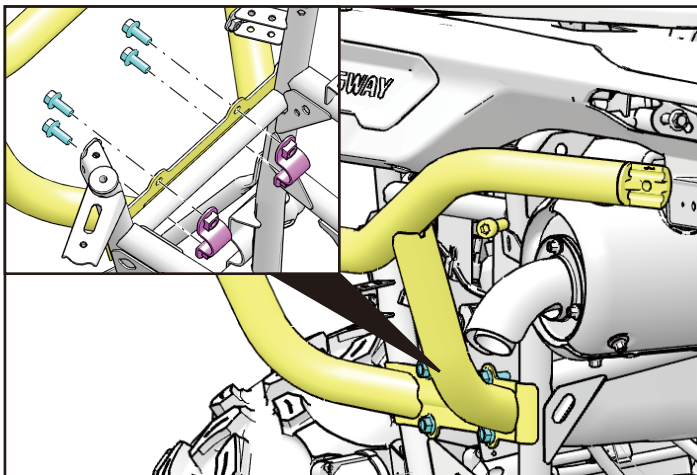

5、 Insert the branch pipe into the gap between the foot pedal bracket and the foot pedal, aligning the hole on the branch pipe with the strip-shaped hole of the foot pedal bracket. Pre tighten it with 1 hexagon socket head screw M8 × 20, and install it left and right in the same way.

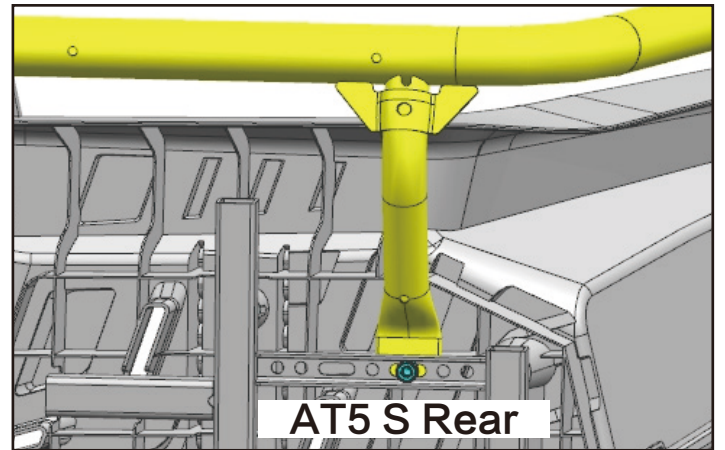
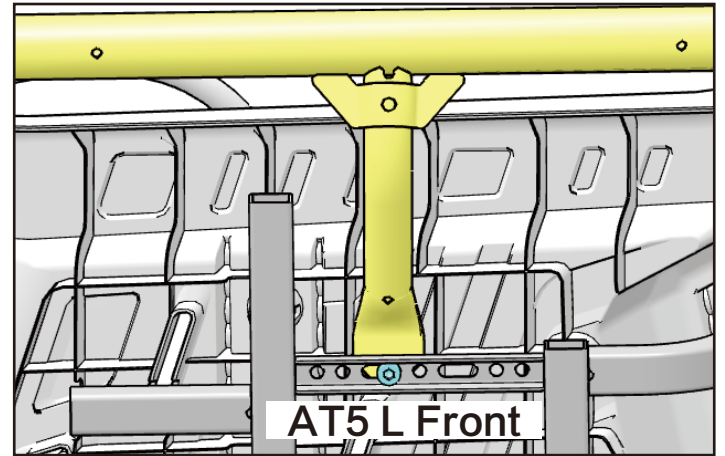

6、 Align the holes on the side bumper and front and rear bumpers, and connect them with 2 pieces of M10 × 1.25 × 30 hexagon socket head screws. The installation method for the left and right bumpers is the same. Torque value: 60-70N · m (3.0-4.0kgf · m, 22.1-29.5ft · lb).

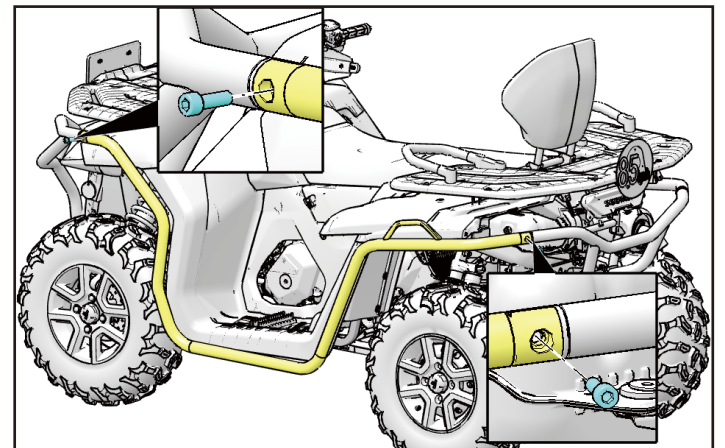

7、 Adjust the position and clearance of the coverage bumper, and tighten all bolts to the specified torque after the adjustment is completed.

8、 Reconnect the wire harness pulled out of the winch, paying attention to the polarity when connecting.

# WINDSHIELD

## WINDSHIELD

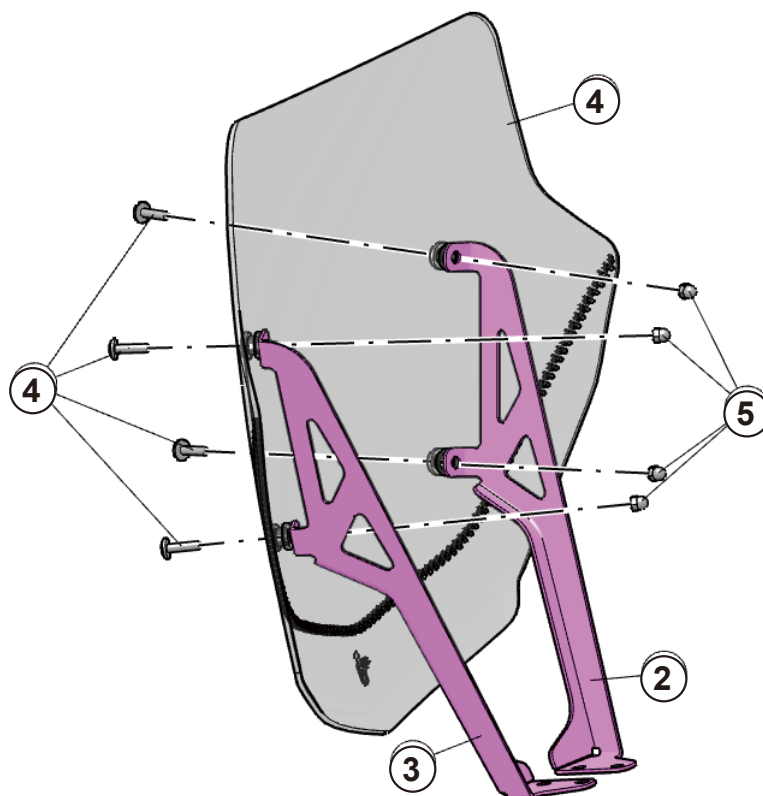

ITEM	PART NAME	PART NUMBER	QTY	REMARKS
1	ATV PC WINDSHIELD	A12-R103300-000-00	1	
2	RIGHT BRACKET	A10-R103200-FB0-00	1	
3	LEFT BRACKET	A10-R103100-FB0-00	1	
4	BOLT M6×25	T03000007007	4	
5	NUT M6	BG009230-06012-Z61	4	

### TIPS

This installation guide is applicable to multiple vehicle models, and the illustrations may vary slightly. Please refer to the actual vehicle for accuracy.

# WINDSHIELD

1、 Remove the steering handle cover (if equipped), which is a quick release component. After installing the windshield, the steering handle cover does not need to be installed.

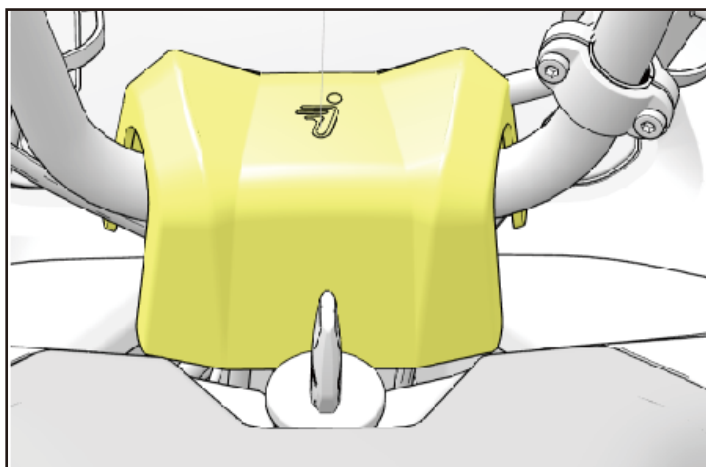

2、 Remove the 4 bolts and then remove the upper aluminum cover.

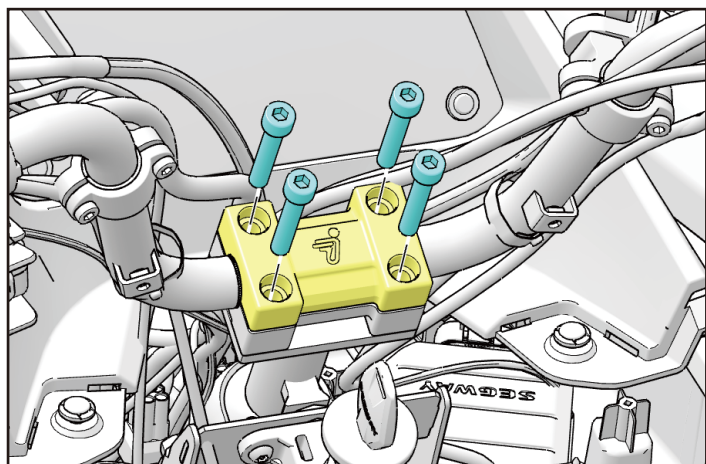

3、 Move the handle bar and the lower aluminum cover upwards, leaving a gap at the bottom, and place the left (right) bracket of the front windshield under the lower aluminum cover of the direction lever.

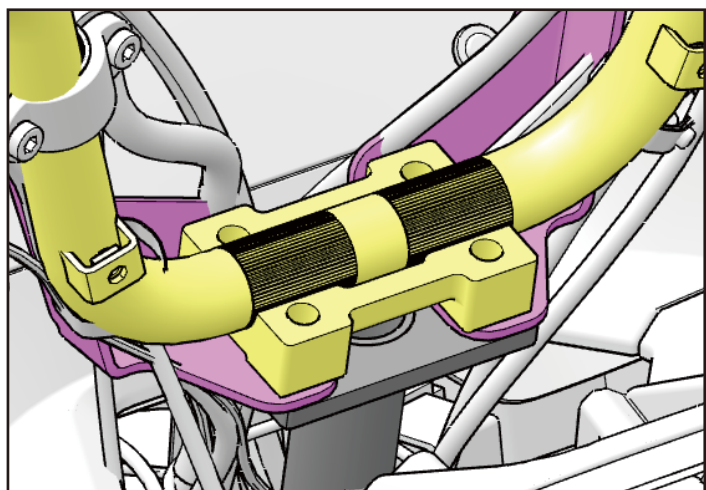

4. Adjust the direction to the appropriate position and re fix the direction handle with 4 directional bolts. Torque:  $35 \pm 3$  N · m

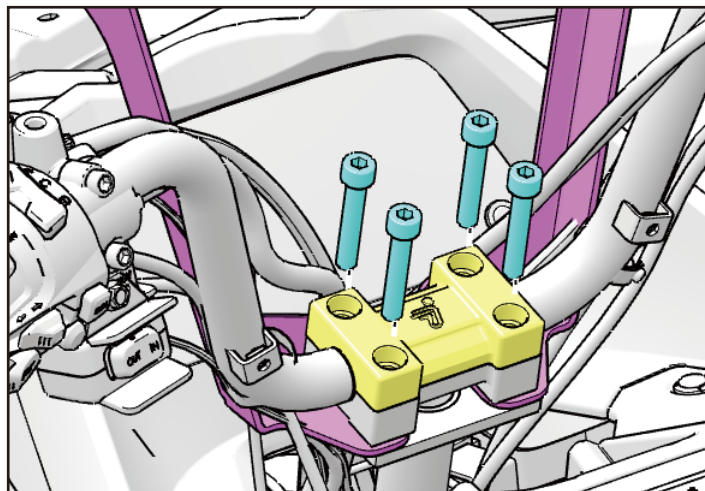

5、 Install the windshield onto the bracket using 4 large pan head hexagonal bolts M6x25 and 4 cover nuts M6. Torque:  $10 \pm 3$  N · m

