



SEGWAY

SEGWAY AT10/AT10 W ACCESSORIES INSTALLATION MANUAL



CONTENTS

HANDLE HEATER.....	3
FRONT BIG BUMPER.....	6
SNOW PLOUGH.....	8
SKID PLATE (AT10)	10
SKID PLATE (AT10 W)	12
TRACK WIDENER (AT10 W)	14
REAR CARGO BOX.....	16
FRONT WINDSHIELD (AT10/AT6).....	18
HEATING CUSHION	20

HANDLE HEATER

HANDLE HEATER

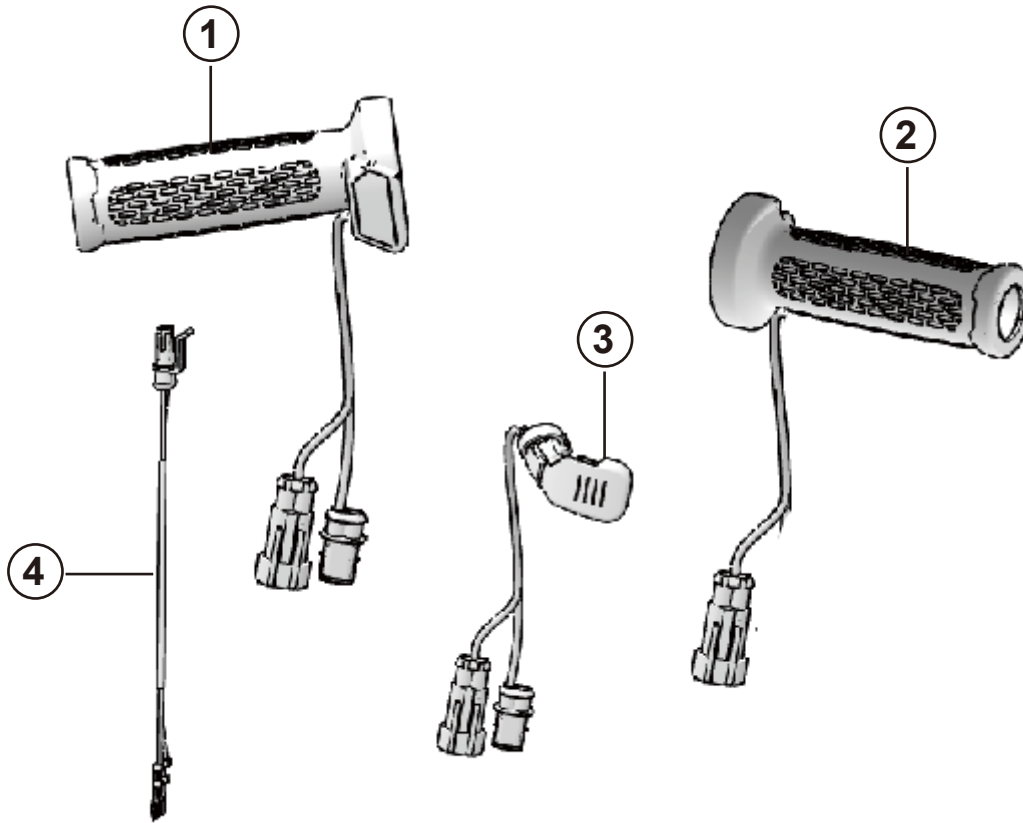

ITEM	PART NAME	PART NUMBER	QTY	REMARKS
1	LEFTHEATED GRIP	A01-R091001-000-00	1	AT10/AT6/AT5
2	RIGHT HEATED GRIP	A01-R091002-000-00	1	AT10/AT6/AT5
3	FINGER HEATER	A01-R091003-000-00	1	AT10/AT6/AT5
4	FINGER HEATER POWER CORD	A01-R091004-000-00	1	AT10/AT6/AT5

⚠ CAUTION

These installation instructions apply to multiple ATV models. Illustrations may vary slightly; please refer to the actual vehicle .

HANDLE HEATER

HANDLE HEATER INSTALLATION

1. Remove the original handlebar covers from the vehicle, then pull the handlebar grips out of the

handlebar tubes. Pulling out the grips may require considerable force.

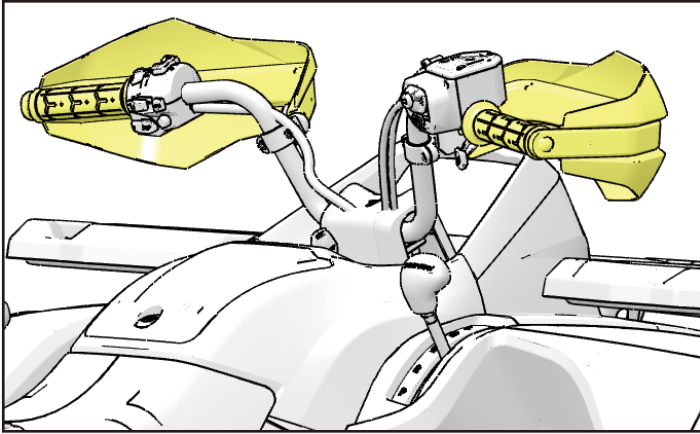

2. Loosen the bolts on the heated grip sleeve. Insert the heated grip sleeve into the handlebar tube. Due to the tight fit, installation requires considerable force. Once the heated grip is fully seated, retighten the loosened bolts. (Ensure correct left/right orientation)



3. Place the thumb warmer over the fueling handle and secure it with a cable tie

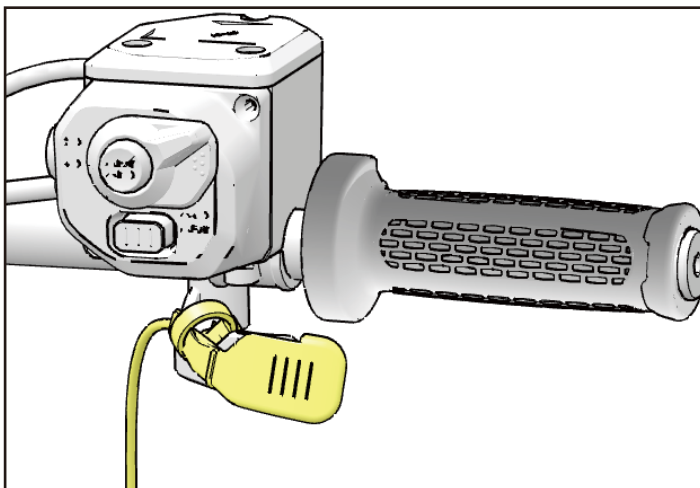

TIPS

Confirm whether your model's main cable is equipped with a heated handle power connector.

4. MAIN HARNESS:

4.1 Connect the left heated grip, right heated grip, thumb heater, and heated grip power cord as shown in the figure below

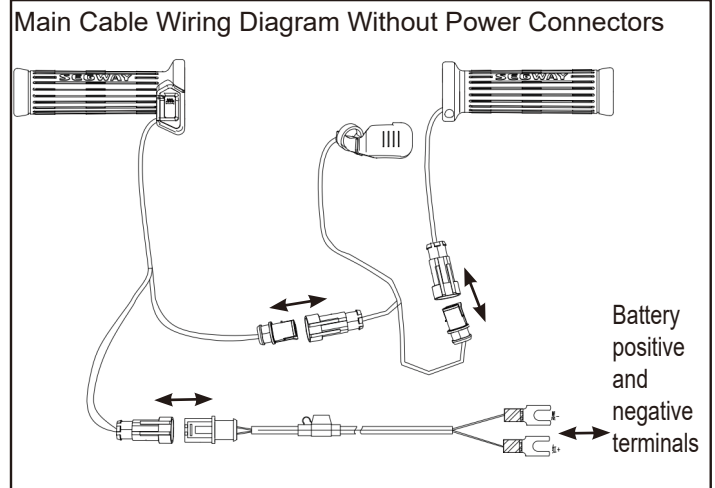

4.2 Locate the battery. Loosen the bolts on the positive and negative terminal cables of the battery. Connect the other end of the heated grip power cord to the positive and negative terminals of the battery respectively (positive to positive, negative to negative)

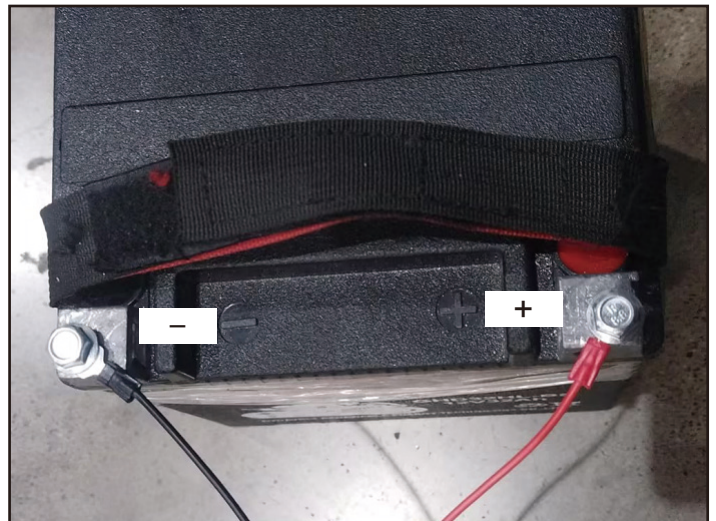

4.3 Start the vehicle and perform the handlebar heating test (refer to the "Heating Switch Operation" section for handlebar heating procedures). After confirming proper installation, secure each cable in its appropriate position using cable ties.

4.4 Reinstall all previously removed components.

5. MAIN CABLE WITH POWER CONNECTOR:

5.1 Connect the left heated grip, right heated grip, and thumb heater as shown in the diagram below.

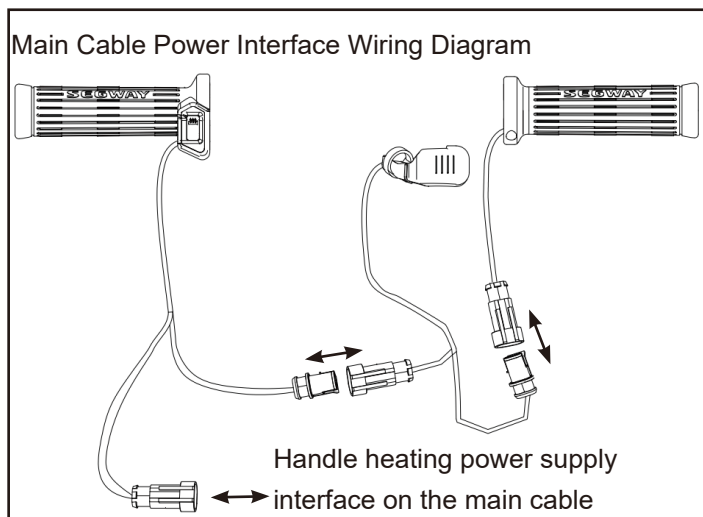

5.2 Remove the front storage compartment lid; the handle heating power connector is located underneath.

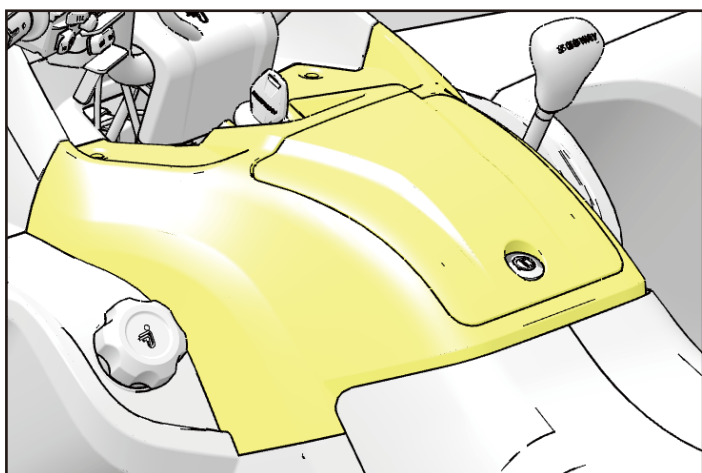

5.3 Connect the power interface on the left heated grip to the vehicle's grip heater power interface.

5.4 Start the vehicle and perform a grip heater function test (refer to the "Heating Switch Operation" section for operating instructions).

Once correct installation is confirmed, secure the cables in place using cable ties at appropriate positions.

5.5 Reinstall all previously removed components.

HEATING SWITCH OPERATION:

- * When normal operating voltage is present at the input, press the heating control switch to activate the grip heaters.
- * The system will initially operate at full load for a period of time, then switch to load output control based on the selected mode.
- * Default mode: Level 1 – LED indicator illuminates blue, 20% load output mode activated.
- * Press the switch again to increase to Level 2 – LED indicator illuminates cyan; 40% load output mode activated.
- * *Press the switch again to increase to Level 3 – LED indicator illuminates green; 60% load output mode activated.
- * Press the switch again to increase to Level 4 – LED indicator illuminates purple; 80% load output mode activated.
- * Press the switch again to increase to Level 5 – LED indicator illuminates red; 100% load output mode activated.
- * When at Level 5, press the switch once more to turn off the grip heater function.

CAUTION

Over-voltage & Under-voltage Protection: When the input voltage falls below $12.2\pm 0.2V$ or rises above $16\pm 0.2V$, the indicator LED will flash several times, then the controller will shut off output and enter protection mode. Once the voltage returns to normal, the controller will resume normal operation.

FRONT BIG BUMPER

FRONT BIG BUMPER

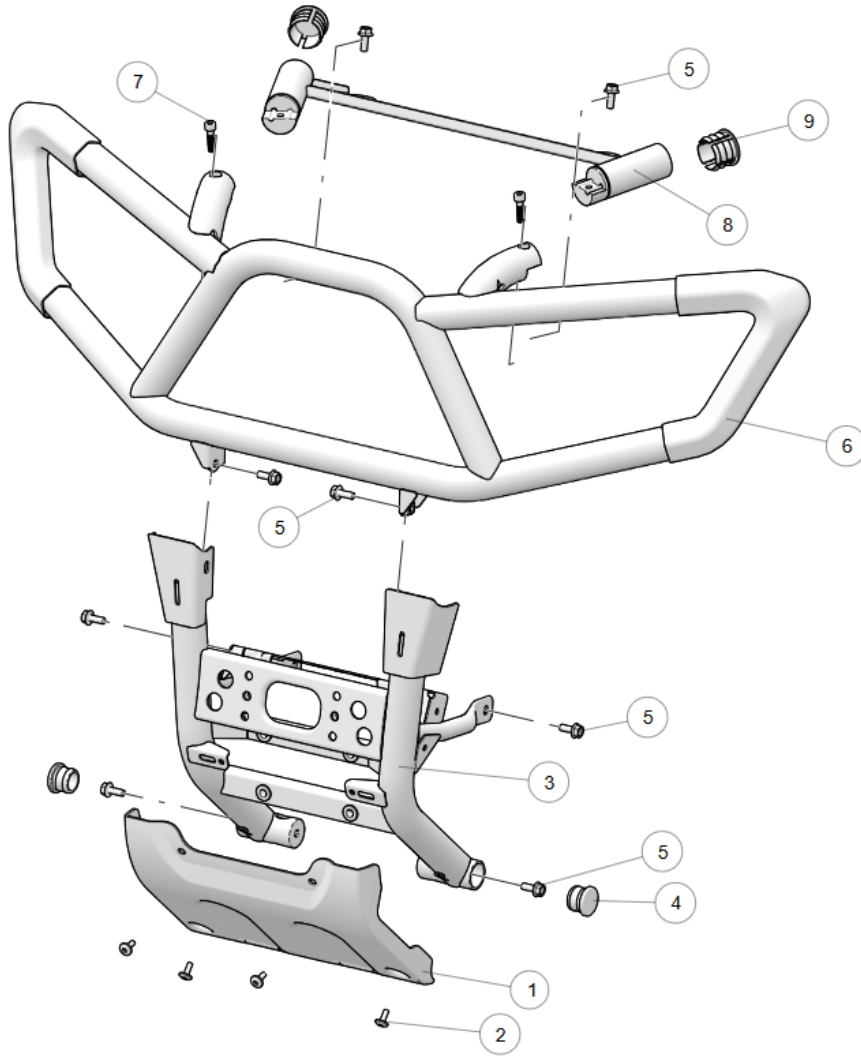

ITEM	PART NAME	PART NUMBER	QTY	REMARKS
1	FRONT BUMPER COVER	A12-H111100-0B0-00	1	AT10/AT10 W
2	BOLT M6×16	T03000007002	1	
3	FRONT BIG BUMPER 1	A12-R100100-0MP-00	1	AT10/AT10 W
4	FRONT BUMPER PLUG	A02H16000001		AT10/AT10 W
5	HEXAGON FLANGE BOLT M8×20	GBT005789015		
6	FRONT BIG BUMPER 2	A12-R100200-0MP-00		AT10/AT10 W
7	BOLT M8×30	GBT000701029		
8	TRANSFER BRACKET	A12-R100300-0MP-00		AT10/AT10 W
9	FRAME PLUG	S05H11700001	1	

FRONT BIG BUMPER

BUMPER INSTALLATION

1. Remove the winch hook assembly from the vehicle bumper, then remove the 4 mounting bolts securing the bumper and detach the bumper.

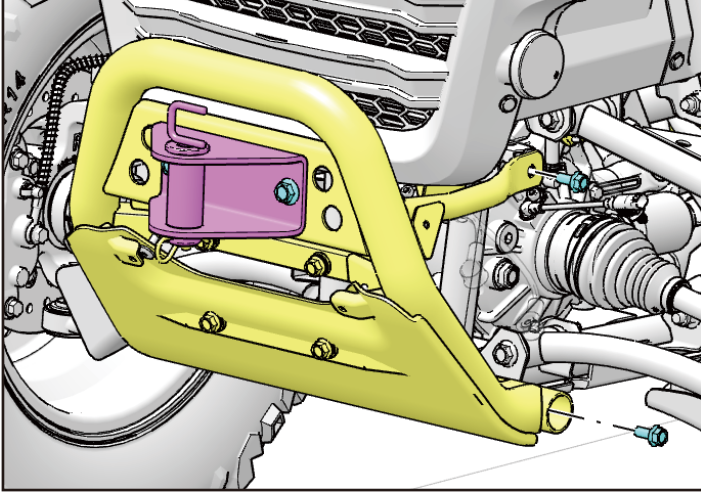

2. Remove the front rack assembly.

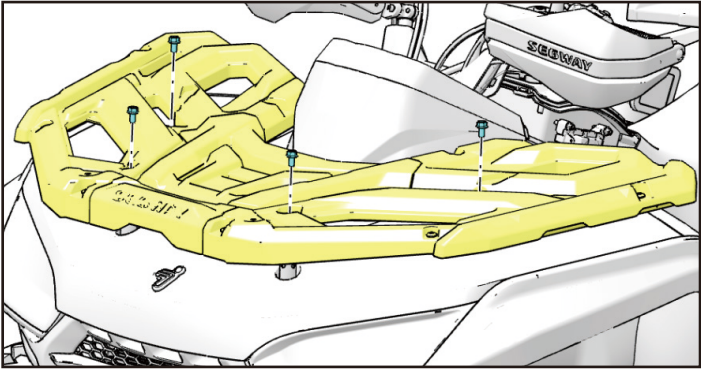

3. Secure the front big bumper weldment 1 to the vehicle using 4 pieces of angle flange bolts M8×25, and install the front bumper end caps. Reinstall the removed winch hook assembly to the corresponding position on the bumper.

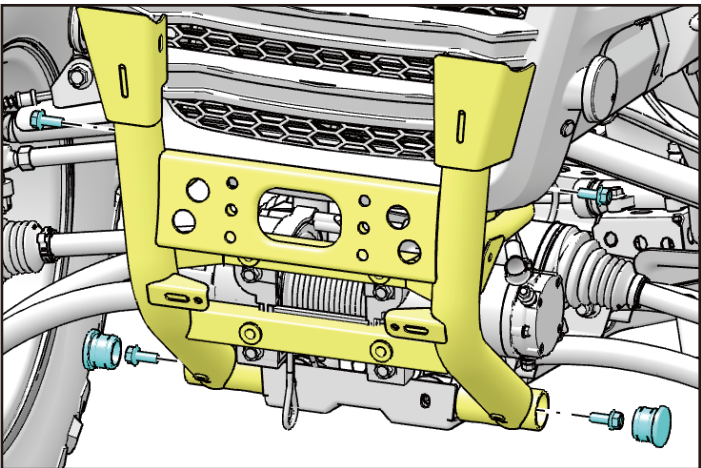

4. Install the bumper skid plate onto the new bumper using 4 large pan head hexagon socket head cap screws M6 × 16. Tightening torque: 8 – 12 N·m .

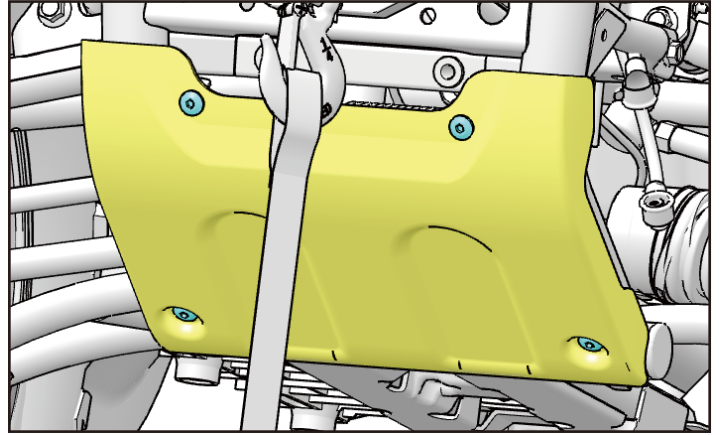

5. Secure front heavy-duty bumper weldment 2 to front heavy-duty bumper weldment 1 using 2 pieces of hexagon flange bolts M8×20. Tightening torque: 30 –40 N·m .

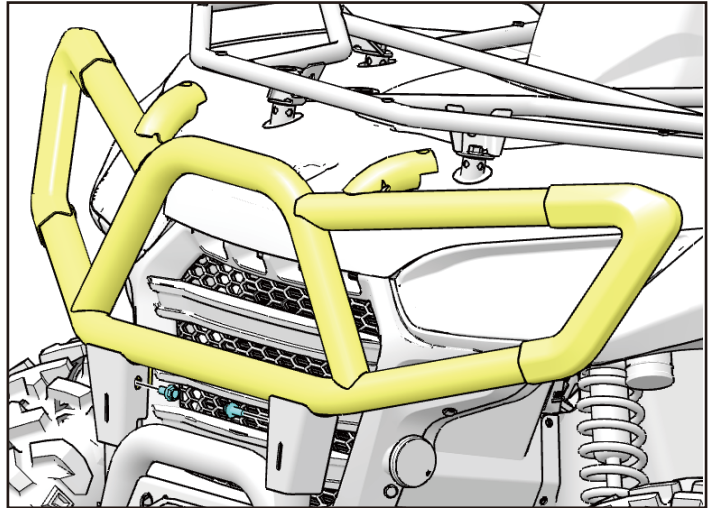

6. Secure the heavy-duty bumper adapter bracket assembly to front heavy-duty bumper weldment 2 using 2 pieces of hexagon socket head cap screws M8×30. On the other side, secure it to the front rack using 2 pieces of hexagon flange bolts M8×20 (shared with the first two mounting holes on the front rack). Then install the frame end caps.

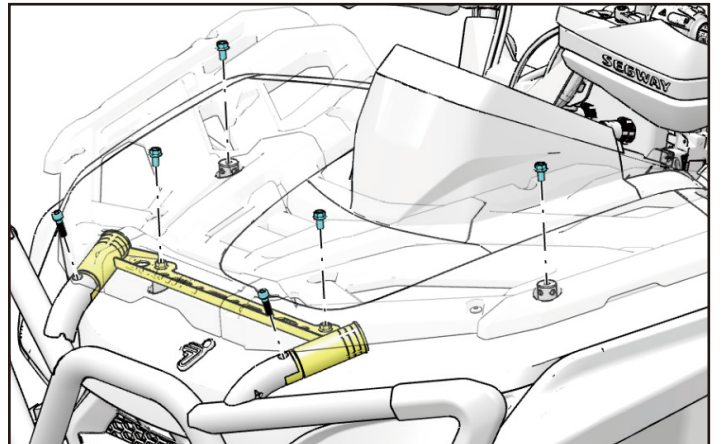

SNOW PLOUGH

SNOW PLOUGH

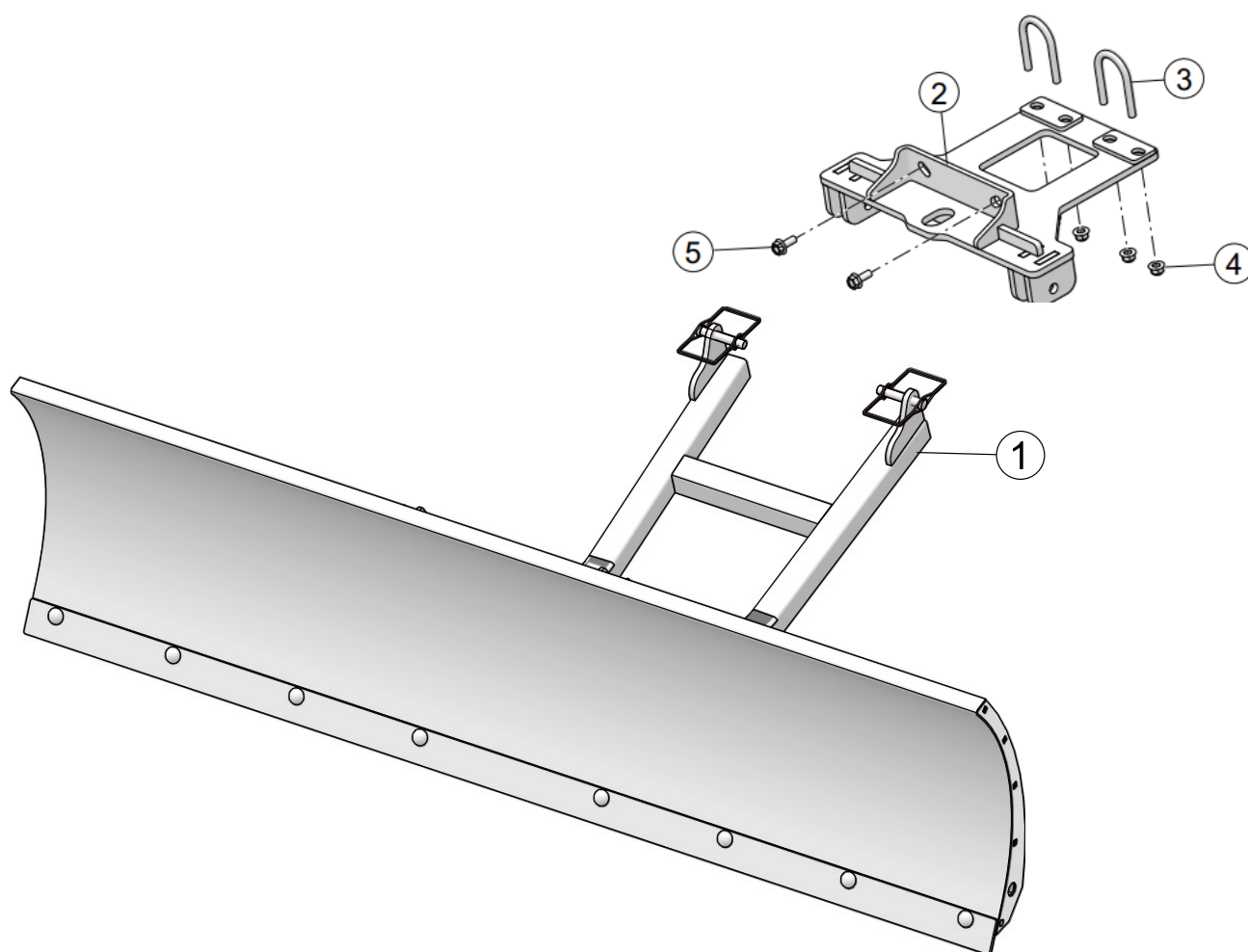

ITEM	PART NAME	PART NUMBER	QTY	REMARKS
1	SNOW PLOUGH	A02-R002100-000-00	1	
2	SNOW PLOW BRACKET	A12-R101000-FB0-00	1	AT10/AT10 W
3	U-BOLT	A12-R102000-000-00	2	AT10/AT10 W
4	HEXAGON FLANGE BOLT M8×20	GBT005789015	2	
5	NUT M8	GBT061831003	4	

TIPS

These installation instructions apply to multiple ATV models. Illustrations may vary slightly; please refer to the actual vehicle.

SNOW PLOUGH

TIPS

The snow plow assembly must be used in conjunction with a winch.

SNOW PLOW WELDMENT ASSEMBLY

The snow plow weldment is an optional accessory. If the snow plow weldment has been purchased, it must be assembled first. Please refer to the Snow Plow Assembly Instruction for guidance.

The snow plow weldment must be fully assembled before installation.

SNOW PLOW ASSEMBLY INSTALLATION

1. Remove the 4 mounting bolts from the front bumper skid Plate.

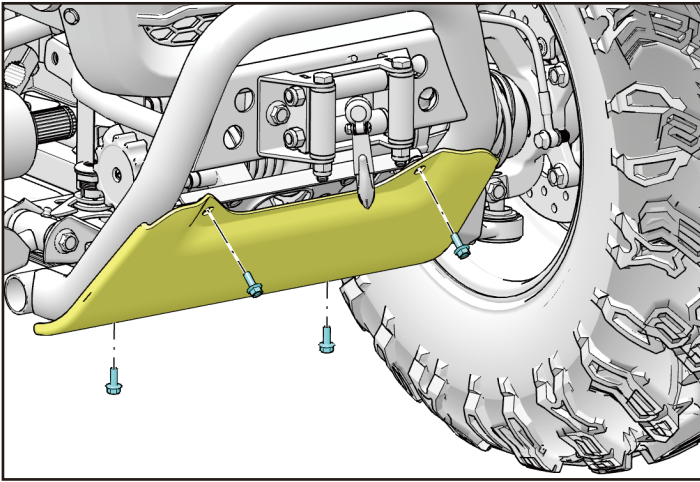

2. Remove the 2 mounting bolts from the underside of the front bumper.

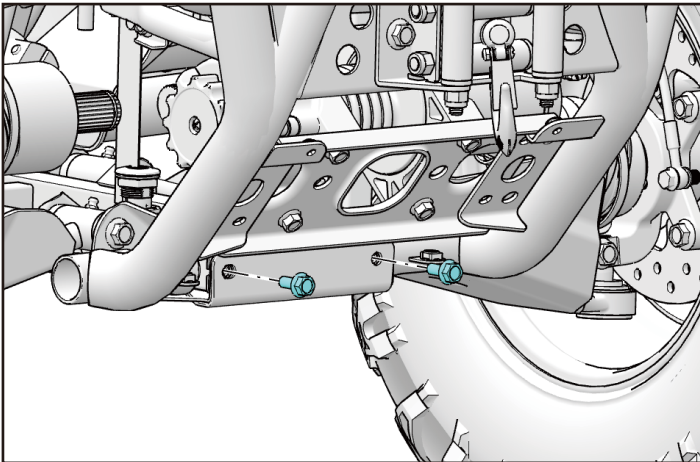

3. Position the snow plow front adapter assembly under the front of the vehicle, aligning its front mounting holes with the mounting holes on the underside of the front bumper. Secure the snow plow front adapter assembly to the front bumper using 2 pieces of hexagon flange bolts M10×1.25×25. Do not fully tighten the bolts at this stage.

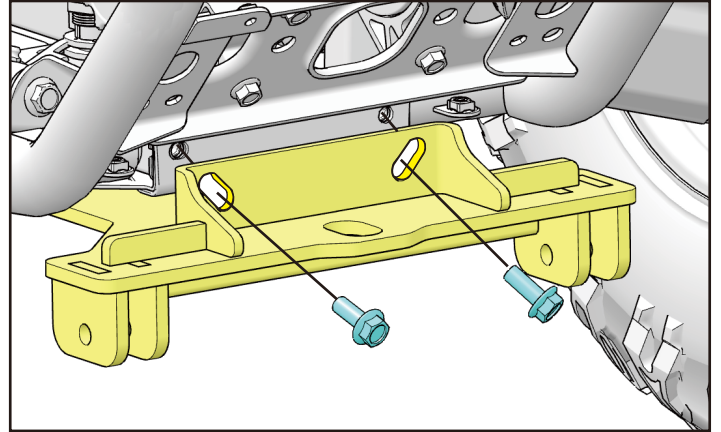

4. Adjust the snow plow front adapter assembly so that it fits flush against the lower support tube of the front rocker arm. Insert the U-bolts through the lower support tube and the corresponding mounting holes on the snow plow front adapter assembly. Secure them using 4 pieces of M8 nuts. Fully tighten all fasteners.

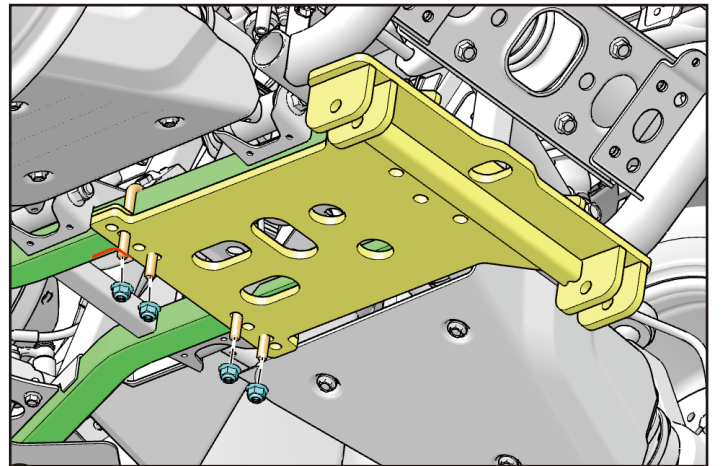

5. Unfasten the wire clips on the snow plow. Insert the bolts through the mounting holes on the snow plow front adapter assembly, then reattach the wire clips onto the bolts.

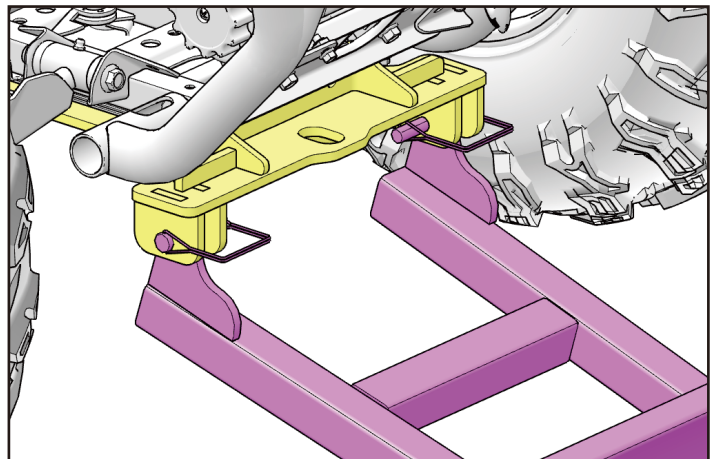

SKID PLATE (AT10)

SKID PLATE (AT10)

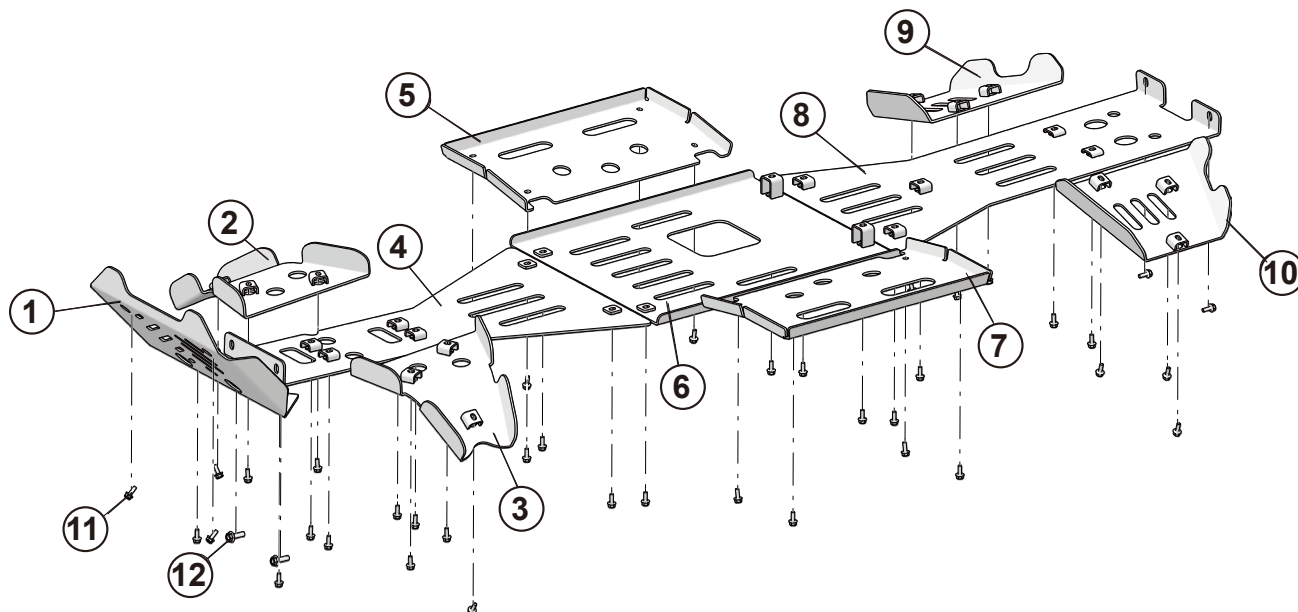

ITEM	PART NAME	PART NUMBER	QTY	REMARKS
1	FRONT GUARD	A03-R112000-FH1-00	1	AT10 / AT10W / AT6
2	FRONT RIGHT ROCKER ARM GUARD	A12-R102100-FH1-00	1	AT10
3	FRONT LEFT ROCKER ARM GUARD	A12-R102200-FH1-00	1	AT10
4	FRONT BOTTOM GUARD	A12-R102300-FH1-00	1	AT10 / AT10W
5	RIGHT FOOTREST GUARD	A12-R102400-FH1-00	1	AT10 / AT10W
6	MID BOTTOM GUARD	A12-R102500-FH1-00	1	AT10 / AT10W
7	LEFT FOOTREST GUARD	A12-R102600-FH1-00	1	AT10 / AT10W
8	REAR BOTTOM GUARD	A12-R102700-FH1-00	1	AT10 / AT10W
9	REAR LEFT ROCKER ARM GUARD	A12-R102800-FH1-00	1	AT10
10	REAR RIGHT ROCKER ARM GUARD	A12-R102900-FH1-00	1	AT10
11	HEXAGON FLANGE BOLT M6×16	GBT005789007	41	
12	HEXAGON FLANGE BOLT M8×25	GBT005789016	2	

TIPS

These installation instructions apply to multiple ATV models. Illustrations may vary slightly; please refer to the actual vehicle.

SKID PLATE (AT10)

REMOVAL OF ORIGINAL EQUIPMENT SKID PLATE

Before installing the new vehicle Skid Plate, remove the original Skid Plate from the vehicle.

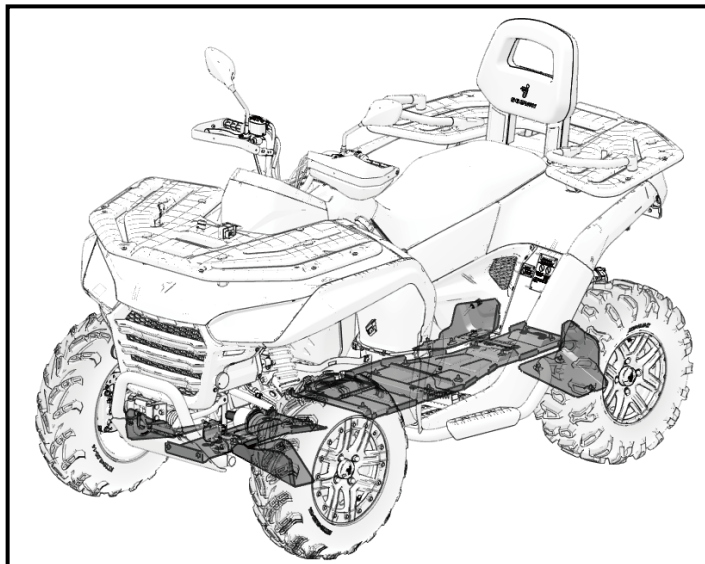

1. Remove the fasteners from the Skid Plate to be replaced in sequence, then take off the Skid Plate.

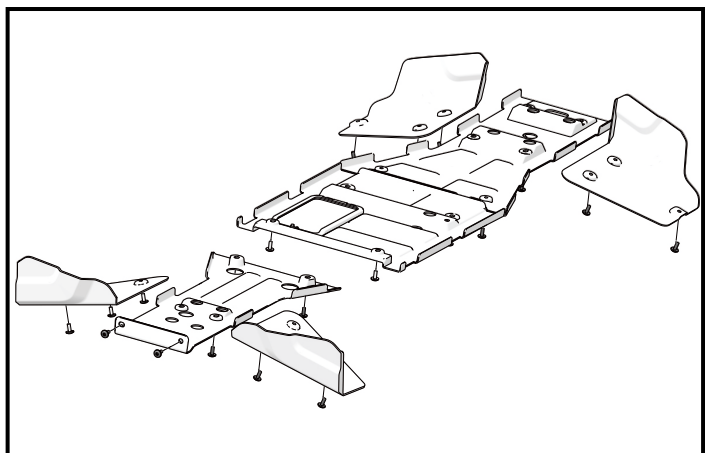

TIPS

No specific sequence is required for removal.

SKID PLATE INSTALLATION

1. Secure the front guard plate using 2 × hexagon flange bolts M8×20.
2. Secure the front, mid, rear, left and right footrest Skid Plates, and rocker arm guard plates using 41 × hexagon flange bolts M6×16:

Bolt M8, tightening torque: 30–40 N·m

Bolt M6, tightening torque: 8–12 N·m

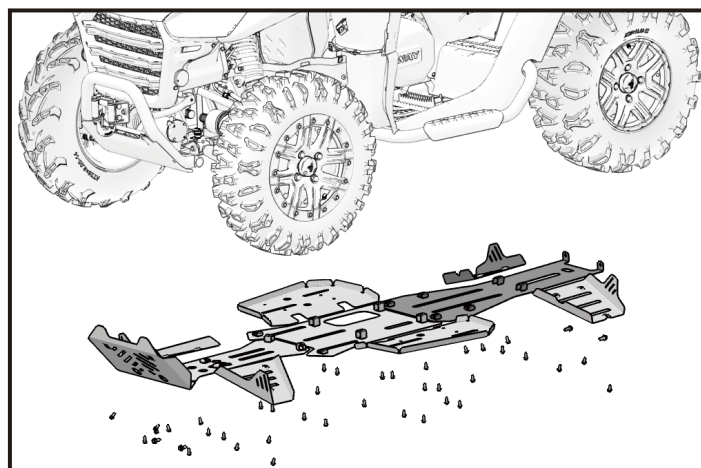

TIPS

No specific sequence is required for removal.

SKID PLATE (AT10 W)

SKID PLATE (AT10 W)

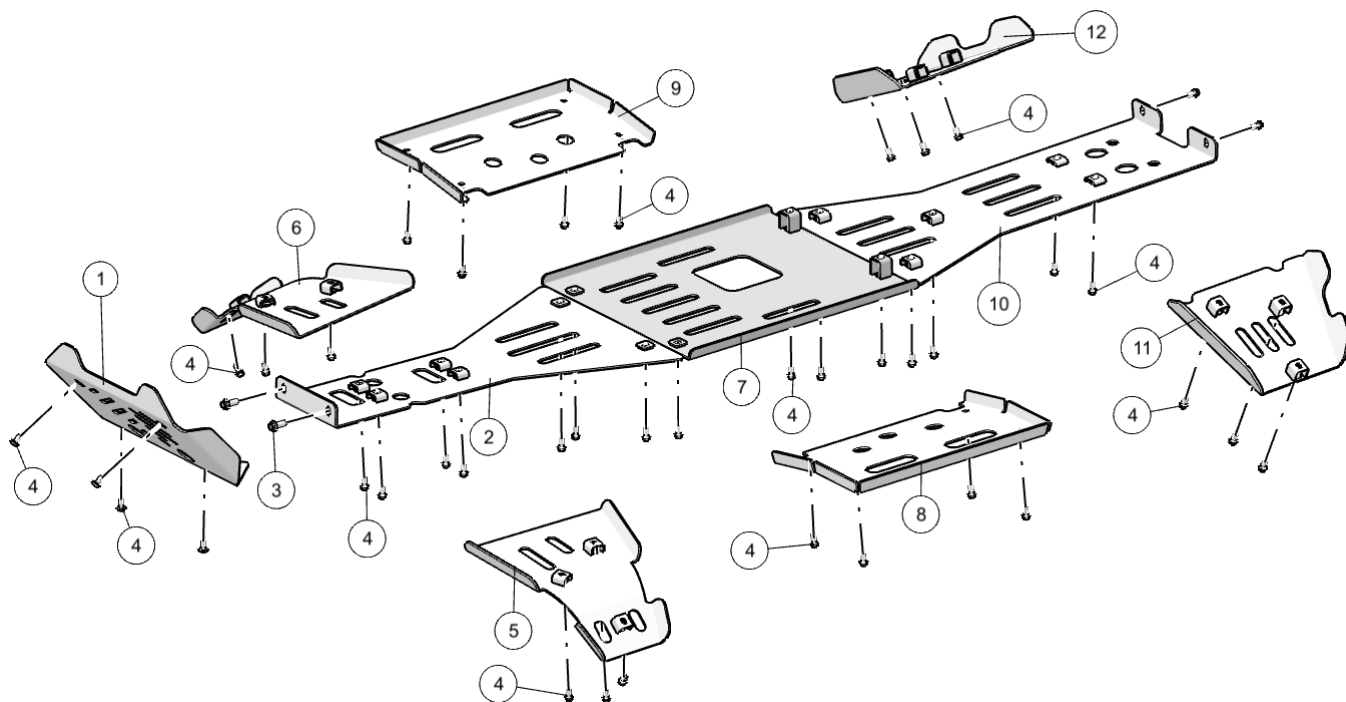

ITEM	PART NAME	PART NUMBER	QTY	REMARKS
1	FRONT GUARD	A03-R112000-FH1-00	1	AT10 / AT10W /AT6
2	FRONT BOTTOM GUARD	A12-R102100-FH1-00	1	AT10 / AT10W
3	BOLT M8×25	GBT005789016	2	
4	BOLT M6×16	GBT005789007	41	
5	FRONT LEFT ROCKER ARM GUARD	A13-R102600-FH1-00	1	AT10W
6	FRONT RIGHT ROCKER ARM GUARD	A13-R102700-FH1-00	1	AT10W
7	MID BOTTOM GUARD	A12-R102200-FH1-00	1	AT10 / AT10W
8	LEFT FOOTREST GUARD	A12-R102400-FH1-00	1	AT10 / AT10W
9	RIGHT FOOTREST GUARD	A12-R102500-FH1-00	1	AT10 / AT10W
10	REAR BOTTOM GUARD	A12-R102300-FH1-00	1	AT10 / AT10W
11	REAR LEFT ROCKER ARM GUARD	A13-R102800-FH1-00	1	AT10W
12	REAR RIGHT ROCKER ARM GUARD	A13-R102900-FH1-00	1	AT10W

TIPS

These installation instructions apply to multiple ATV models. Illustrations may vary slightly; please refer to the actual vehicle.

SKID PLATE (AT10)

REMOVAL OF ORIGINAL EQUIPMENT SKID PLATE

Before installing the new vehicle Skid Plate, remove the original Skid Plate from the vehicle.

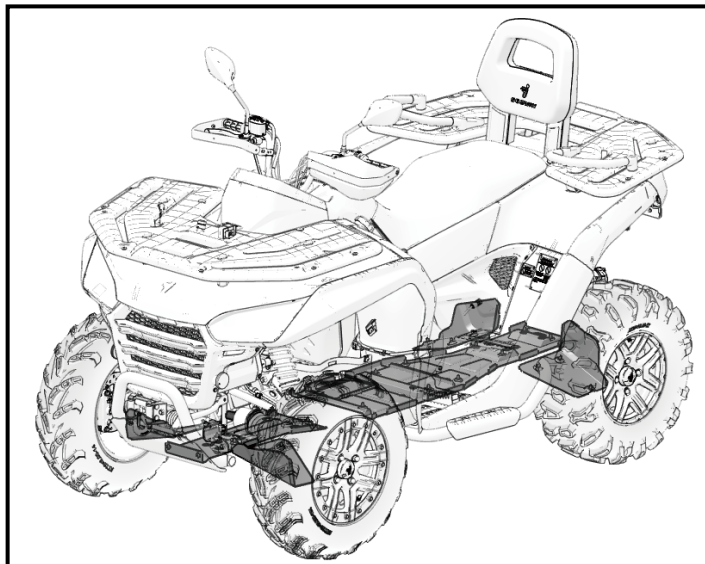

1. Remove the fasteners from the Skid Plate to be replaced in sequence, then take off the Skid Plate.

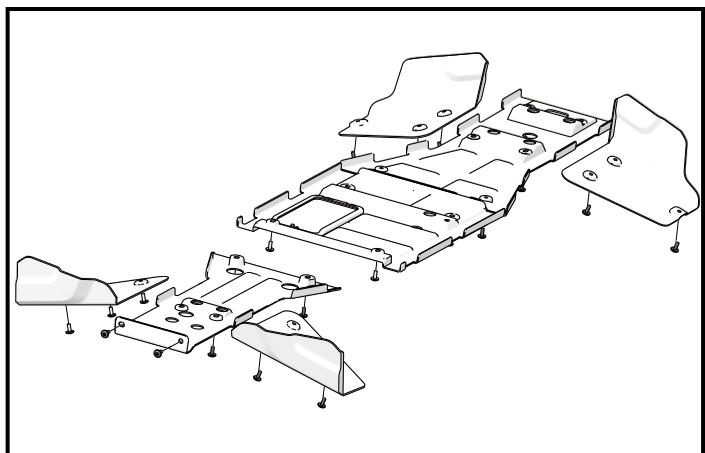

TIPS

No specific sequence is required for removal.

SKID PLATE INSTALLATION

1. Secure the front guard plate using 2 × hexagon flange bolts M8×20.
2. Secure the front, mid, rear, left and right footrest Skid Plates, and rocker arm guard plates using 41 × hexagon flange bolts M6×16:

Bolt M8, tightening torque: 30–40 N·m

Bolt M6, tightening torque: 8–12 N·m

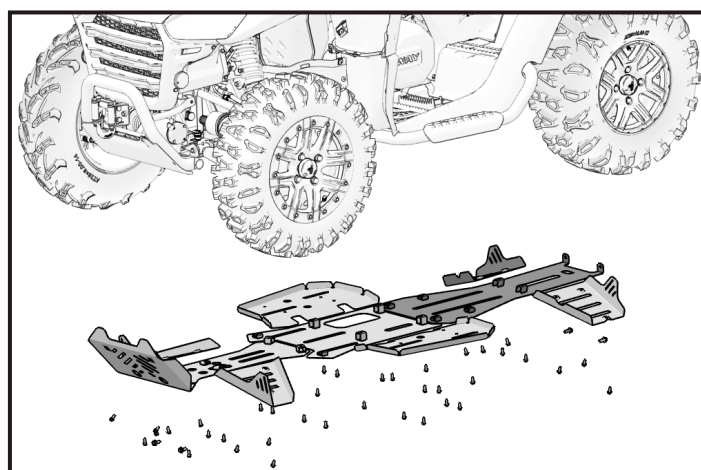

TIPS

No specific sequence is required for removal.

TRACK WIDENER (AT10 W)

TRACK WIDENER

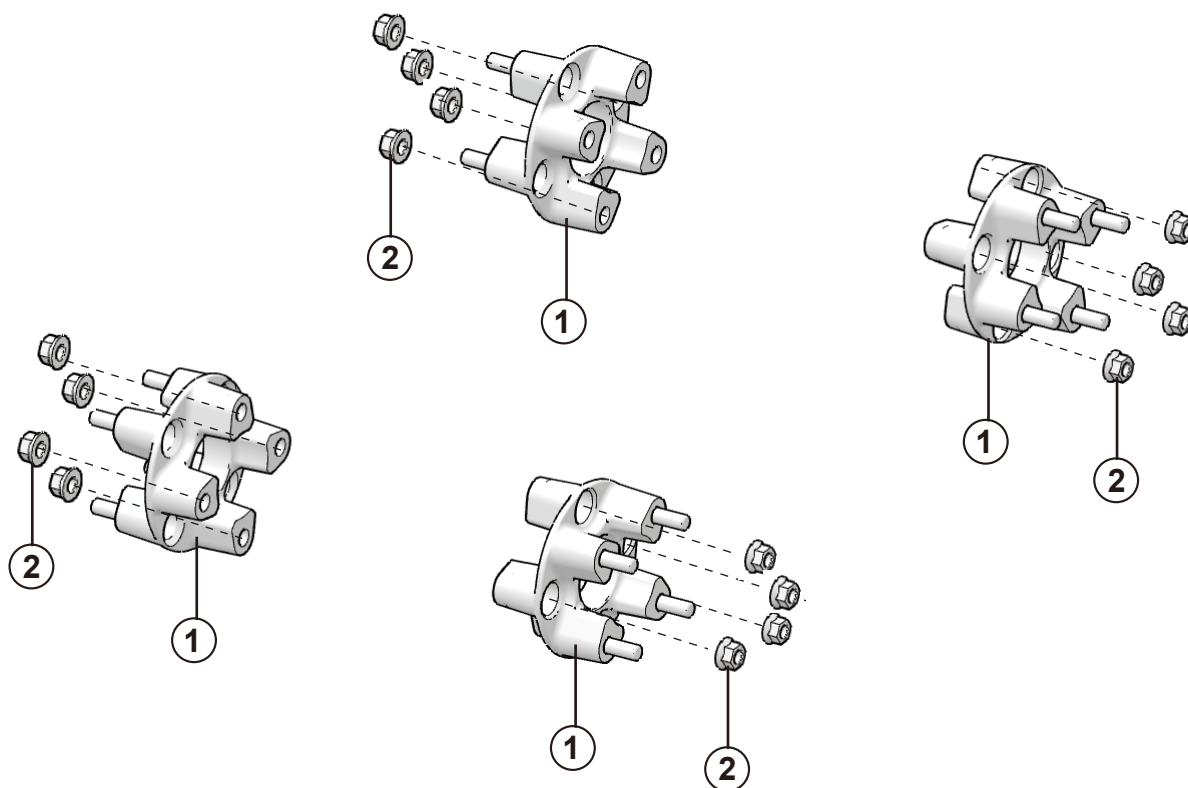

ITEM	PART NAME	PART NUMBER	QTY	REMARKS
1	TRACK WIDENER	A12-F200020-000-00	4	AT10/AT6/AT5
2	NUT M12×1.25	GBT061872003	16	

TIPS

These installation instructions apply to multiple ATV models. Illustrations may vary slightly; please refer to the actual vehicle.

TRACK WIDENER (AT10 W)

VEHICLE LIFTING AND TIRE REMOVAL

1. Use a jack to lift the vehicle until the tires are off the ground. The front and rear support points are located at the center of the front, rear, left, and right sides of the vehicle.

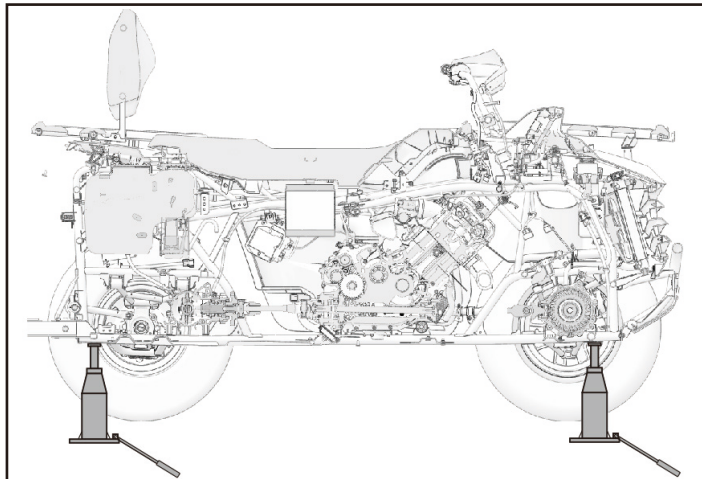

TIPS

Vehicle lifting equipment includes, but is not limited to, jacks.

2. Remove the 4 wheel lug nuts from the tire assembly, then take off the tire assembly.

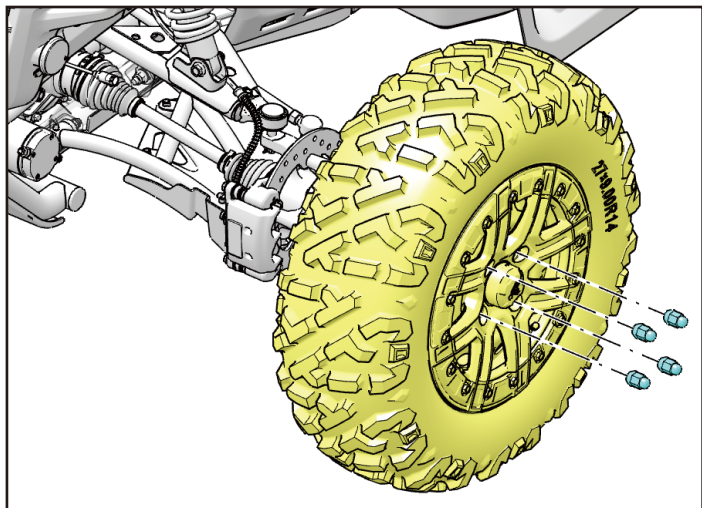

TIPS

All four tire assemblies are removed in the same manner, in any order.

TRACK WIDENER INSTALLATION

1. Install the wheel spacers onto the wheel mounting seats using 4 × all-metal hexagon flange lock nuts M12×1.25.
2. Tighten the nuts in a diagonal pattern, Tightening torque for M12 lock nuts: 100–120 N·m.

- ① RIM SEAT ② TRACK WIDENER
③ NUT M12×1.25

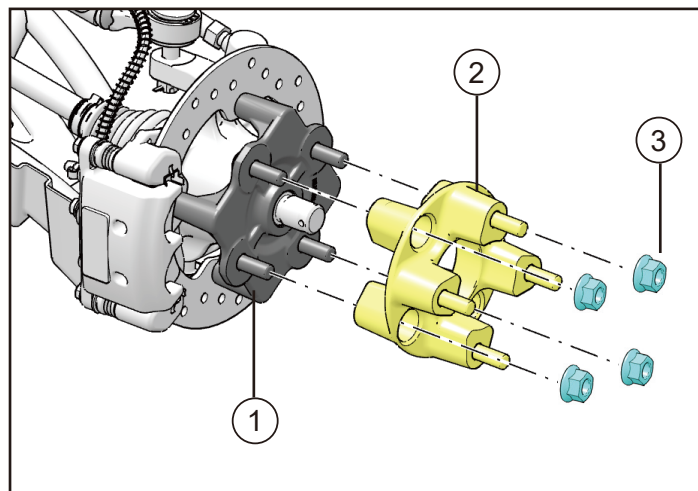

3. Reinstall the previously removed tire assemblies onto the wheel spacers using the 4 wheel lug nuts (removed earlier).

4. Tighten the nuts in a diagonal pattern. Tightening torque for wheel lug nuts: 100–120 N·m.

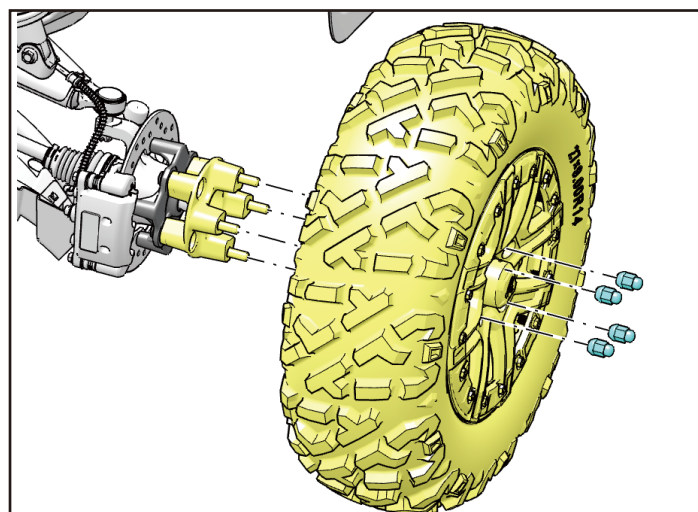

TIPS

All four wheel spacers are installed in the same manner.

REAR CARGO BOX

REAR CARGO BOX

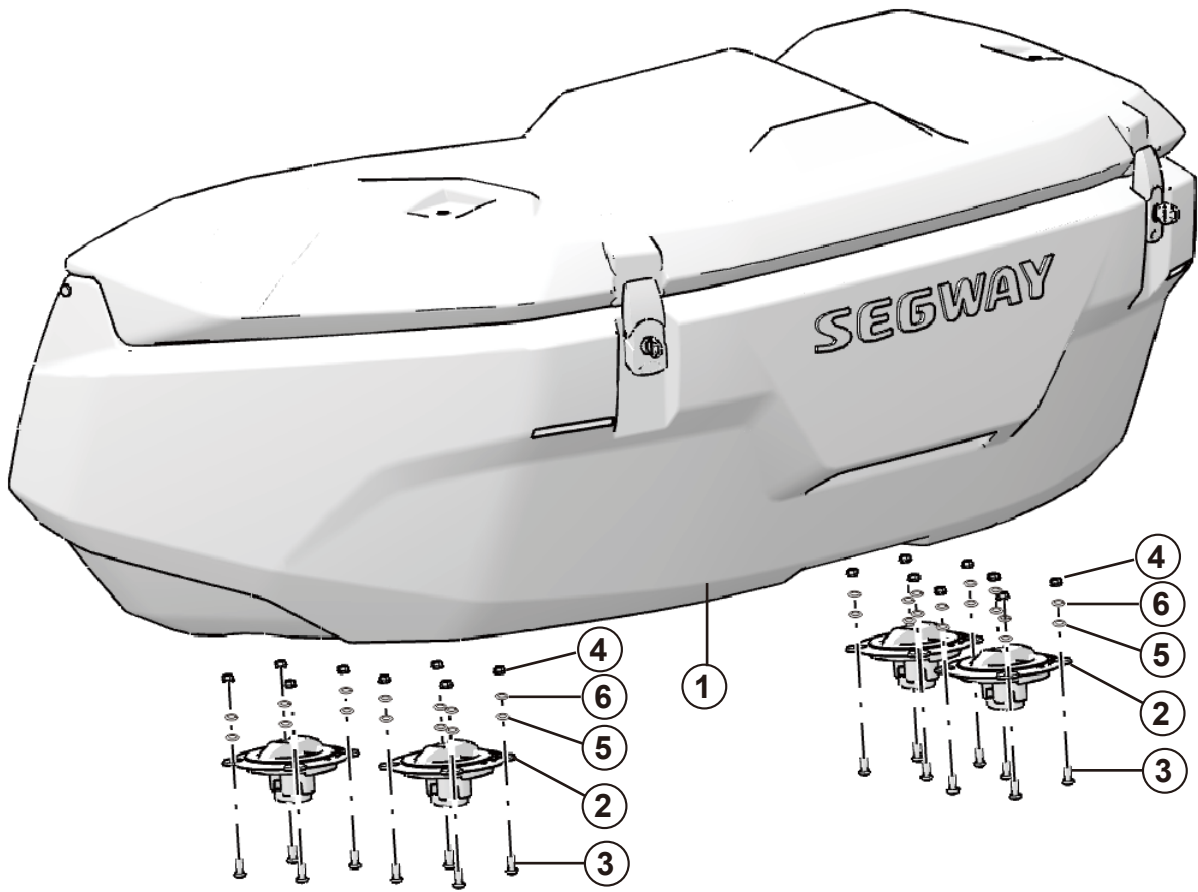

ITEM	PART NAME	PART NUMBER	QTY	REMARKS
1	AT10 REAR CARGO BOX	A12-H091000-000-00	1	
2	SELF-LOCKING MECHANISM	A02H18100001	4	
3	SCREWS M5×12	GBT000818004	16	
4	NUT M5	GBT061871001	16	
5	SPRING WASHER	—	16	
6	PLAIN WASHER	—	16	

REAR CARGO BOX

TIPS

This cargo box is only suitable for vehicles with four mounting holes on the shelf cover plate.

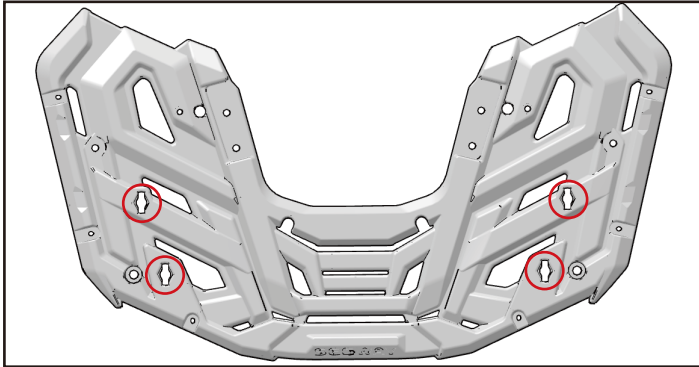

REAR STORAGE BOX INSTALLATION

1、 Remove the self-locking mechanism, rotate the handwheel on the self-locking mechanism, and turn the side marked with "△" to the "🔓" position

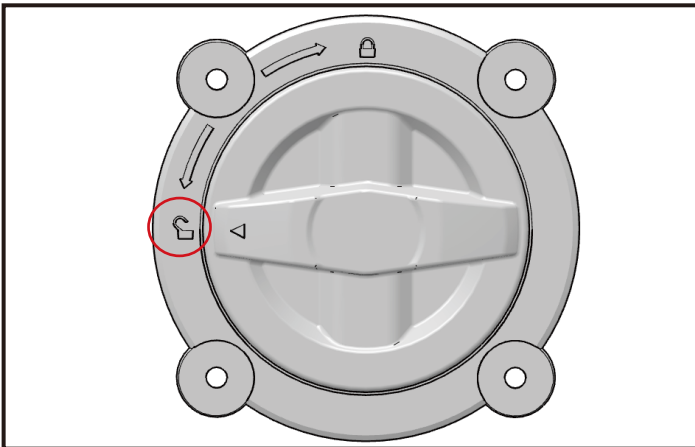

2、 Place the self-locking mechanism into the designated hole in the rear cargo compartment's bottom according to the specified orientation.

TIPS

Pay attention to the placement direction of the self-locking mechanism.

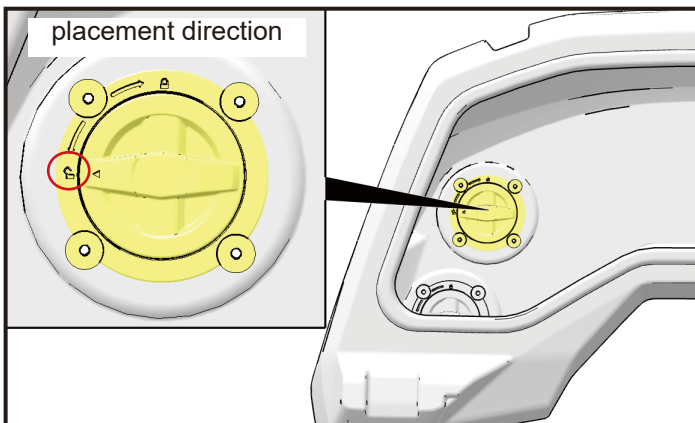

3、 Use 16 pieces of M5x12 cross-head pan head screws, flat washers, spring washers, and nuts to secure the 4 self-locking mechanisms to the holes on the bottom of the rear cargo box.

- ① screw M5 x12 ② Flat washer
- ③ Spring washer ④ nut

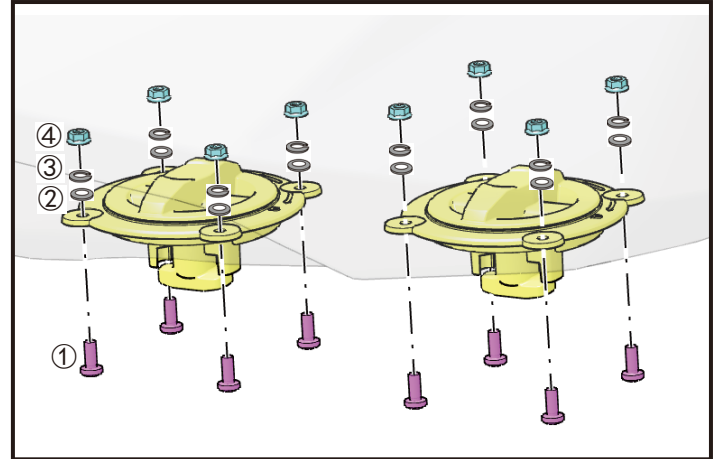

4、 Place the rear cargo with the self-locking mechanism installed on the vehicle's rear rack, aligning the self-locking mechanism with the fixed position on the rack cover plate.

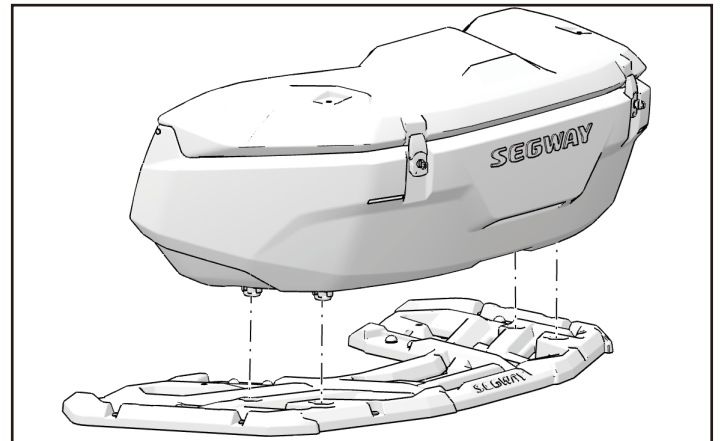

5、 Rotate the handle on the self-locking mechanism to position the side marked with "△" to the "🔒" position. Once all four self-locking mechanisms are fully secured, the rear cargo The box can be fixed on the shelf.

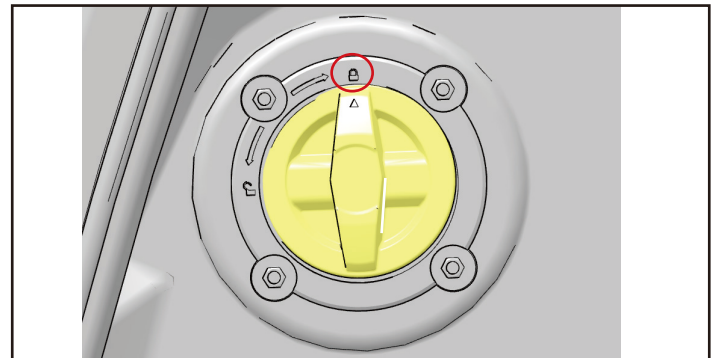

TIPS

After installation, check whether it is properly installed.

FRONT WINDSHIELD (AT10/AT6)

FRONT WINDSHIELD

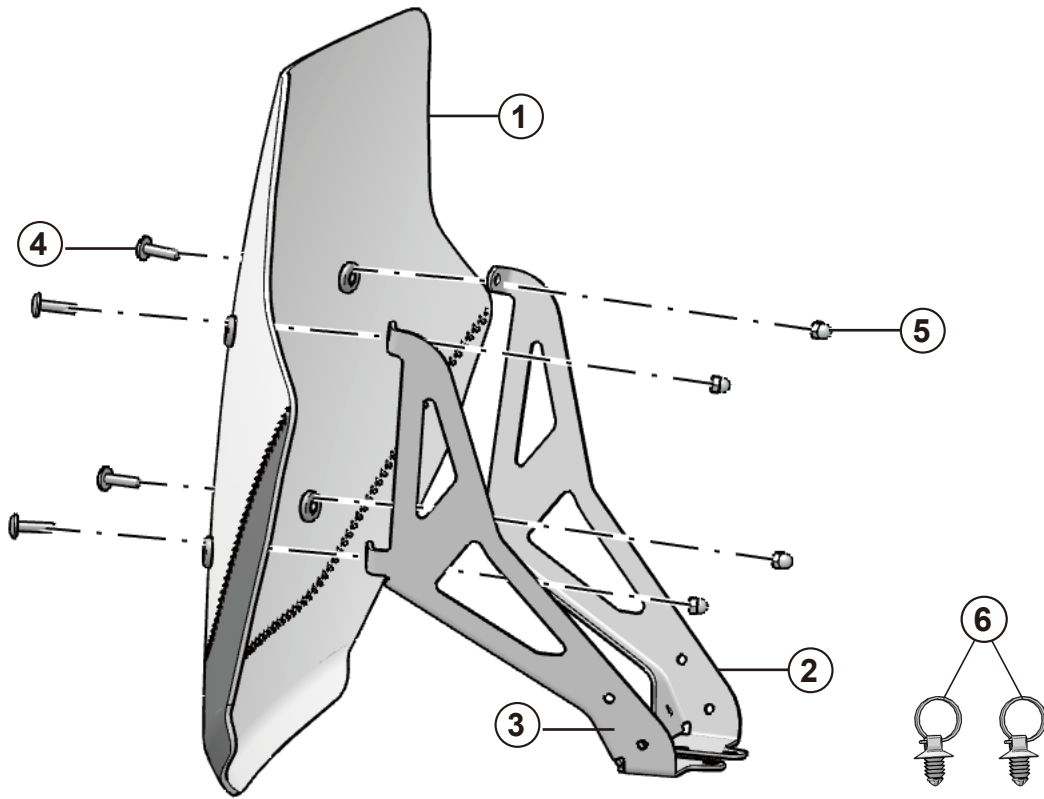

ITEM	PART NAME	PART NUMBER	QTY	REMARKS
1	PC FRONT WINDSHIELD	A12-R103300-000-00	1	
2	RIGHT BRACKET, FRONT WINDSHIELD	A12-R103200-FB0-00	1	AT10 \ AT6
3	LEFT BRACKET, FRONT WINDSHIELD	A12-R103100-FB0-00	1	AT10 \ AT6
4	BOLT M6×25	T03000007007	4	
5	NUT M6	BG009230-06012-Z61	4	
6	POSITIONING TIE Φ7×180	T05000001004	2	

TIPS

These installation instructions apply to multiple ATV models. Illustrations may vary slightly; please refer to the actual vehicle.

FRONT WINDSHIELD (AT10/AT6)

1. Remove the mounting bolts from the handlebar cover (if equipped) and take off the cover. If a windshield is installed, the handlebar cover does not need to be reinstalled.

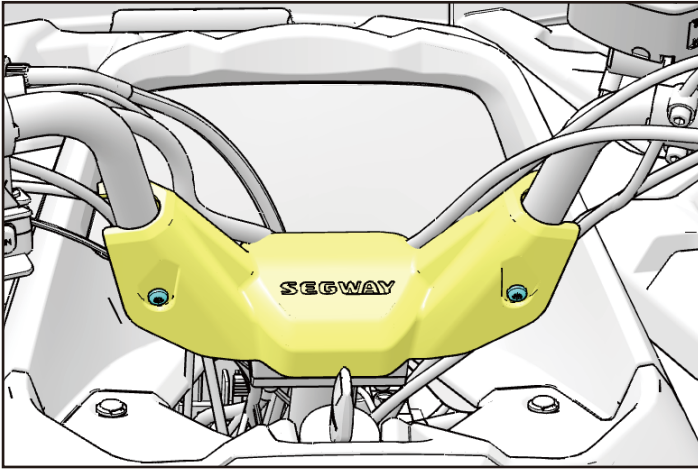

2. Remove the 4 bolts from the upper aluminum cover of the handlebar, then take off the cover.

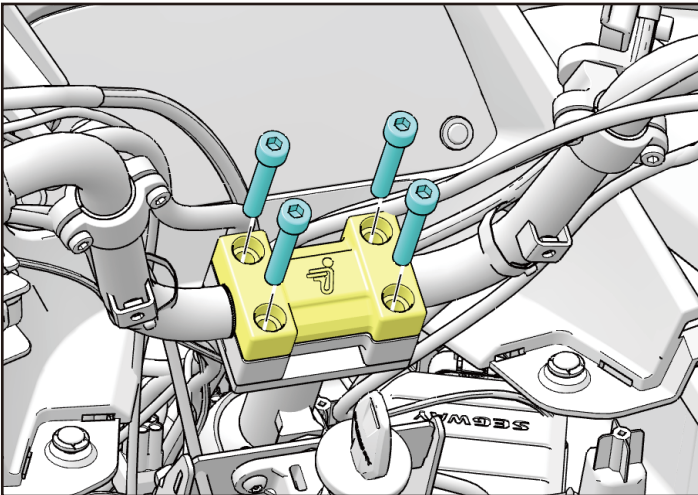

3. Move the handlebar and the lower aluminum cover of the handlebar upward to create a gap at the bottom. Then, place the left and right windshield brackets under the lower aluminum cover of the handlebar.

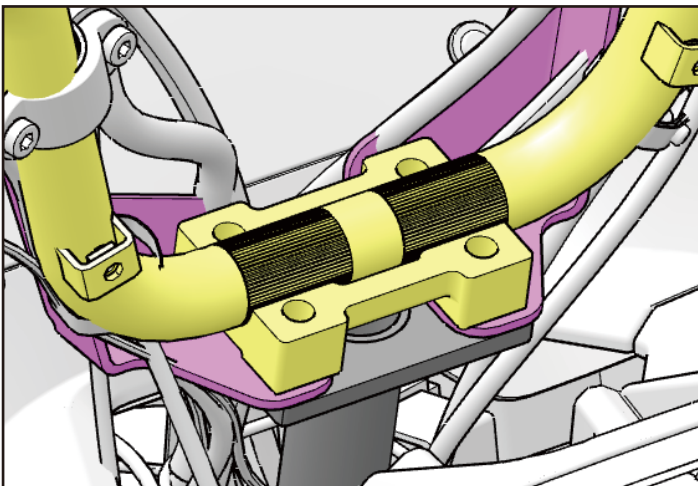

4. Adjust the handlebar to the desired position, then secure it using the 4 handlebar mounting bolts. Tightening torque: $35 \pm 3 \text{ N}\cdot\text{m}$.

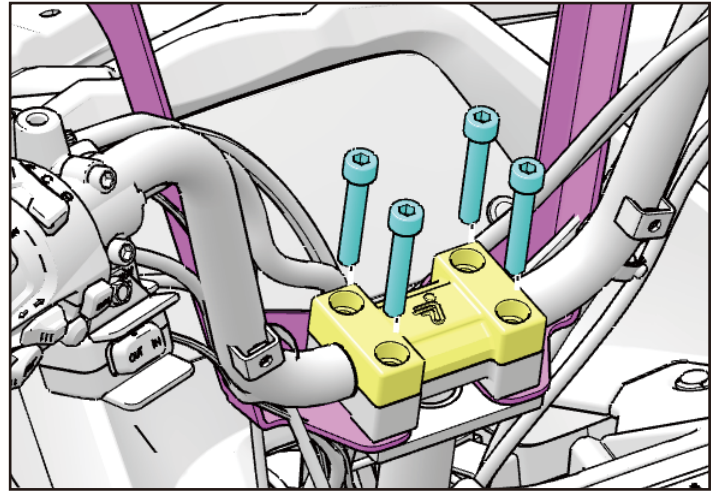

5. Install the windshield onto the brackets using 4 pieces of bolts M6×25 and 4 pieces of nuts M6. Tightening torque: $10 \pm 3 \text{ N}\cdot\text{m}$.

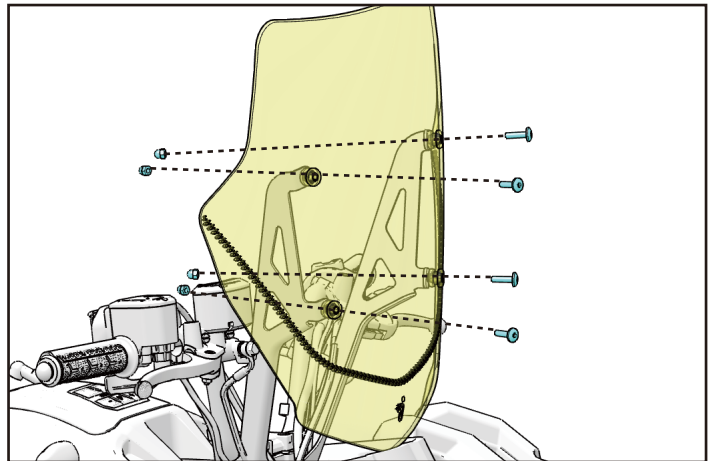

6. Depending on the actual condition of the vehicle, secure the left handlebar wiring harness to the left windshield bracket using cable ties. Secure the brake hose and parking lever cable to the right windshield bracket using cable ties.



HEATING CUSHION

HEATING CUSHION

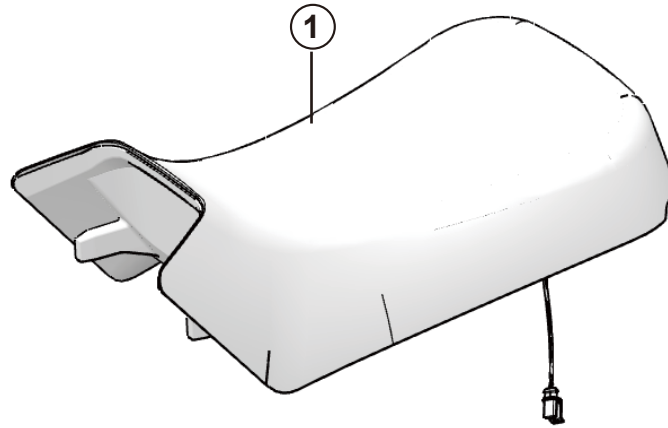

ITEM	PART NAME	PART NUMBER	QTY	REMARKS
1	HEATING CUSHION	A12-K102000-000-00	1	
	HEATING CUSHION, RED	A12-K103000-000-00	1	

ORIGINAL CUSHION REMOVAL

1. remove the back seat.
2. Lift the seat cushion upwards. If there is a wiring harness, unplug the wiring harness plug and remove the seat cushion.

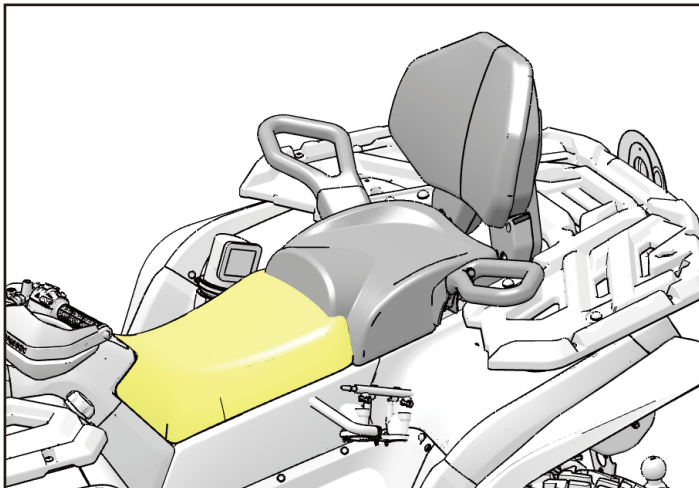

INSTALLATION

1. Connect the plug on the heated seat cushion to the plug on the vehicle.
2. Insert the front of the seat cushion into the U-shaped bracket welded to the frame, push the seat forward with force, and press the seat down to lock it.
3. nstall the back seat.

