



**SEGWAY**

# **SEGWAY AT6 ACCESSORIES INSTALLATION MANUAL**



# CONTENTS

LARGE FRONT BUMPER COMPONENT.....	3
ALUMINUM FLOOR GUARD ASSY(AT6 L) .....	7
ALUMINUM FLOOR GUARD ASSY(AT6 S) .....	9
FRONT AND REAR STORAGE BOXES .....	11
F L/R WHEEL FENDER.....	14
TURN SIGNAL CONTROL ASSEMBLY .....	16
SNOW SHOVEL ASSEMBLY .....	20
FULL COVERAGE BUMPER .....	22
CARGO BARRIER RAIL .....	24

# LARGE FRONT BUMPER COMPONENT

## LARGE FRONT BUMPER COMPONENT

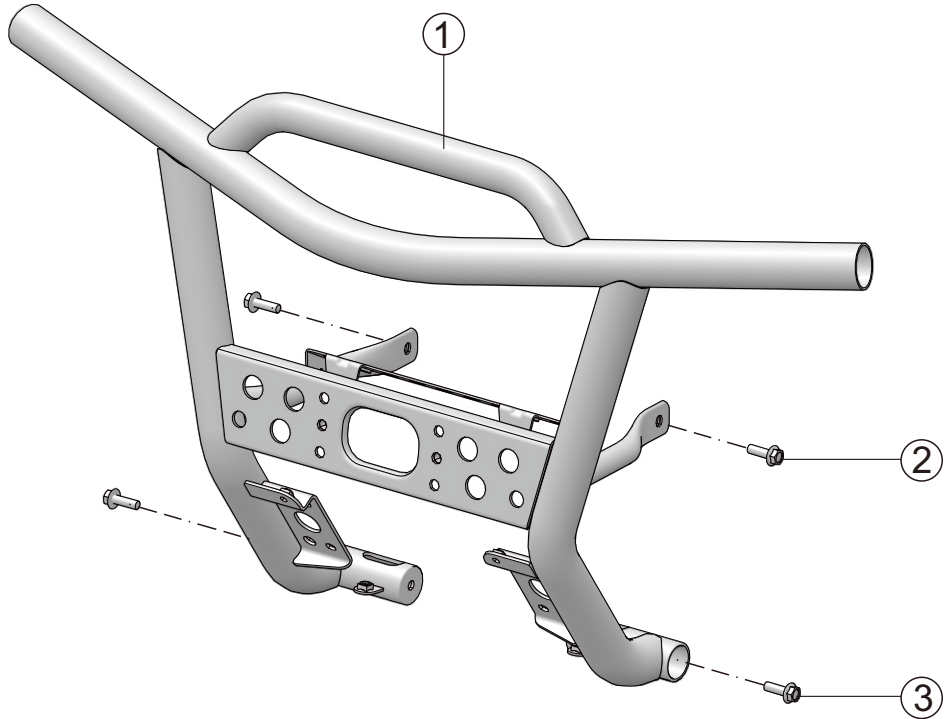

CALLOUT	PART NAME	PART NUMBER	QTY	APPLICABLE MODELS
1	LARGE FRONT BUMPER COMPONENT	A03R20600001	1	All models of SGW570A-F
2	HEXAGON FLANGE BOLT M8×20	GBT005789015	2	
3	HEXAGON FLANGE BOLT M8×25	GBT005789096	2	

# LARGE FRONT BUMPER COMPONENT

## REMOVAL OF BUMPER WITH WINCH

Before installing a new bumper,remove the original bumper from the vehicle,and confirm whether the vehicle is equipped with a winch before removing it.

1. Remove the rubber sleeves on the red and blue cables of the winch motor,loosen the M6 nut and washer on the winch motor cable,and remove the winch motor cable from the winch motor.

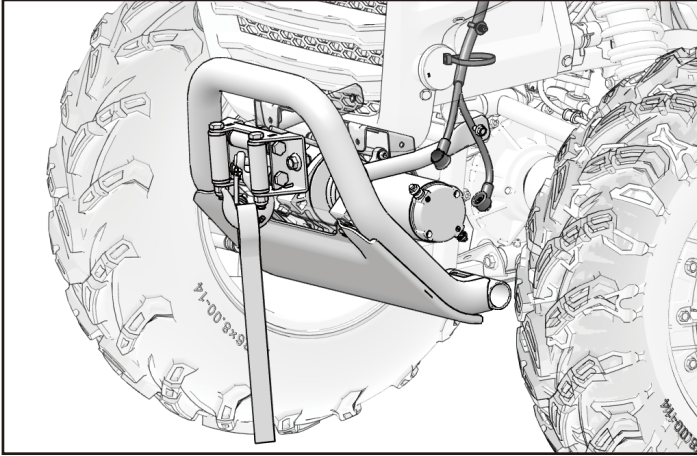

2. Remove the 2 pieces of hexagon flange bolts M8×25 and 2 pieces of hexagon flange bolts M8×20 that fix the bumper.

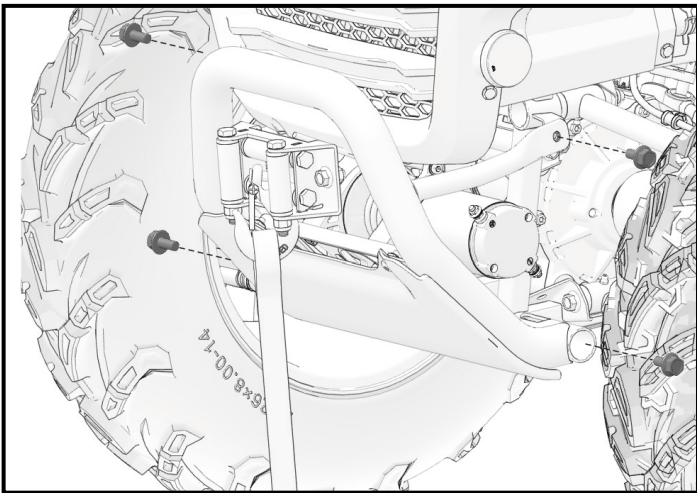

At this time,the bumper and winch motor can be removed as a whole.

### TIPS

The original winch motor and bumper guard on the vehicle need to be installed on the new bumper,please be careful when disassembling.

3. Loosen the 4 pieces of hexagon socket large pan head bolts M6×16 on the bumper guard plate,and remove the bumper guard plate.

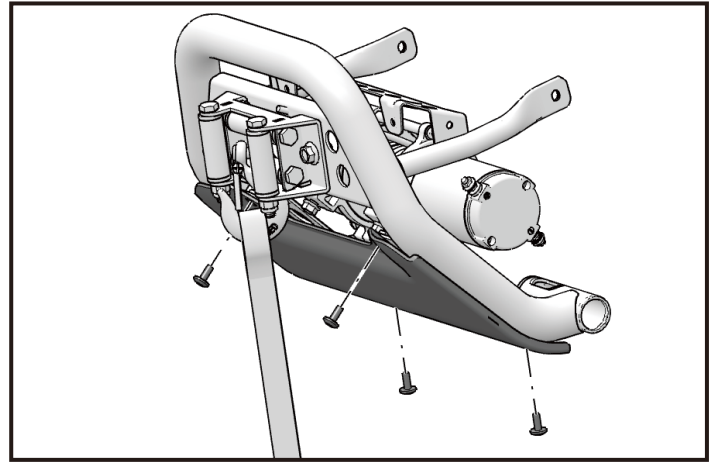

4. Pull out the cotter pin and cotter pin shaft on the winch hook,and remove the winch hook.

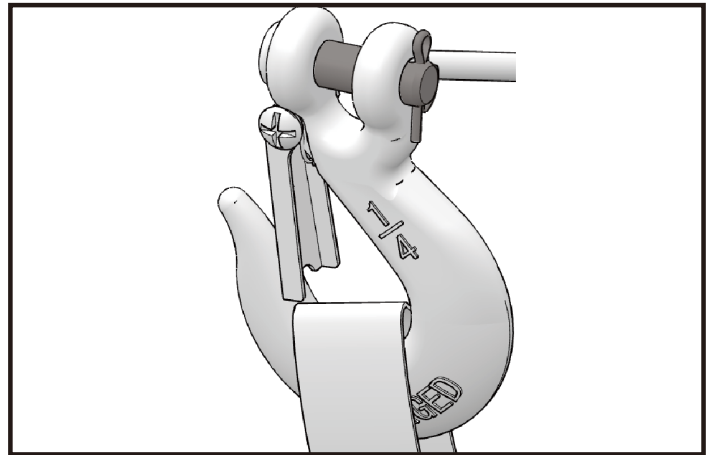

5. Remove the 2 pieces of hexagon flange bolts M10×1.25×20 on the winch guide wheel and 4 pieces of hexagon flange bolts M10×1.25×25 on the winch motor,and remove the bumper.

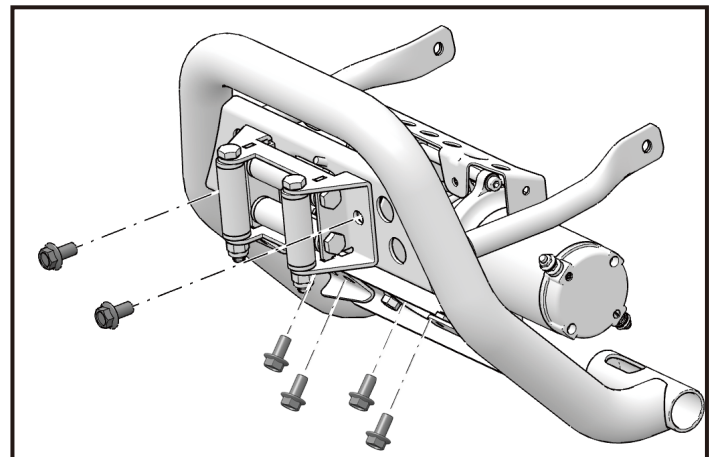

# LARGE FRONT BUMPER COMPONENT

## BUMPER INSTALLATION WITH WINCH

1. Install 2 pieces of hexagon flange bolts M10×1.25×20 for the winch guide wheel and 4 pieces of hexagon flange bolts M10×1.25×25 for the winch motor on the new bumper. Torque value: **40~50N·m(4.0~5.0kgf·m, 29.5~36.9ft·lb)**

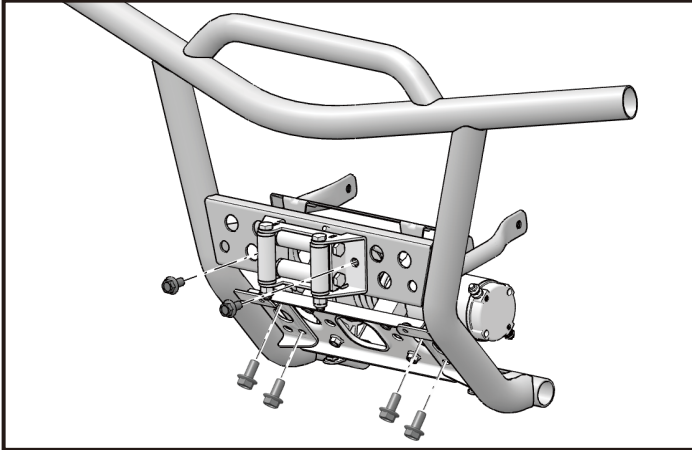

2. Install the bumper guard plate on the new bumper with 4 pieces of hexagon socket large pan head bolts M6×16. Torque value: **8~12N·m(0.8~1.2 kgf·m, 69~103.6 in·lb)**

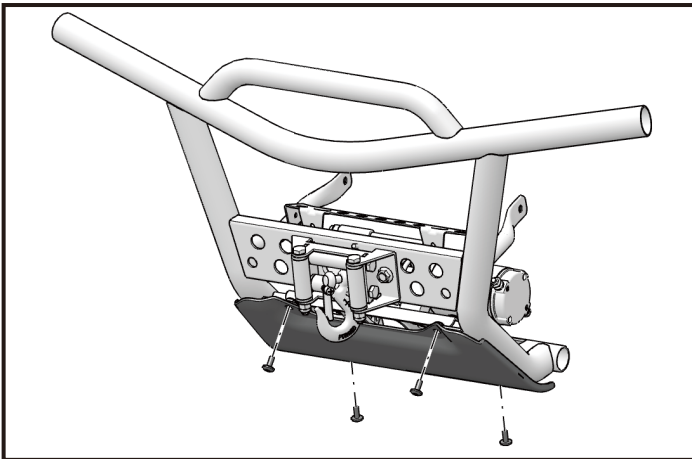

3. Fix the assembled bumper on the frame with 2 pieces of hexagon flange bolts M8×20 and 2 pieces of hexagon flange bolts M8×25. Force value: **30~40N·m(3.0~4.0kgf·m, 22.1~29.5ft·lb)**

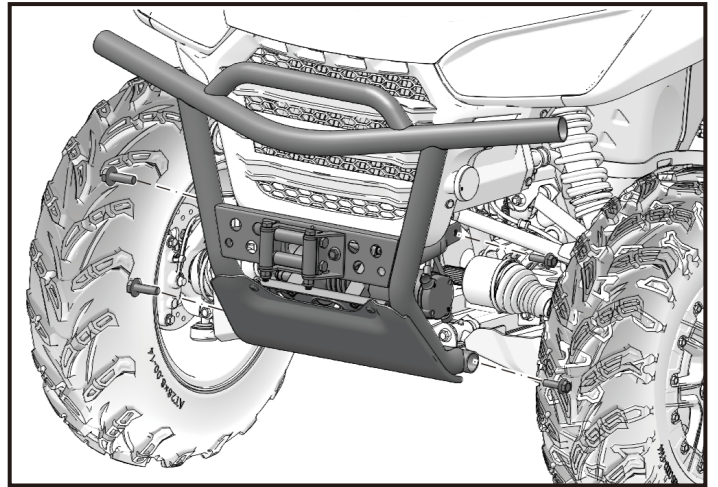

4. Pass the winch rope on the winch motor through the winch guide wheel, and connect the winch hook and the winch rope with a split pin shaft and a split pin.

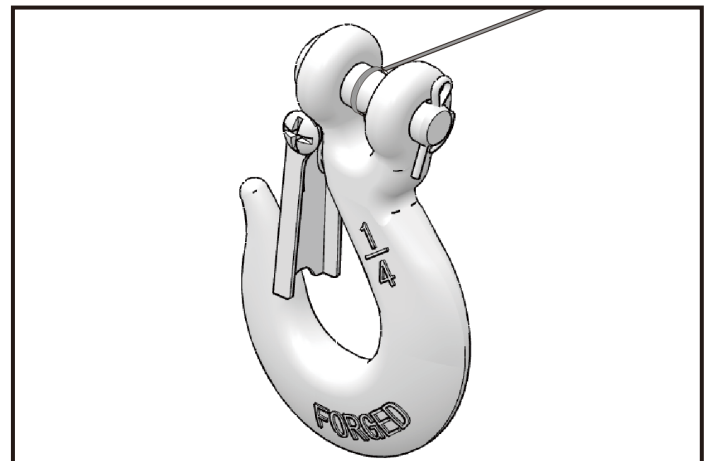

5. Connect the yellow cable on the winch motor with the terminal (+) on the winch motor, and connect the blue cable with the terminal (-) on the winch motor.

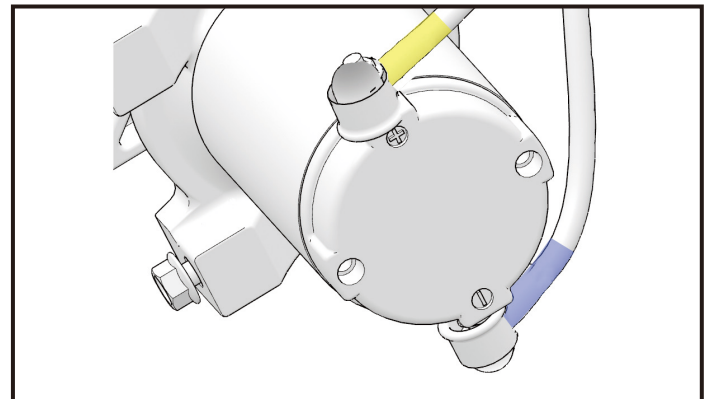

# LARGE FRONT BUMPER COMPONENT

## REMOVAL OF BUMPER WITHOUT WINCH

1. Remove the 4 pieces of hexagon flange bolts M8 on the original bumper and remove the bumper.

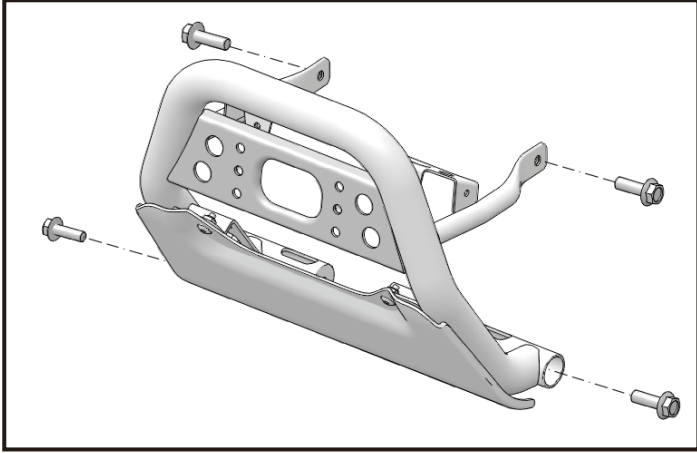

2. Remove the 4 pieces of hexagon socket large pan head bolts M6×16 on the bumper guard plate, and remove the bumper guard plate.

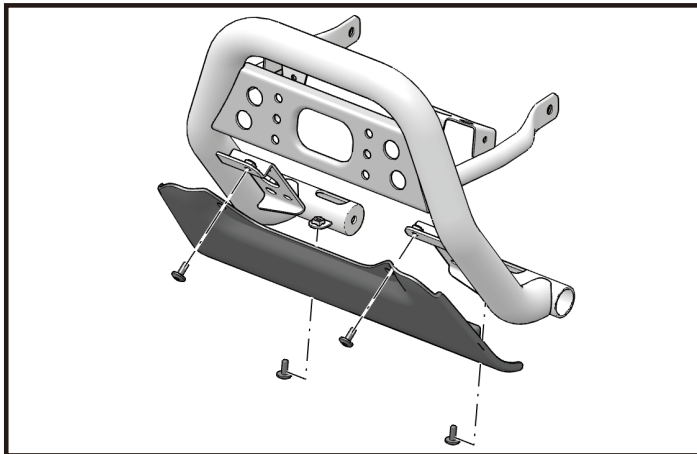

## INSTALLATION OF BUMPER WITHOUT WINCH

1. Install the bumper guard plate on the new bumper with 4 pieces of hexagon socket large pan head bolts M6×16, torque value: **8~12N·m (0.8~1.2 kgf·m, 69~103.6 in·lb)**

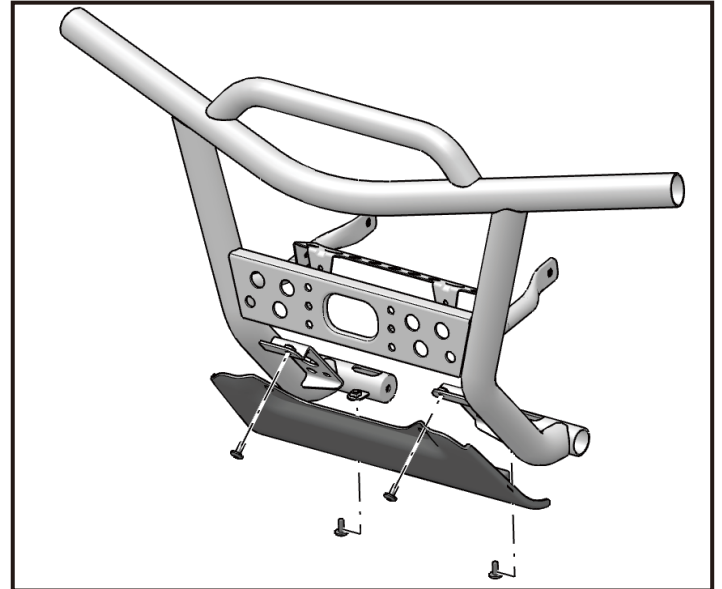

2. Fix the assembled bumper on the frame with 2 pieces of hexagon flange bolts M8×20 and 2 pieces of hexagon flange bolts M8×25. Force value: **30 ~ 40N·m (3.0~4.0kgf·m, 22.1~29.5ft·lb)**

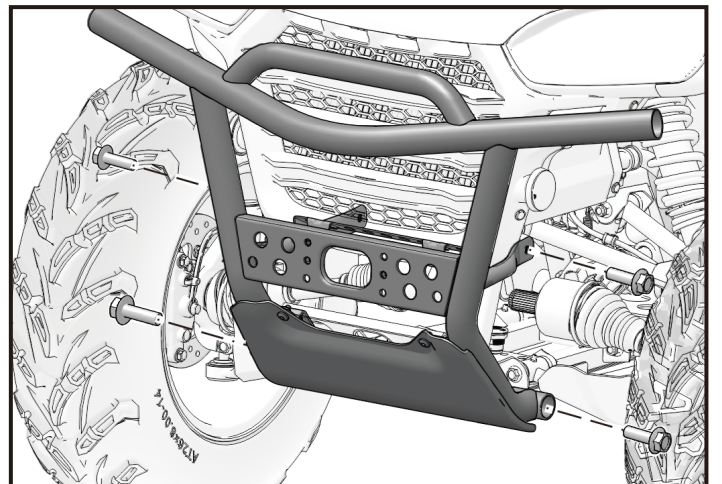

# ALUMINUM FLOOR GUARD ASSY(AT6 L)

## ALUMINUM FLOOR GUARD ASSY(AT6 L)

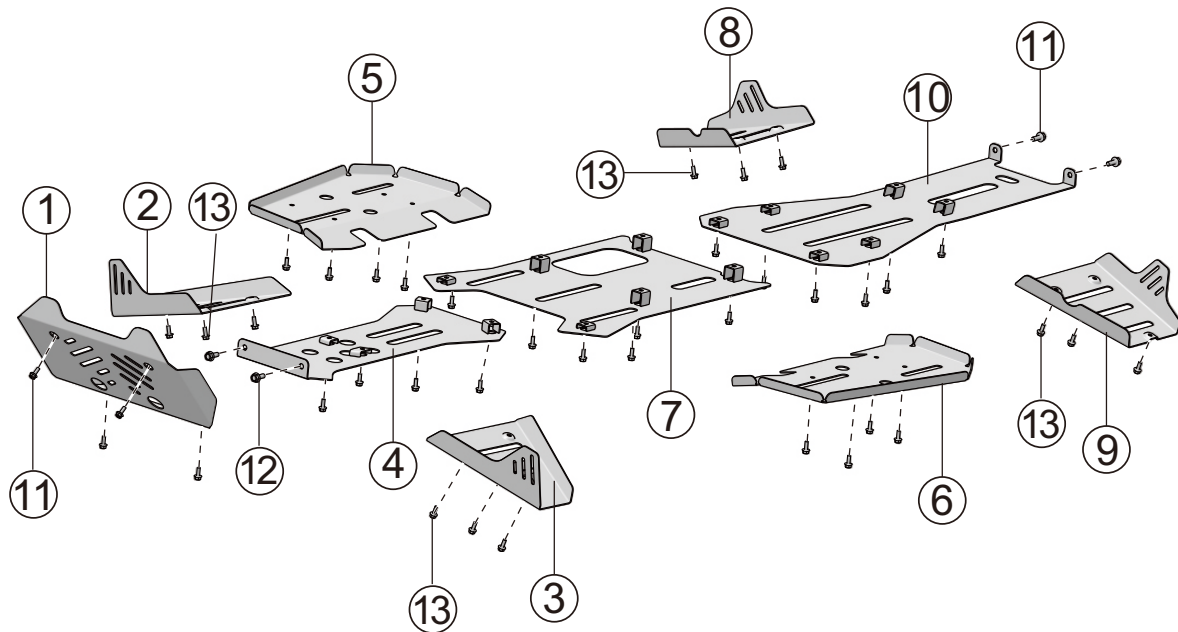

NO.	PART NAME	PART NUMBER	QTY	APPLICABLE MODELS
1	FRONT GUARD ASSEMBLY	A03-R112000-FH1-00	1	<b>AT6 \ AT6 TOURING</b>
2	RIGHT FRONT ROCKER ARM GUARD	A03-R102001-FH1-00	1	<b>AT6 \ AT6 TOURING</b>
3	LEFT FRONT ROCKER ARM GUARD	A03-R101001-FH1-00	1	<b>AT6 \ AT6 TOURING</b>
4	FRONT BOTTOM GUARD	A03-R101000-FH1-00	1	<b>AT6 \ AT6 TOURING</b>
5	RIGHT FOOT SOLE GUARD	A03-R105000-FH1-00	1	<b>AT6 TOURING</b>
6	LEFT FOOT SOLE GUARD	A03-R104000-FH1-00	1	<b>AT6 TOURING</b>
7	MID SOLE PROTECTIVE PLATE	A03-R102000-FH1-00	1	<b>AT6 \ AT6 TOURING</b>
8	REAR RIGHT ROCKER ARM ARMOR	A03-R104001-FH1-00	1	<b>AT6 \ AT6 TOURING</b>
9	REAR LEFT ROCKER ARM ARMOR	A03-R103001-FH1-00	1	<b>AT6 \ AT6 TOURING</b>
10	REAR BOTTOM PROTECTION PANEL	A03-R103000-FH1-00	1	<b>AT6 TOURING</b>
11	HEXAGONAL FLANGE BOLT M8 × 20	GBT005789015	4	
12	HEXAGONAL FLANGE BOLT M6 × 16	GBT005789007	28	
13	HEXAGONAL FLANGE BOLT M6 × 12	GBT005789008	12	

# ALUMINUM FLOOR GUARD ASSY(AT6 L)

## DISMANTLING OF ORIGINAL BOTTOM PROTECTIVE PLATE

Before installing a new vehicle bottom guard, remove the original bottom guard from the vehicle.

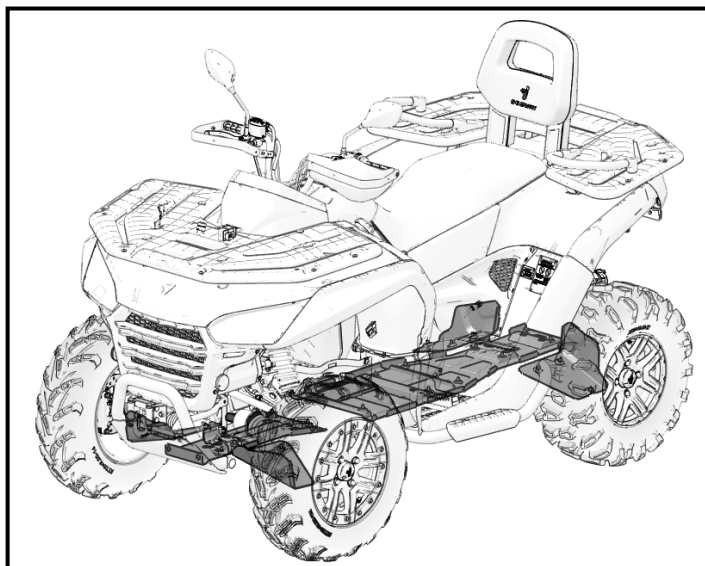

1. Remove the fasteners on the protective plate to be replaced one by one and remove the bottom protective plate.

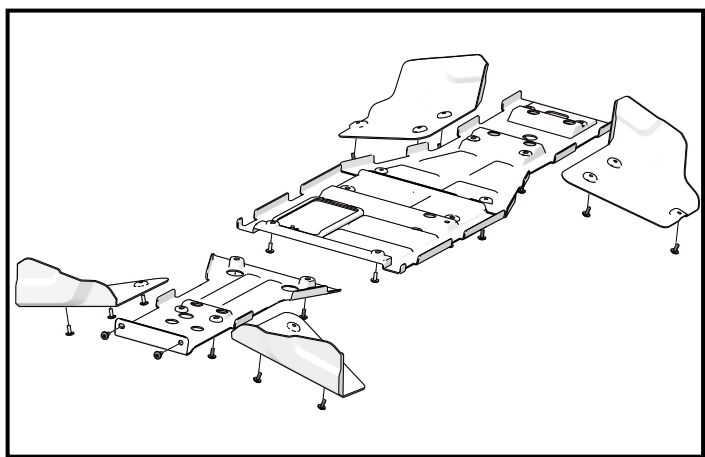

### TIPS

No sequential order

## INSTALLATION OF BOTTOM GUARD PLATE

1. Use 28 hexagonal flange bolts M6 × 16 to fix the front bottom guard, left (right) foot pedal bottom guard, middle bottom guard, and rear bottom guard respectively.
2. Fix the front guard assembly with 4 hexagonal flange bolts M8 × 20.
3. Fix the left (right) front rocker arm guard and left (right) rear rocker arm guard with 12 hexagonal flange bolts M6 × 12.

Bolt M8, torque value: **30 ~ 40N·m (3.0~4.0kgf·m, 22.1~29.5ft·lb)**

Bolt M6, torque value: **8~12N·m (0.8~1.2 kgf·m, 69~103.6 in·lb)**

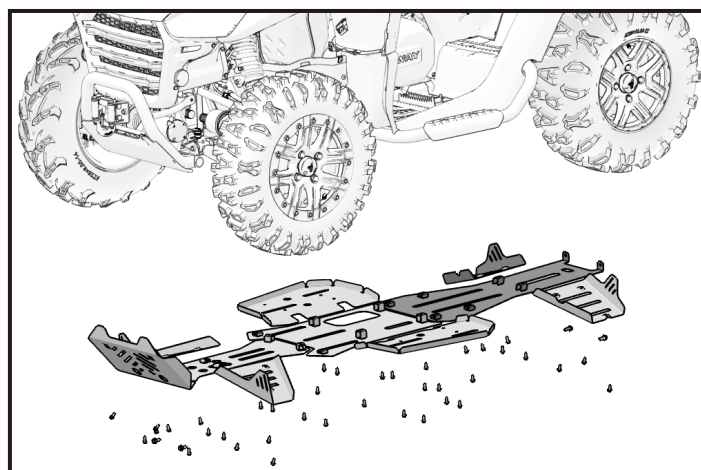

### TIPS

No sequential order

# ALUMINUM FLOOR GUARD ASSY(AT6 S)

## ALUMINUM FLOOR GUARD ASSY(AT6 S)

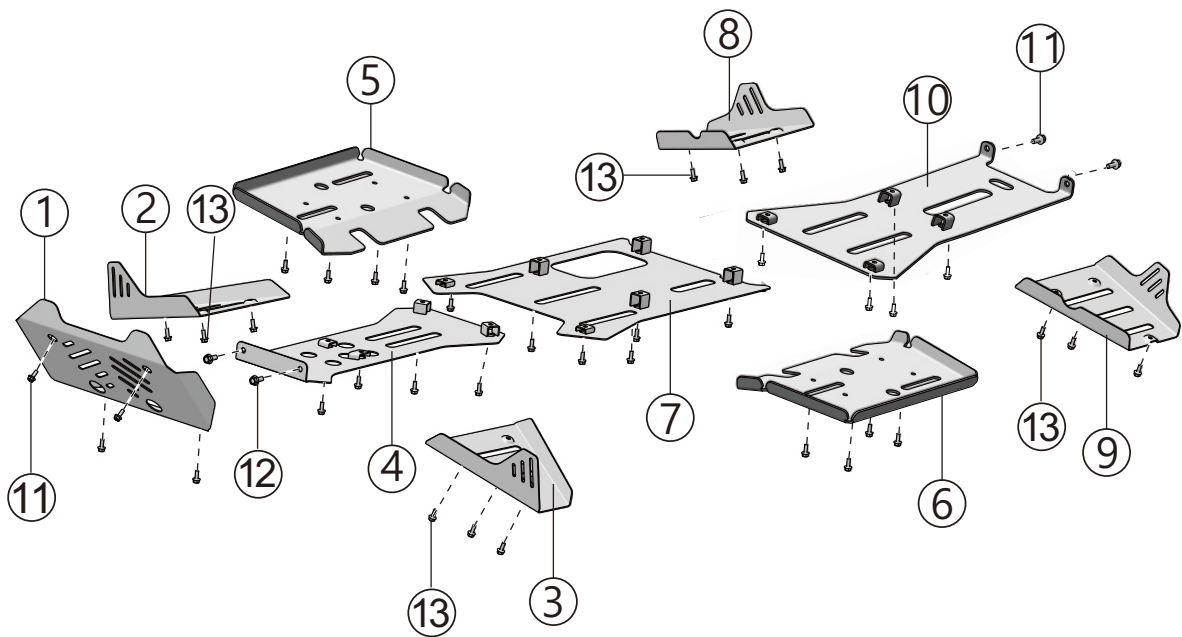

NO.	PART NAME	PART NUMBER	QTY	APPLICABLE MODELS
1	FRONT GUARD ASSEMBLY	A03-R112000-FH1-00	1	<b>AT6 \ AT6 TOURING</b>
2	RIGHT FRONT ROCKER ARM GUARD	A03-R102001-FH1-00	1	<b>AT6 \ AT6 TOURING</b>
3	LEFT FRONT ROCKER ARM GUARD	A03-R101001-FH1-00	1	<b>AT6 \ AT6 TOURING</b>
4	FRONT BOTTOM GUARD	A03-R101000-FH1-00	1	<b>AT6 \ AT6 TOURING</b>
5	RIGHT FOOT SOLE GUARD	A01-R105000-FH1-00	1	<b>AT6</b>
6	LEFT FOOT SOLE GUARD	A01-R104000-FH1-00	1	<b>AT6</b>
7	MID SOLE PROTECTIVE PLATE	A03-R102000-FH1-00	1	<b>AT6 \ AT6 TOURING</b>
8	REAR RIGHT ROCKER ARM ARMOR	A03-R104001-FH1-00	1	<b>AT6 \ AT6 TOURING</b>
9	REAR LEFT ROCKER ARM ARMOR	A03-R103001-FH1-00	1	<b>AT6 \ AT6 TOURING</b>
10	REAR BOTTOM PROTECTION PANEL	A01-R103000-FH1-00	1	<b>AT6</b>
11	HEXAGONAL FLANGE BOLT M8 × 20	GBT005789015	4	
12	HEXAGONAL FLANGE BOLT M6 × 16	GBT005789007	26	
13	HEXAGONAL FLANGE BOLT M6 × 12	GBT005789008	12	

# ALUMINUM FLOOR GUARD ASSY(AT6 S)

## DISMANTLING OF ORIGINAL BOTTOM PROTECTIVE PLATE

Before installing a new vehicle bottom guard, remove the original bottom guard from the vehicle.

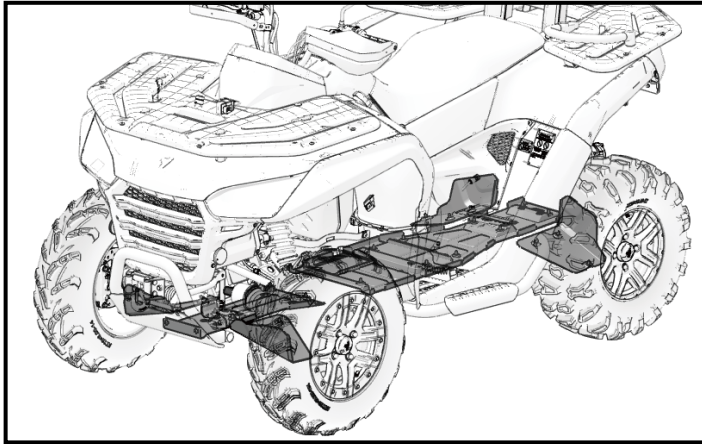

1. Remove the fasteners on the protective plate to be replaced one by one and remove the bottom protective plate.

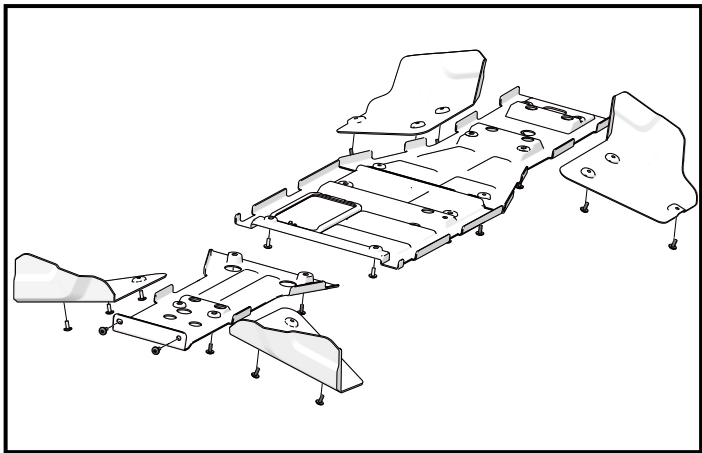

### TIPS

No sequential order

## INSTALLATION OF BOTTOM GUARD PLATE

1. Use 26 hexagonal flange bolts M6 × 16 to fix the front bottom guard, left (right) foot pedal bottom guard, middle bottom guard, and rear bottom guard respectively.
2. Fix the front guard assembly with 4 hexagonal flange bolts M8 × 20.
3. Fix the left (right) front rocker arm guard and left (right) rear rocker arm guard with 12 hexagonal flange bolts M6 × 12.

Bolt M8, torque value: **30 ~ 40N·m (3.0~4.0kgf·m, 22.1~29.5ft·lb)**

Bolt M6, torque value: **8~12N·m (0.8~1.2 kgf·m, 69~103.6 in·lb)**

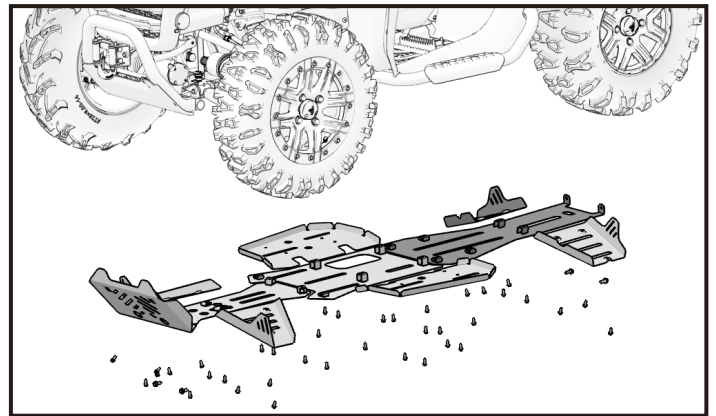

### TIPS

No sequential order

# FRONT AND REAR STORAGE BOXES

## FRONT AND REAR STORAGE BOXES

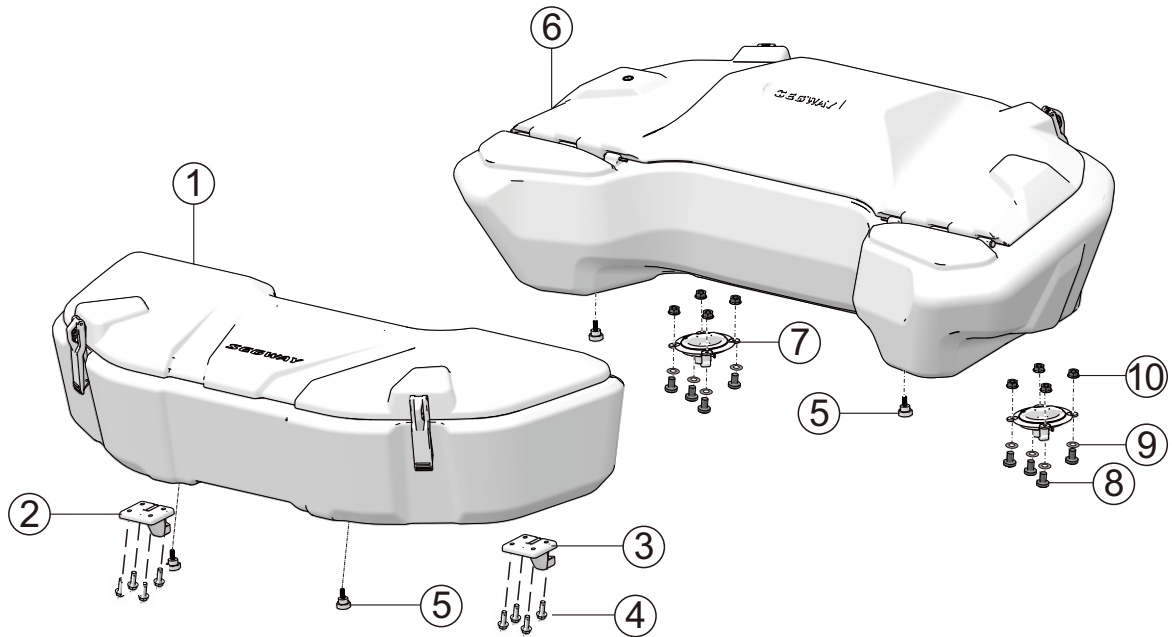

CALLOUT	PART NAME	PART NUMBER	QTY	APPLICABLE MODELS
1	FRONT STORAGE BOX	A02H0005001		All models of 570ATV
2	FR PIN	A02H17500001		
3	FL PIN	A02H17400001		
4	HEXAGON FLANGE BOLT M6×12	GBT005789006		
5	LOCKED NUT	A02H17800001		
6	REAR STORAGE BOX	A02H18000001		All models of 570ATV
7	SELF-LOCKING MECHANISM	A02H18100001		
8	CROSS RECESSED HEXAGON BOLTS M6×16	BT000818012		
9	GASKET M6	GBT000971002		
10	HEXAGON FLANGE BOLT M6	GBT061771002		

# FRONT AND REAR STORAGE BOXES

## TIPS

Storage boxes can only be installed on vehicles equipped with shelf covers

## INSTALLATION OF THE FRONT STORAGE

1. Install the FL pin and the FR pin on the bottom of the front storage box with 4 pieces of M6×12 hexagonal flange bolts. Torque value: **8~12N·m (0.8~1.2 kgf·m, 69~103.6 in·Lb)**.

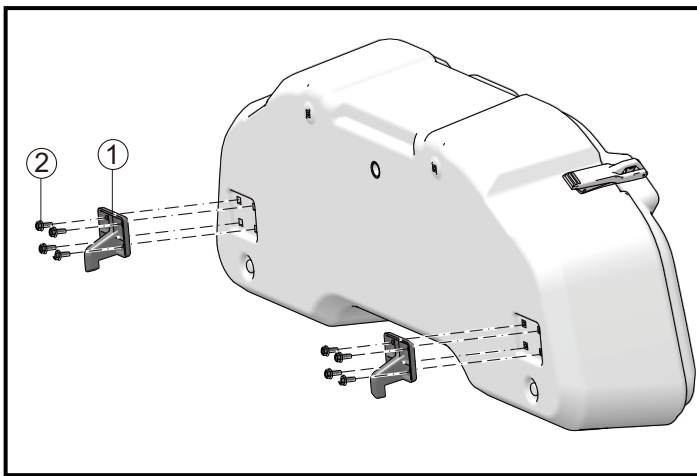

## NOTICE

Please pay attention to the front and back direction of the pins when installing.

The pins are symmetrical parts, please pay attention when installing.

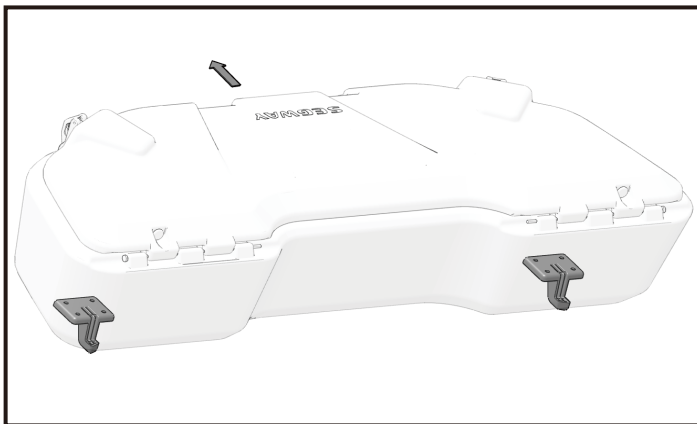

2. Place the front storage box on a suitable position on the front shelf cover, insert the two pins of the storage box into the corresponding fixing slots of the front shelf, and push the storage box until it can no longer be pushed.

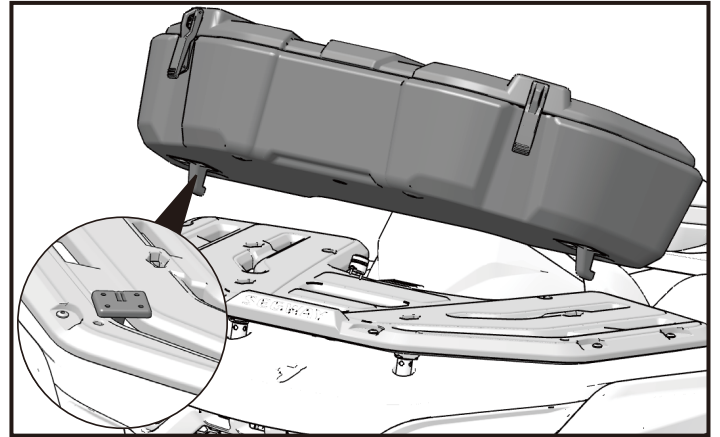

3. Use 2 pieces of lock nuts to lock and fix the front storage box from the bottom of the shelf.

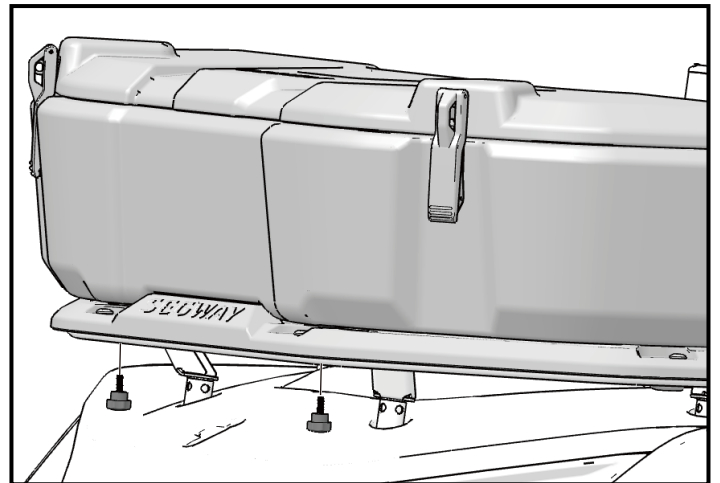

# FRONT AND REAR STORAGE BOXES

## TIPS

Storage boxes can only be installed on vehicles equipped with shelf covers

## INSTALLATION OF REAR STORAGE BOX

1. Loosen the locking bolt at the bottom of the seat back and take off the seat back.

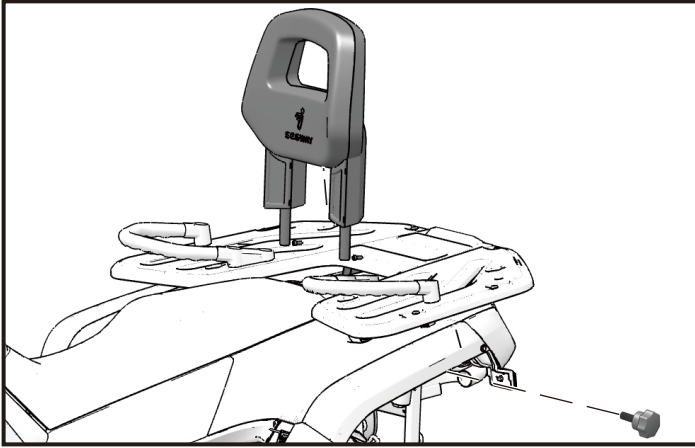

2. Take out the self-locking mechanism, turn the rotary handle on the self-locking mechanism, and turn the side with "△" on the rotary handle to the "🔓" position.

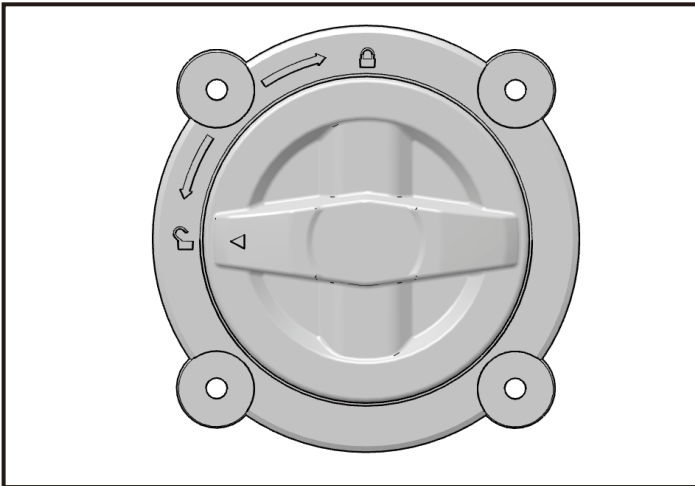

3. Use cross recessed hexagon bolts M5×16, washers and nuts to fix the self-locking mechanism in the rear storage box.

## NOTICE

Pay attention to the installation and fixing direction of the self-locking mechanism

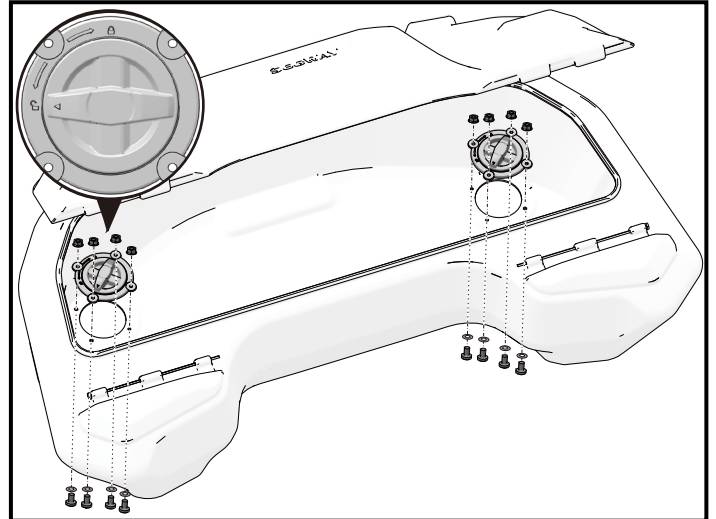

4. Place the storage box with the self-locking mechanism on the rear shelf of the vehicle, and the self-locking mechanism is aligned with the fixed position of the shelf cover.

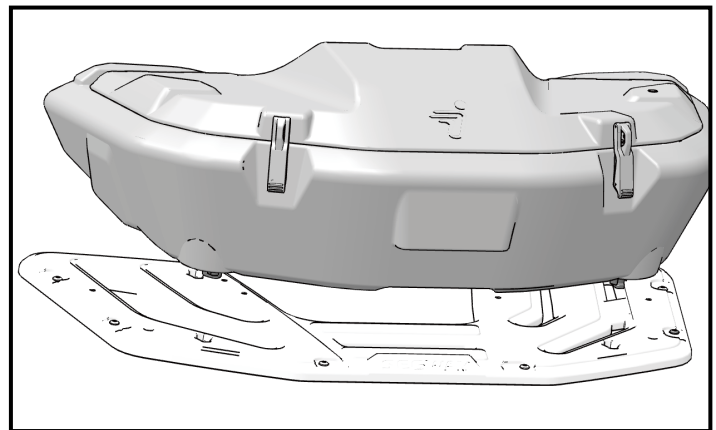

5. Twist the rotary handle on the self-locking mechanism, turn the side with "△" on the rotary handle to the "🔒" position, and fix the rear of the storage box on the shelf.
6. Take out two locking bolts, and lock and fix the rear storage box upwards from the bottom of the shelf cover.

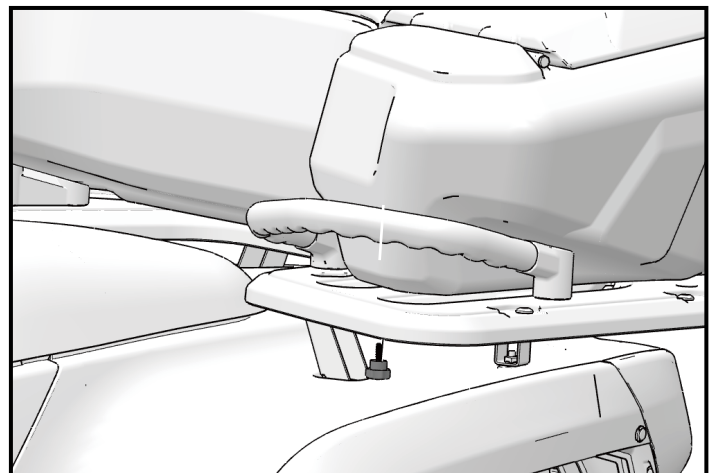

# F L/R WHEEL FENDER

## F L/R WHEEL FENDER

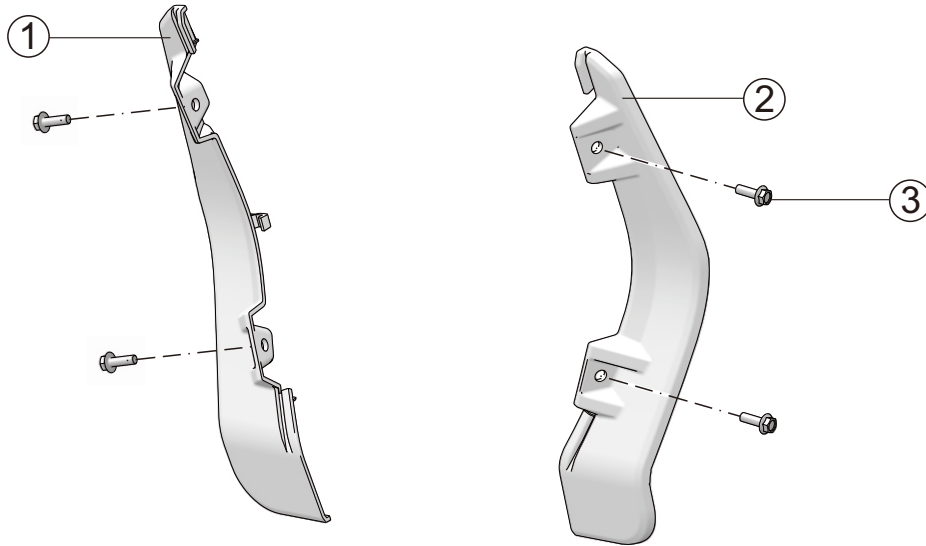

CALLOUT	PART NAME	PART NUMBER	QTY	APPLICABLE MODELS
1	FL WHEEL FENDER	A02H14400001	1	All models of 570ATV
2	FR WHEEL FENDER	A02H14500001	1	All models of 570ATV
3	HEXAGON FLANGE BOLT M6x25	GBT005789010	4	

# F L/R WHEEL FENDER

## INSTALLATION OF F L/R WHEEL FENDER

1. Put the FL wheel fender on the left foot pedal first, and mark the 2 holes on the left foot pedal.

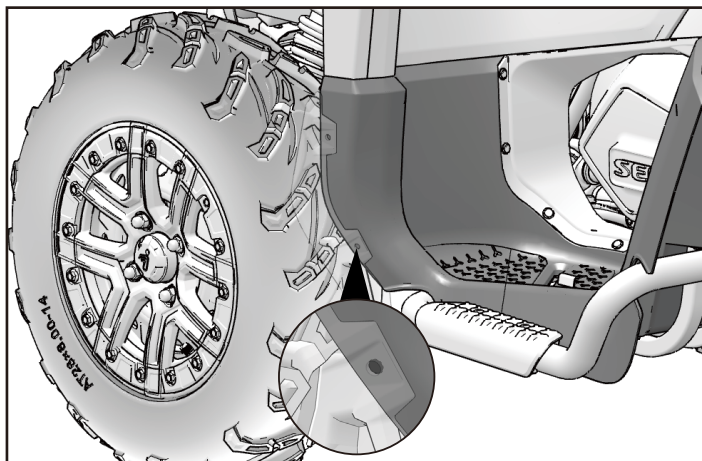

2. Use an electric drilling tool to drill the M7 or M8 mounting hole at the marked position on the left foot pedal.

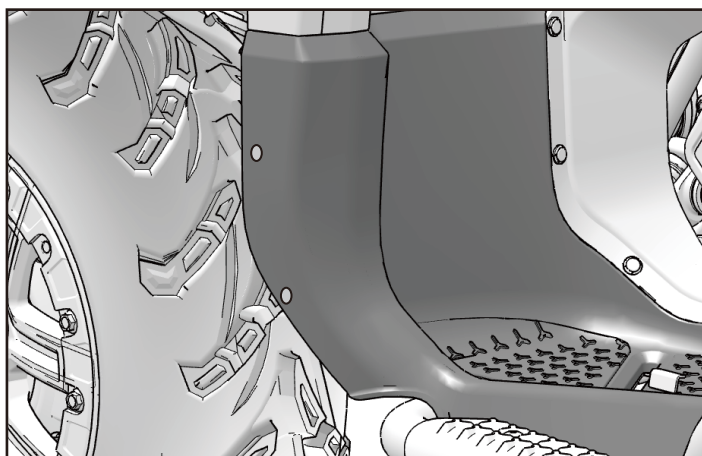

3. Fix the fender with hexagon flange bolts M6×25, torque value: **8~12N·m (0.8~1.2 kgf·m, 69~103.6 in·lb)**

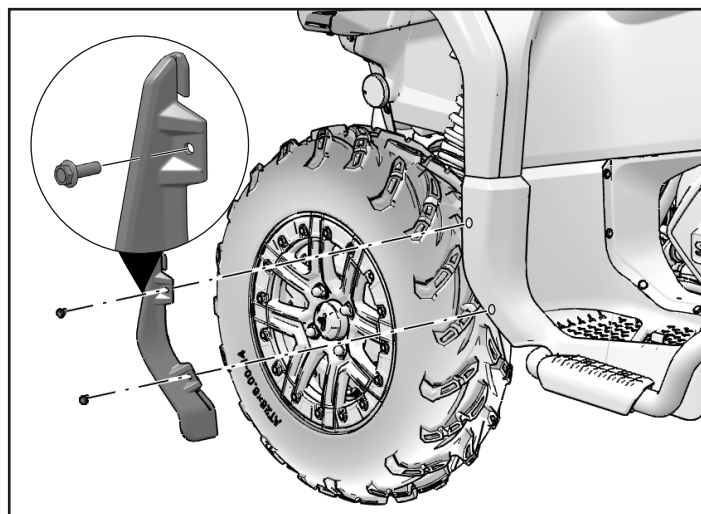

# TURN SIGNAL CONTROL ASSEMBLY

## TURN SIGNAL CONTROL ASSEMBLY

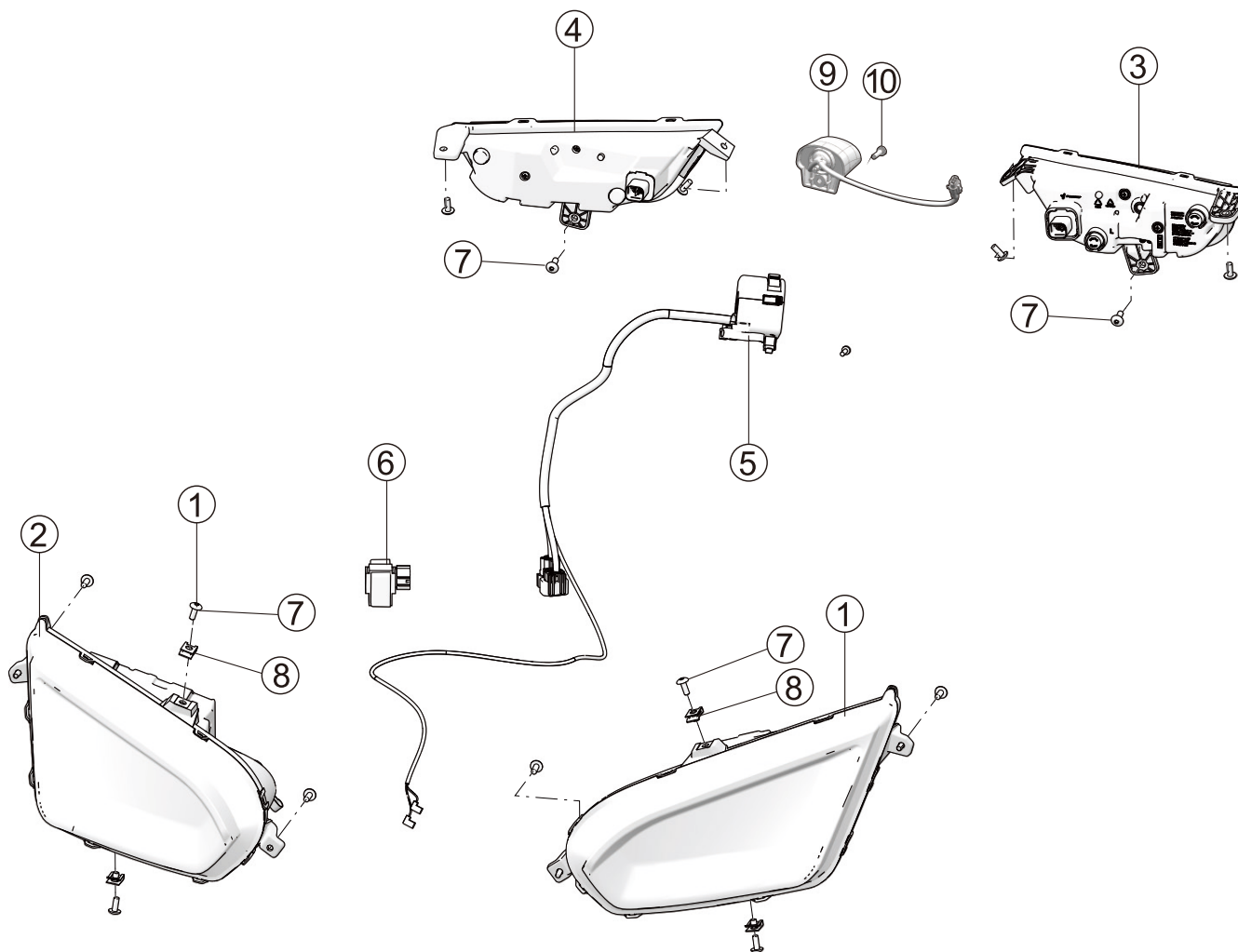

CALLOUT	PART NAME	PART NUMBER	QTY	APPLICABLE MODELS
1	Left combination headlamp(LED)	A01M21000004	1	570ATV EPA
	left combination headlight(halogen)	A01M21100002	1	570ATV EPA
2	Right combination headlight(LED)	A01M22000004	1	570ATV EPA
	Right combination headlight(halogen)	A01M22100002	1	570ATV EPA
3	Left combination taillight(LED)	A01M23000004	1	570ATV EPA
	Left combination taillight(halogen)	A01M23100002	1	570ATV EPA
4	Right combination taillight(LED)	A01M24000004	1	570ATV EPA
	Right combination taillight(halogen)	A01M24100002	1	570ATV EPA
5	Left hand handle switch	A04M52100001	1	570ATV EPA
6	Scintillator	S01M04100001	1	570ATV EPA
7	Large flat head socket Allen screw M6×16	T03000001001	14	
8	M6 nut clamp	T04000002001	4	
9	License plate light(LED)	A01M25000001	1	570ATV EPA
	License plate lamp (halogen )	A01M25000002	1	570ATV EPA
10	Phillips head screw M5×16	GBT000818005	1	

# TURN SIGNAL CONTROL ASSEMBLY

Remove the original front of the vehicle (left/right) before installing the turn signal control unit

Headlights, left handlebar switch and rear (left / right) taillights for new steering Lamp control components.

## HEADLIGHTS / LEFT HAND HANDLE SWITCH / REAR TAILLIGHTS REMOVED

### TIPS

The method of removing the left (right) headlights and the left (right) rear taillights is the same

1. Remove the front racking assembly by removing the 4-piece fixing bolts on the front racking assembly.

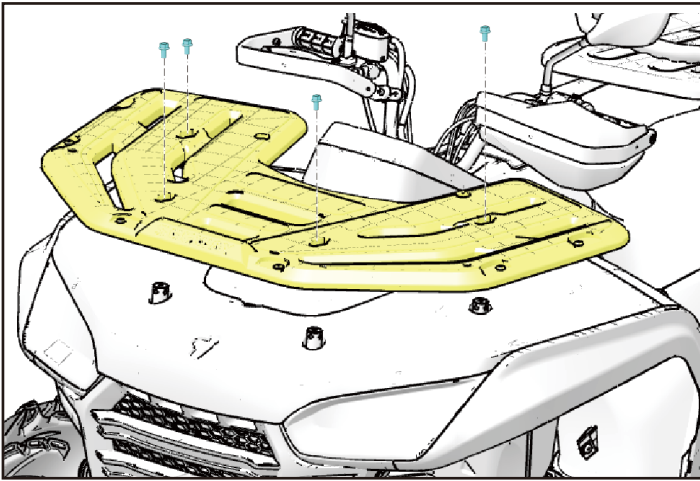

2. Remove the front access cover, which is snap-on for quick removal.

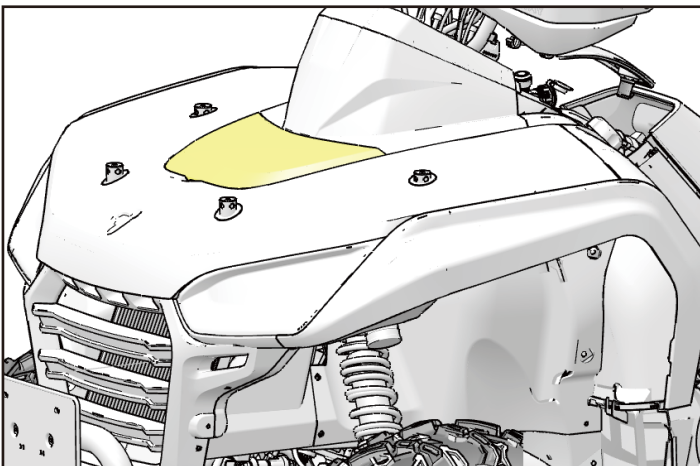

3. Remove the front access cover, which is snap-on for quick removal.

### TIPS

During the removal process, pay attention to protect the surface of the decorative panel to avoid scratches.

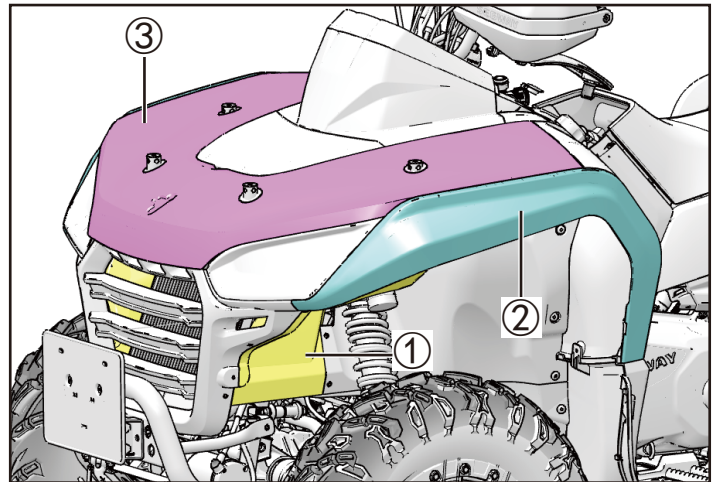

4. Remove the headlamp by unplugging the harness connector attached to the front left headlamp 4-piece fastening bolts and 2-piece M6 nut clamps with headlight mask, right side removed. The way to divide is the same.

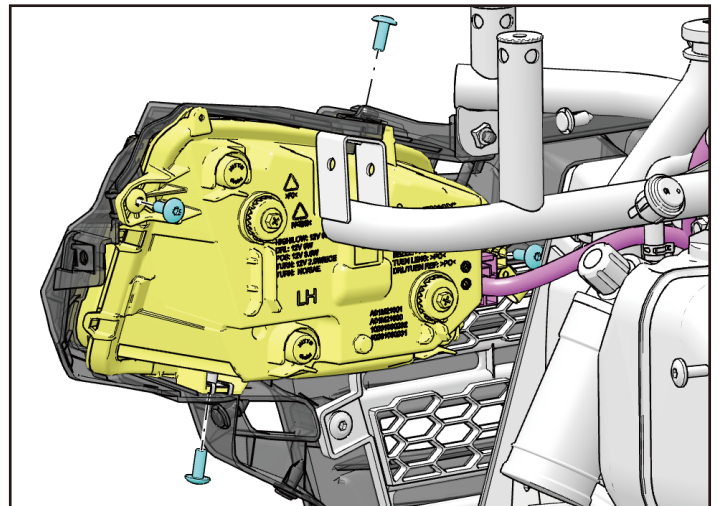

# TURN SIGNAL CONTROL ASSEMBLY

5. Fix the cable ties and rubber straps that secure the left handlebar switch harness. Remove and unplug the switch harness and the connecting plug from the vehicle.

## TIPS

Remember the left hand handle switch harness routing orientation and cable tie fixing position so that subsequent installation of new switches

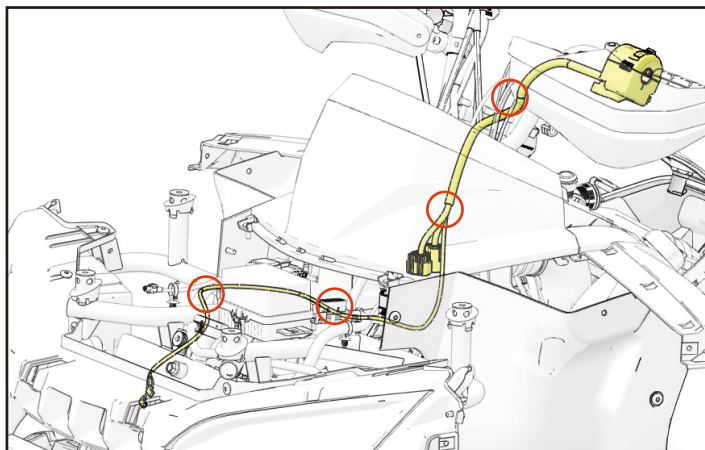

6. Remove the 2 cross-groove pan head screws from the left handlebar switch and remove the left handlebar switch, which needs to be replaced with a new one.

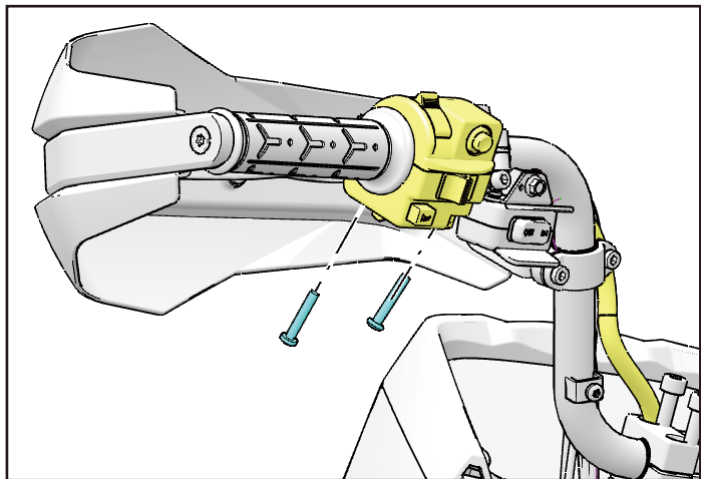

7. Remove the 4-piece expansion buckle assembly on the left rear tail lampshade and remove the rear tail lampshade.

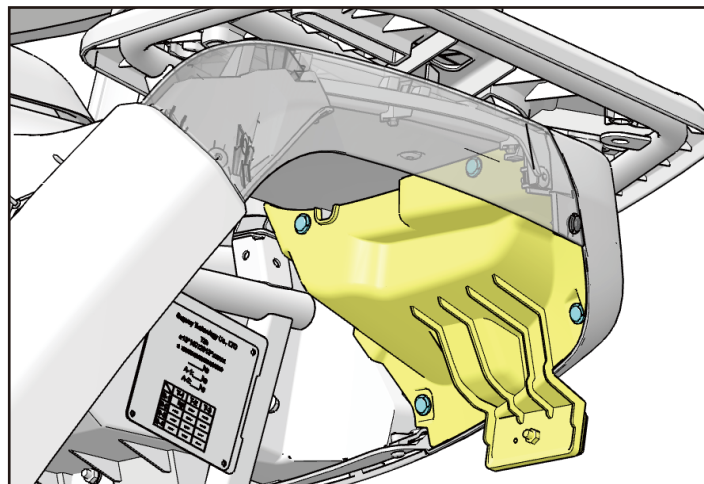

8. Remove the rear taillights by pulling out the harness connector plug on the rear taillights, removing the 3 rear taillight fastening bolts.

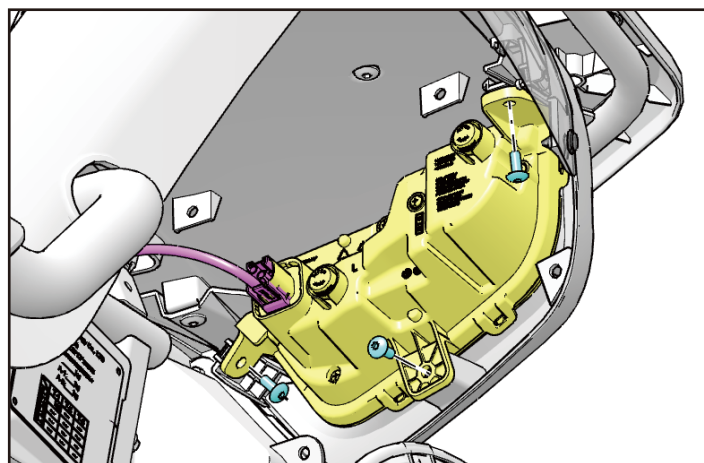

# TURN SIGNAL CONTROL ASSEMBLY

## REPLACE THE HEADLIGHTS / LEFT HANDLEBAR SWITCH / REAR TAILLIGHTS

1. Install new headlights, left-hand switches, and rear taillights in turn, in the opposite way to removal.

### TIPS

When installing, pay attention to the wiring harness routing orientation and cable tie fixing position, which is the same as when dismantling.

2. Install the front panel and the front (left/right) side strips in their homing positions.

## INSTALL A SCINTILLATOR / REAR LICENSE PLATE LIGHT

1. The scintillator is located under the front access cover, find the flasher plug reserved on the vehicle, and connect the scintillator to the reserved plug on the vehicle. Insert the scintillator into the corresponding mounting lugs on the vehicle.

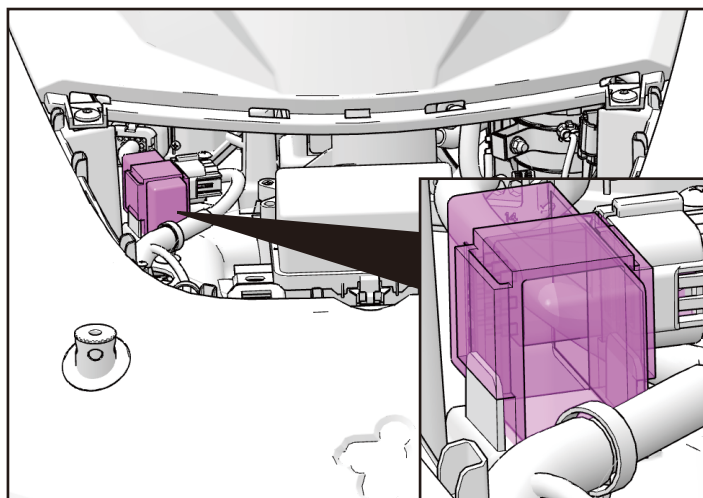

2. The rear license plate light mounting device is located at the rear of the vehicle, pass the rear license plate light harness through the round hole, fix the license plate light in the corresponding mounting hole with the cross-groove pan head screw M5×16, and pair the plug with the plug connector on the vehicle.

### TIPS

When installing, pay attention to the wiring harness routing orientation and the fixing position of the cable tie.

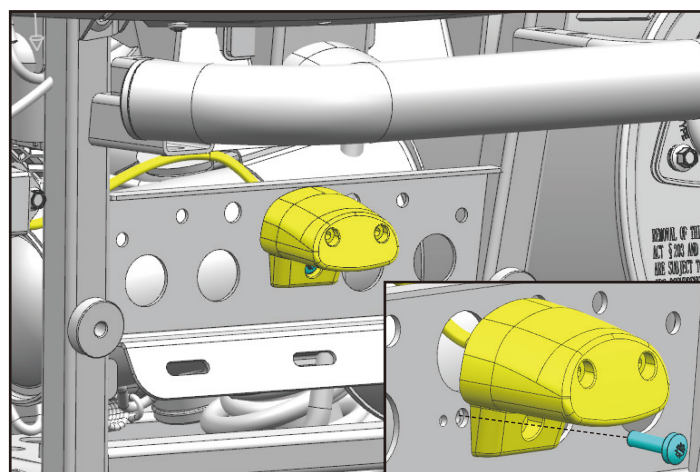

3. After all replacement and additional parts are installed, turn on the vehicle, energize the vehicle, test the installed turn signal control components, and if you need to adjust the headlight high beam, please refer to the High Beam Adjustment section of the User Manual.
4. After passing the test, the front access cover, the front racking assembly, the front (left/ Right) The headlampshade and rear lampshade are all installed and returned to their positions.

# SNOW SHOVEL ASSEMBLY

## SNOW SHOVEL ASSEMBLY

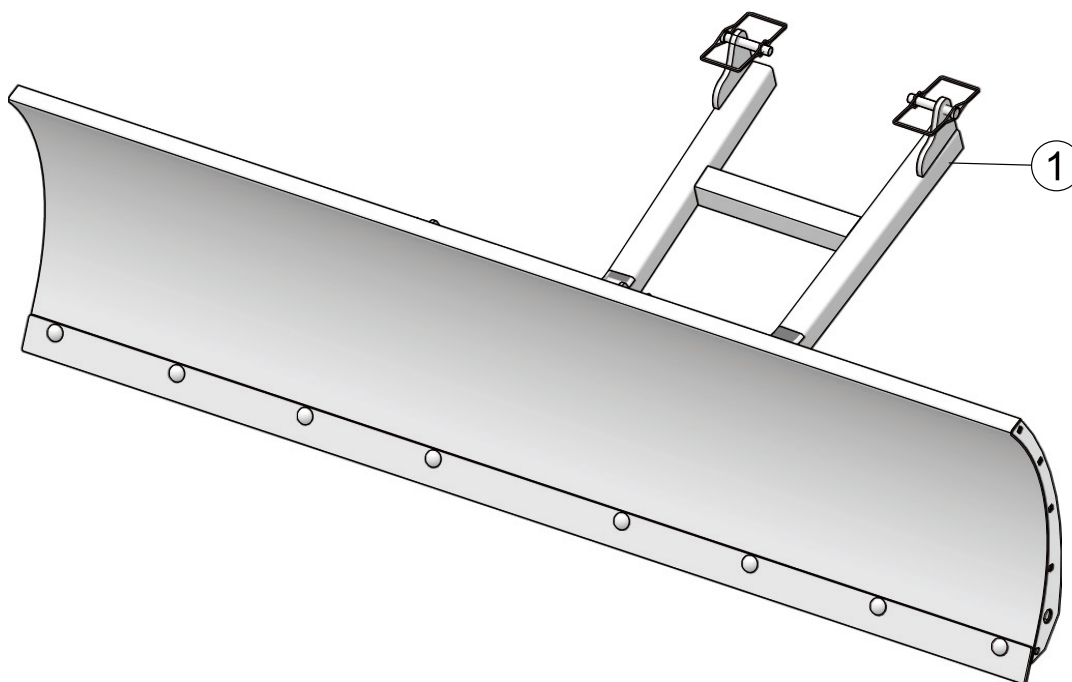
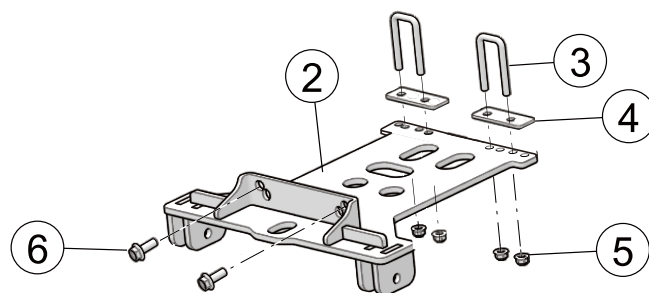

CALLOUT	PART NAME	PART NUMBER	QTY	APPLICABLE MODELS
1	Snow shovels weld components	A02-R002100-000-00	1	ATV
2	Snow shovels weld components	U01R9100001	1	ATV
3	U-bolt	A02-R000200-000-00	2	ATV
4	Heel	A02-R000100-000-00	2	ATV
4	Type 2 non-metallic insert hex flange face lock nut M8	GBT061831003	4	
5	Hex flange face bolt M10×1.25×25	GBT005789026	2	

# SNOW SHOVEL ASSEMBLY

## TIPS

The use of skid components must be used with a winch.

## SNOW SHOVEL WELDED COMPONENT ASSEMBLY

Snow shovel welded components are loose parts and need to be assembled first, please refer to Assembly Instructions Guide instructions.

The snow shovel welded components are assembled before installation.

## SNOW SHOVEL ASSEMBLY INSTALLATION

1. Remove the 4 fastening bolts on the front safety plate.

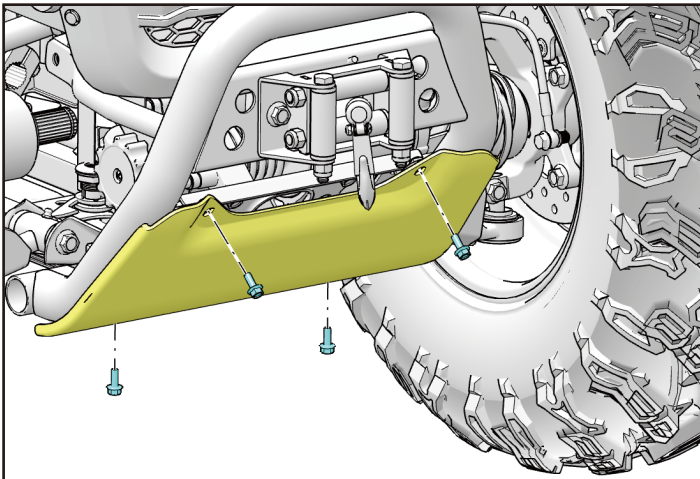

2. Remove the 2-piece fastening bolts under the front bumper.

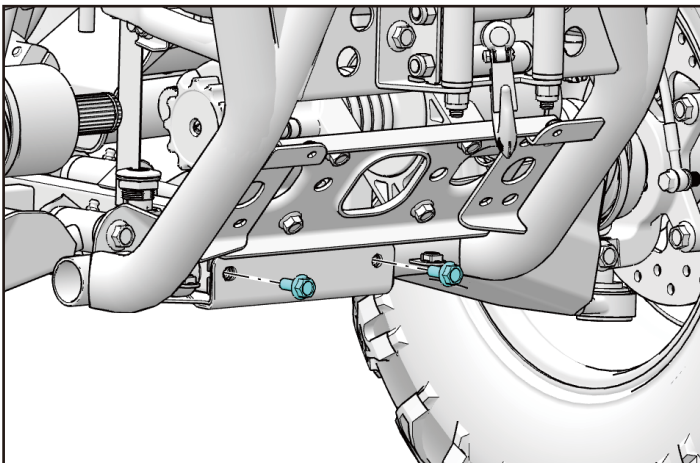

3. Place the snow shovel front adapter assembly under the front of the vehicle, with the mounting holes in the front aligned with the mounting holes under the front bumper. Use 2 pieces of hexagonal flange face screw M10×1.25×25 to secure the snow shovel front adapter assembly to the front bumper, do not tighten the bolts first.

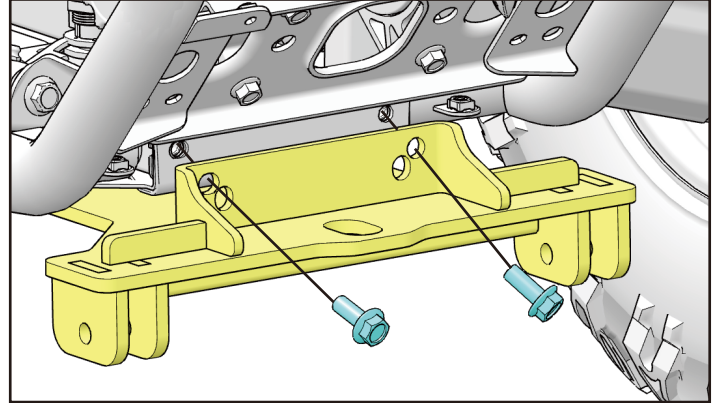

4. Adjust the snow shovel front adapter assembly so that it fits the lower swingarm support tube, use U-bolts through the corresponding mounting holes in the lower swingarm support tube and the snow shovel front adapter assembly, secure with 4 M8 nuts, and tighten all fasteners.

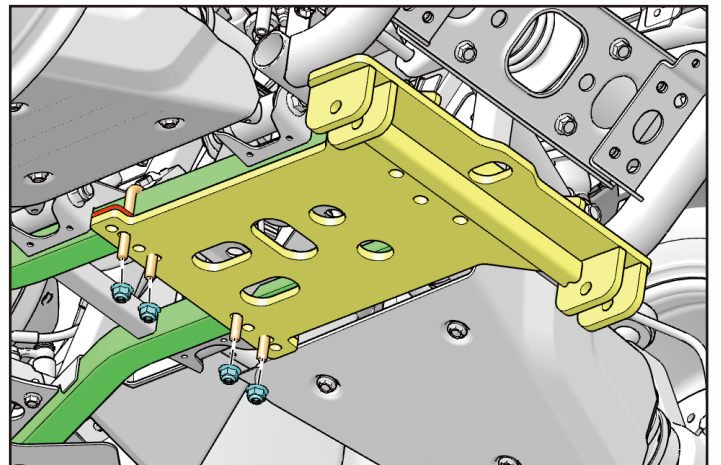

5. Snap the wire snap on the sled, pass the bolt through the fixing hole in the front adapter assembly of the shovel, and finally reattach the wire snap to the bolt.

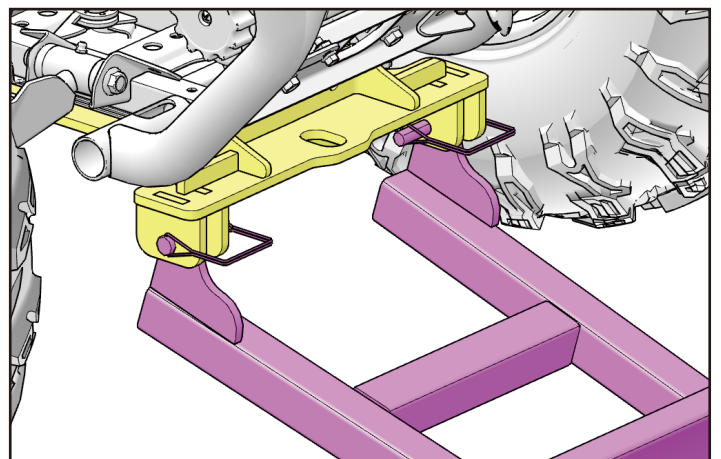

# FULL COVERAGE BUMPER

## FULL COVERAGE BUMPER

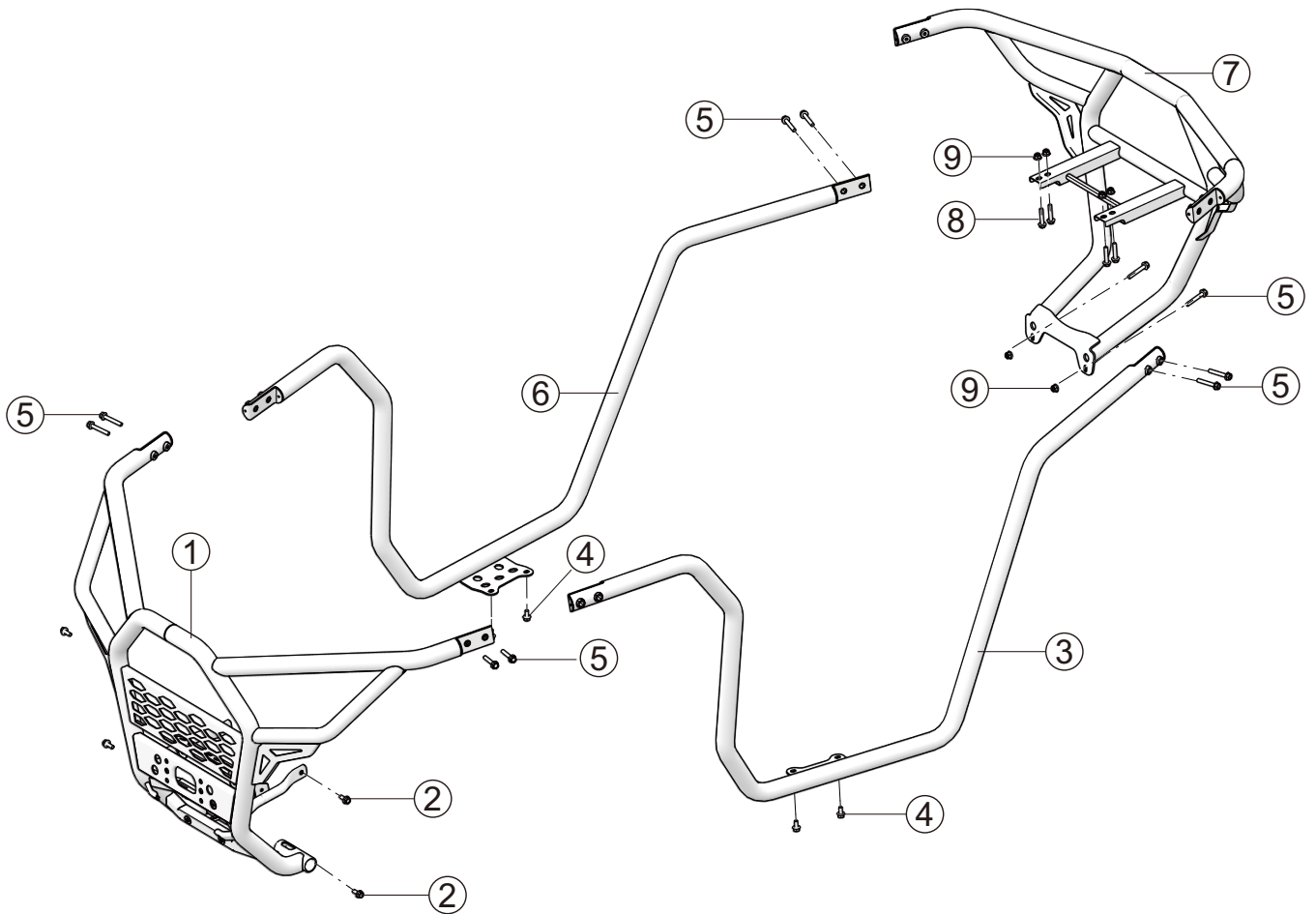

ITEM	PART NAME	PART NUMBER	QTY	REMARKS
1	FRONT BUMPER	A03-R115000-000-00	1	
2	HEX BOLT M8×20	GBT005789015	4	
3	LEFT ROD	A03-R110000-000-00	1	
4	HEX BOLT M8×16	GBT005789014	4	
5	HEX BOLT M8×50	GBT005789021	10	
6	RIGHT ROD	A03-R111000-000-00	1	
7	REAR BUMPER	A03-R116000-000-00	1	
8	HEX BOLT M8×40	GBT005789019	4	
9	LOCKING NUT M8	GBT061831003	6	

# FULL COVERAGE BUMPER

## REMOVAL OF FRONT/REAR BUMPER

1、 Remove all fixing bolts from the original bumper and remove the bumper.

2、 Remove the 4 hexagon socket bolts M6 × 16 from the bumper guard, remove the bumper guard, and if the vehicle is equipped with a winch, remove the winch together.

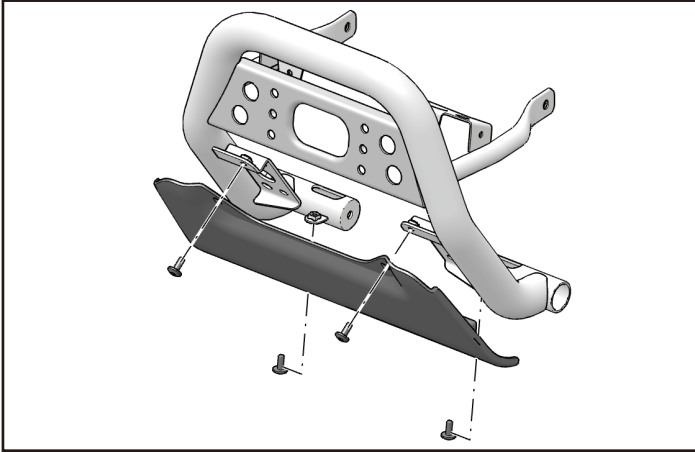

3、 Remove the original rear bumper from the vehicle.

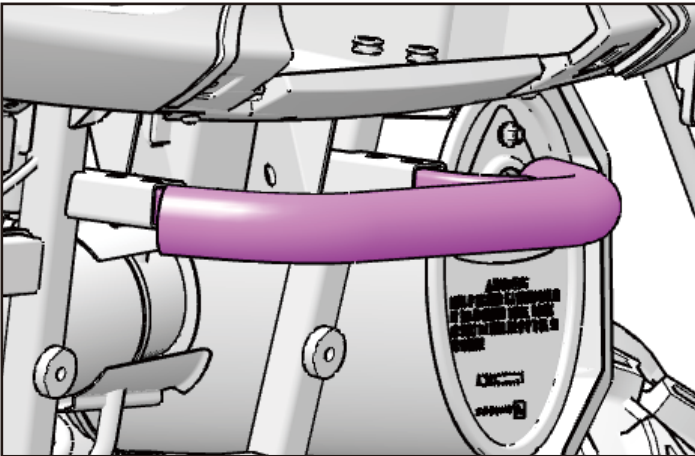

## INSTALLATION OF NEW BUMPER

1、 Reinstall the protective plate and winch (if any) removed from the original bumper onto the new fully wrapped front bumper welding assembly.

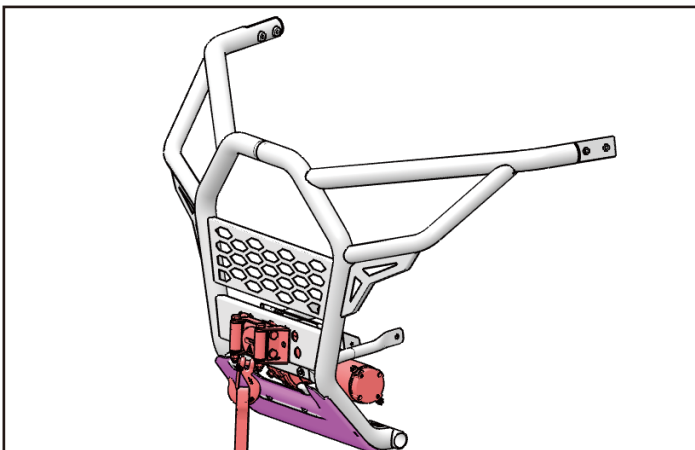

2、 Fix the front bumper to the frame with 4 pcs M8 × 20 hexagonal flange bolts, torque value: 30-40 N · m (3.0~4.0 kgf · m, 22.1~29.5 ft · lb)

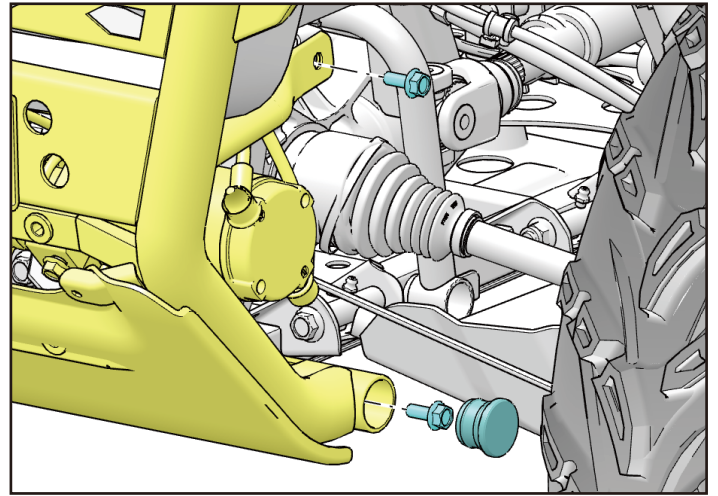

3、 Fix the rear bumper to the frame with 2 pcs M8 × 50 hex flange bolts and 4 pcs M8 × 40 hex flange bolts, respectively, with a torque value of 30-40 N · m (3.0~4.0 kgf · m, 22.1~29.5 ft · lb)

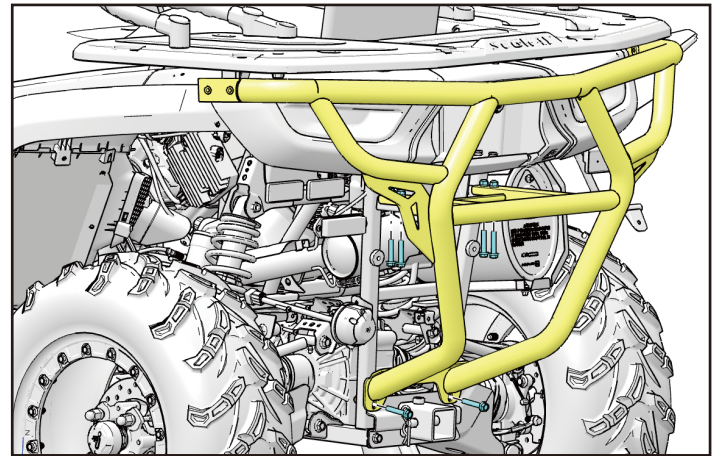

4、 Use 2 pieces of M8 × 16 hexagonal flange bolts to fix the left fence assembly to the frame, and use 4 pieces of M8 × 50 hexagonal flange bolts to fix the fence assembly and front and rear bumpers. Torque value: 30-40 N · m (3.0~4.0 kgf · m, 22.1~29.5 ft · lb)

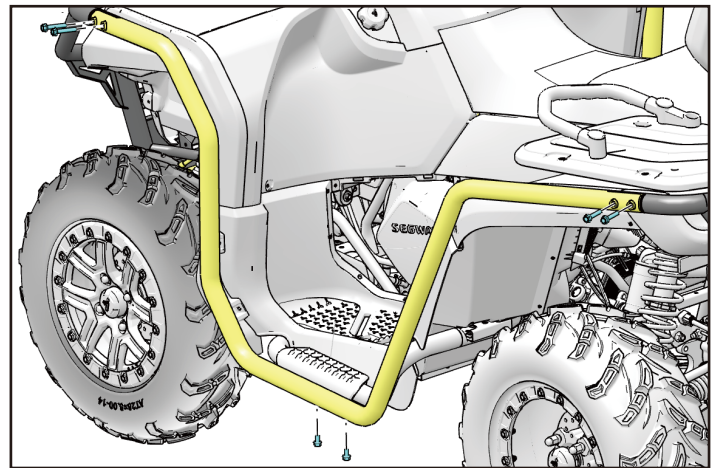

# CARGO BARRIER RAIL

## CARGO BARRIER RAIL

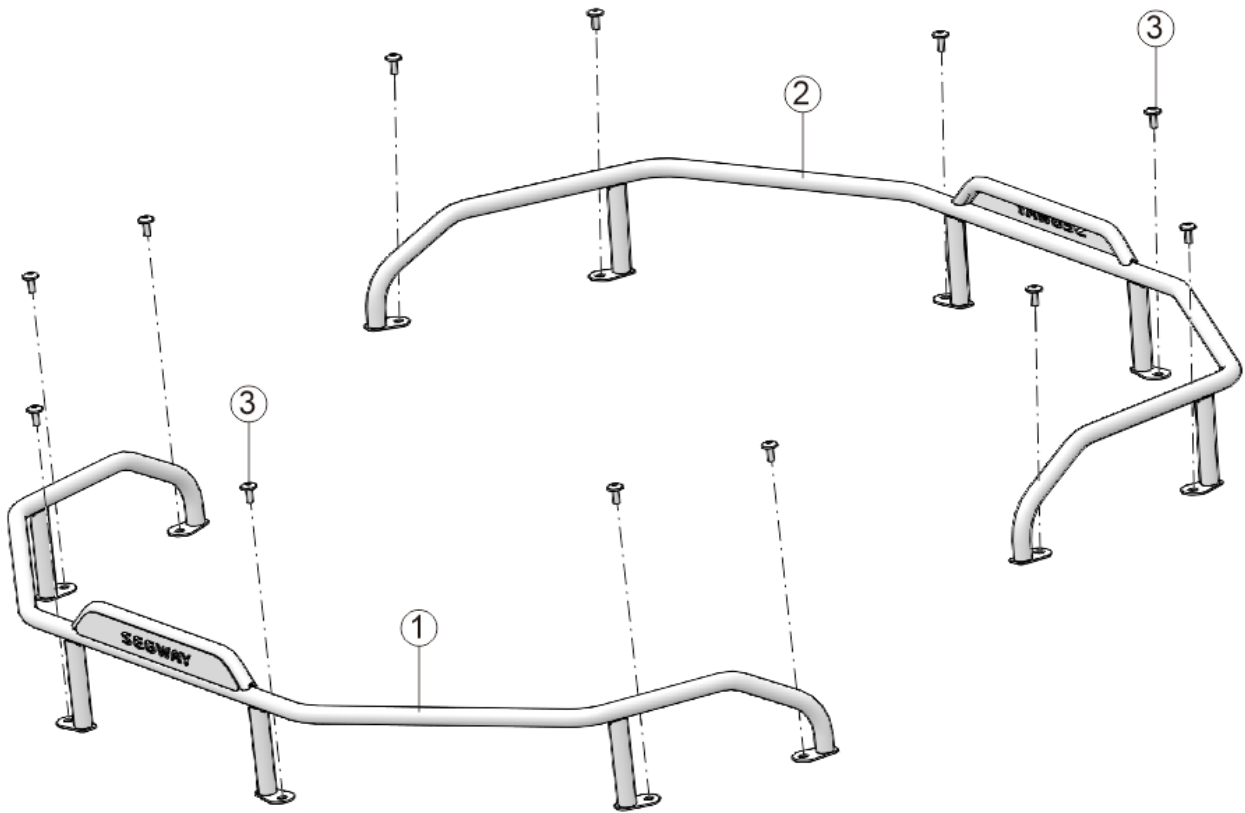

ITEM	PART NAME	PART NUMBER	QTY	REMARKS
1	FRONT RAIL	A02-R101000-000-00	1	
2	REAR RAIL	A02-R103000-000-00	1	
3	HEX BOLT M6×16	T03000007002	12	

# CARGO BARRIER RAIL

## FRONT RAIL INSTALLATION

1、 Fix the front rail on the front shelf with 6 pcs large pan head hexagonal bolts M6 × 16, torque value: 8~12N · m (0.8~1.2 kgf · m, 69~103.6 in · lb)

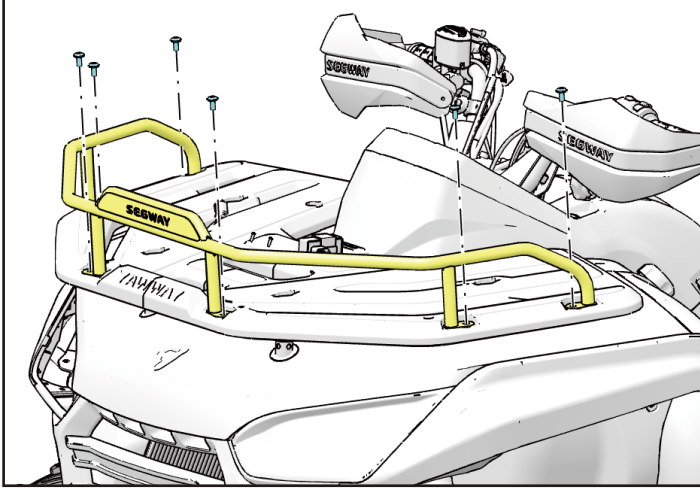

## REAR RAIL INSTALLATION

1、 Fix the rear rail onto the rear shelf with 6 large pan head hexagonal bolts M6 × 16, torque value: 8~12N · m (0.8~1.2 kgf · m, 69~103.6 in · lb)

